



TuHue/TuHue2 — 0-10v

Single Circuit (SC) — Direct & Indirect

CCT controlled with ONE dimmer

Intensity controlled with ONE dimmer

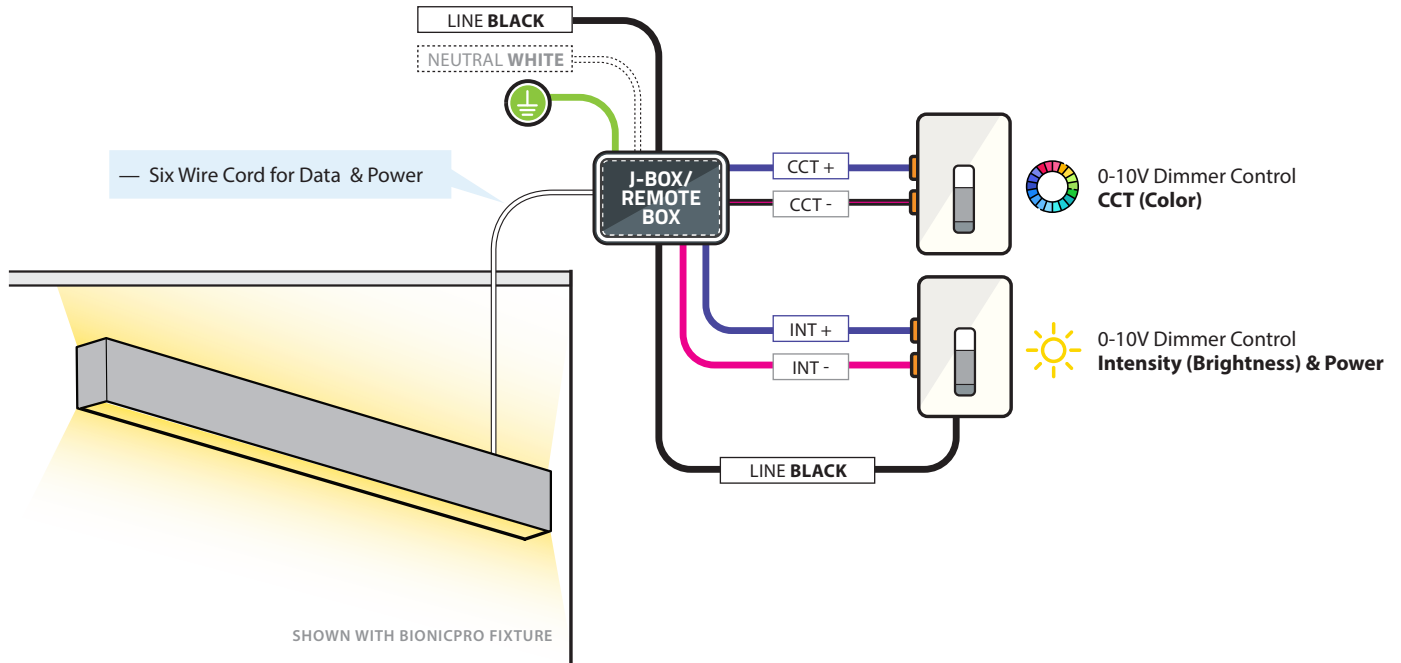

- Cord (Power and Data) between fixture and junction box are supplied by Prudential, but ship separately. Wire colors shown below are representative of the wires inside the fixture.
- Junction box wiring by others. Wire colors shown are for illustration purposes only.

J-BOX WIRING DETAIL:

LIGHTING FIXTURE INTERNAL DETAILS:

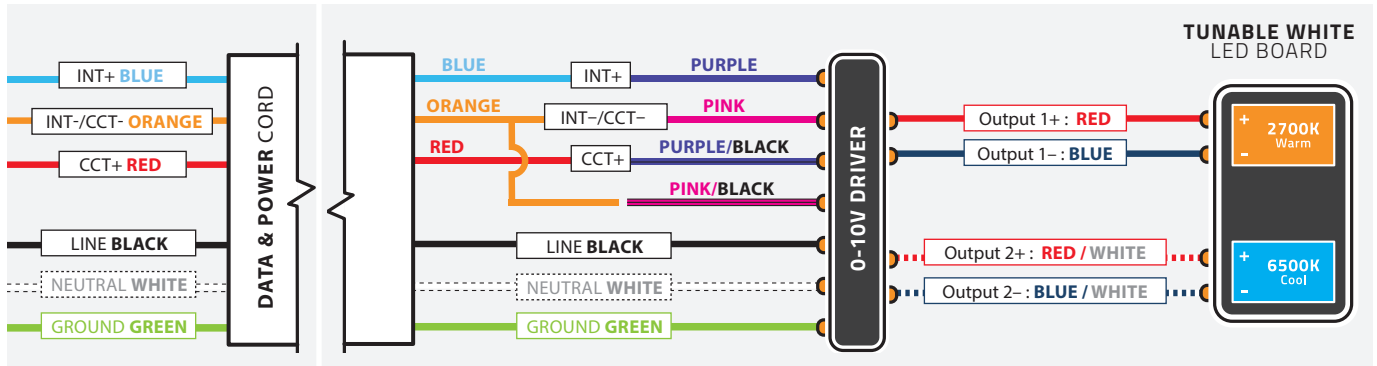

WARNING: Ground fixture in accordance with local and national electrical codes. Failure to do so may result in serious personal injury. Fixture Installations should ONLY be done by a qualified licensed electrical professional.

TuHue/TuHue2 — 0-10v

Dual Circuit (DC) — Direct & Indirect
CCT controlled with TWO dimmers (one direct, one indirect)
Intensity controlled with TWO dimmers (one direct, one indirect)

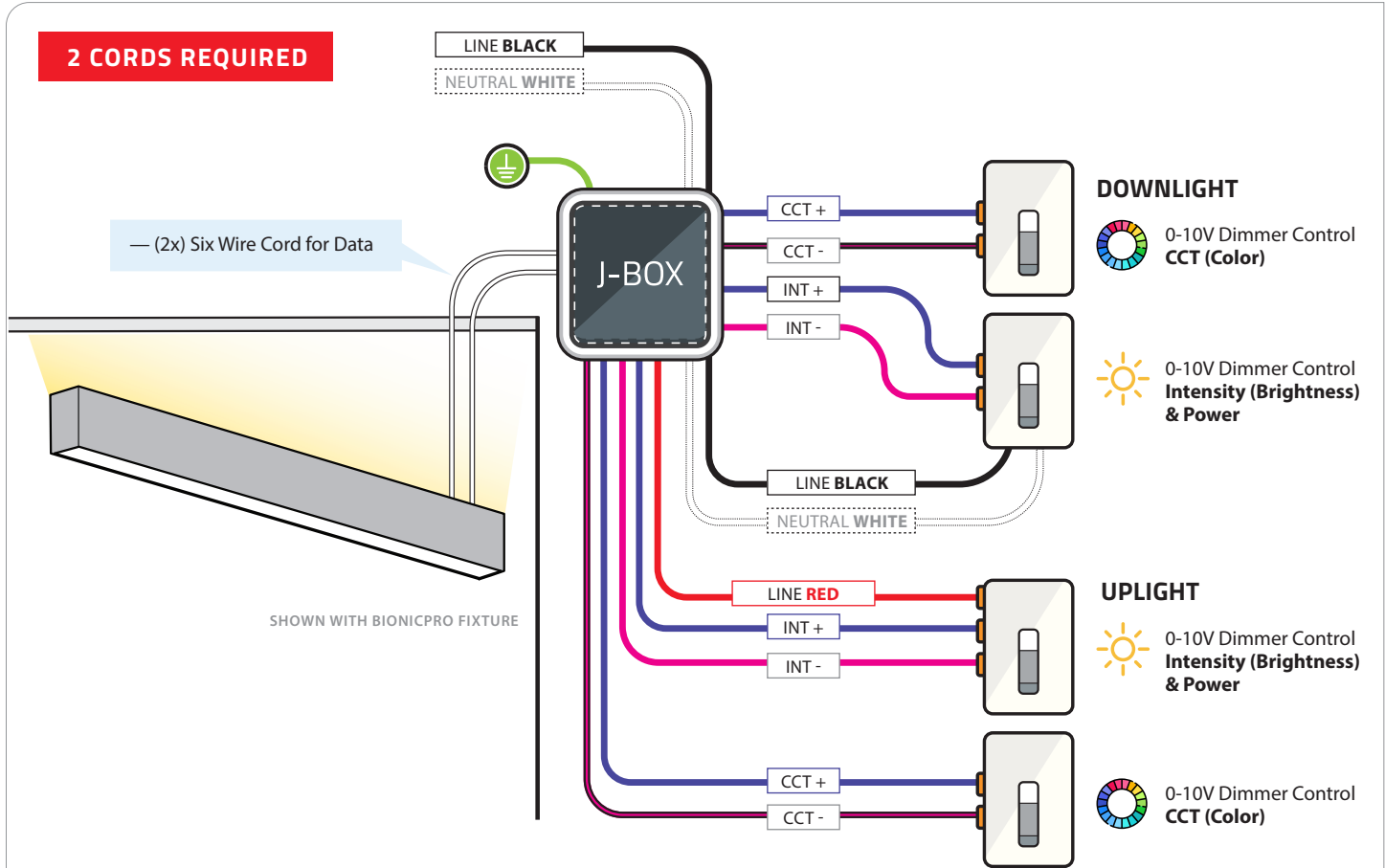

- Cords (Power and Data) between fixture and junction box are supplied by Prudential, but ship separately. Wire colors shown below are representative of the wires inside the fixture.
- Junction box wiring by others. Wire colors shown are for illustration purposes only.

J-BOX WIRING DETAIL:

LIGHTING FIXTURE INTERNAL DETAILS:

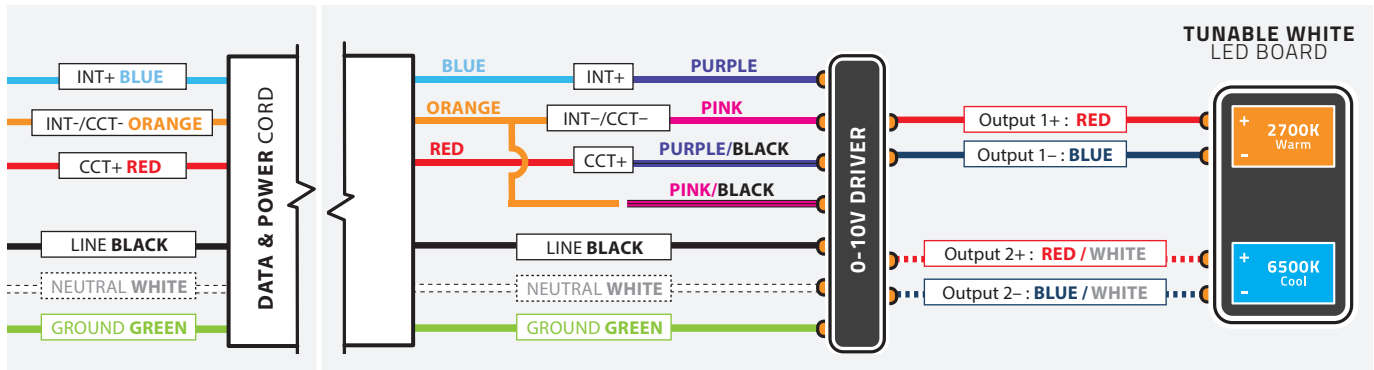

WARNING: Ground fixture in accordance with local and national electrical codes. Failure to do so may result in serious personal injury. Fixture Installations should ONLY be done by a qualified licensed electrical professional.

TuHue/TuHue2 — 0-10v

Dual Circuit (DC) — Direct & Indirect
CCT controlled with ONE dimmer (indirect only)

Intensity controlled with TWO dimmers (direct & indirect separately)

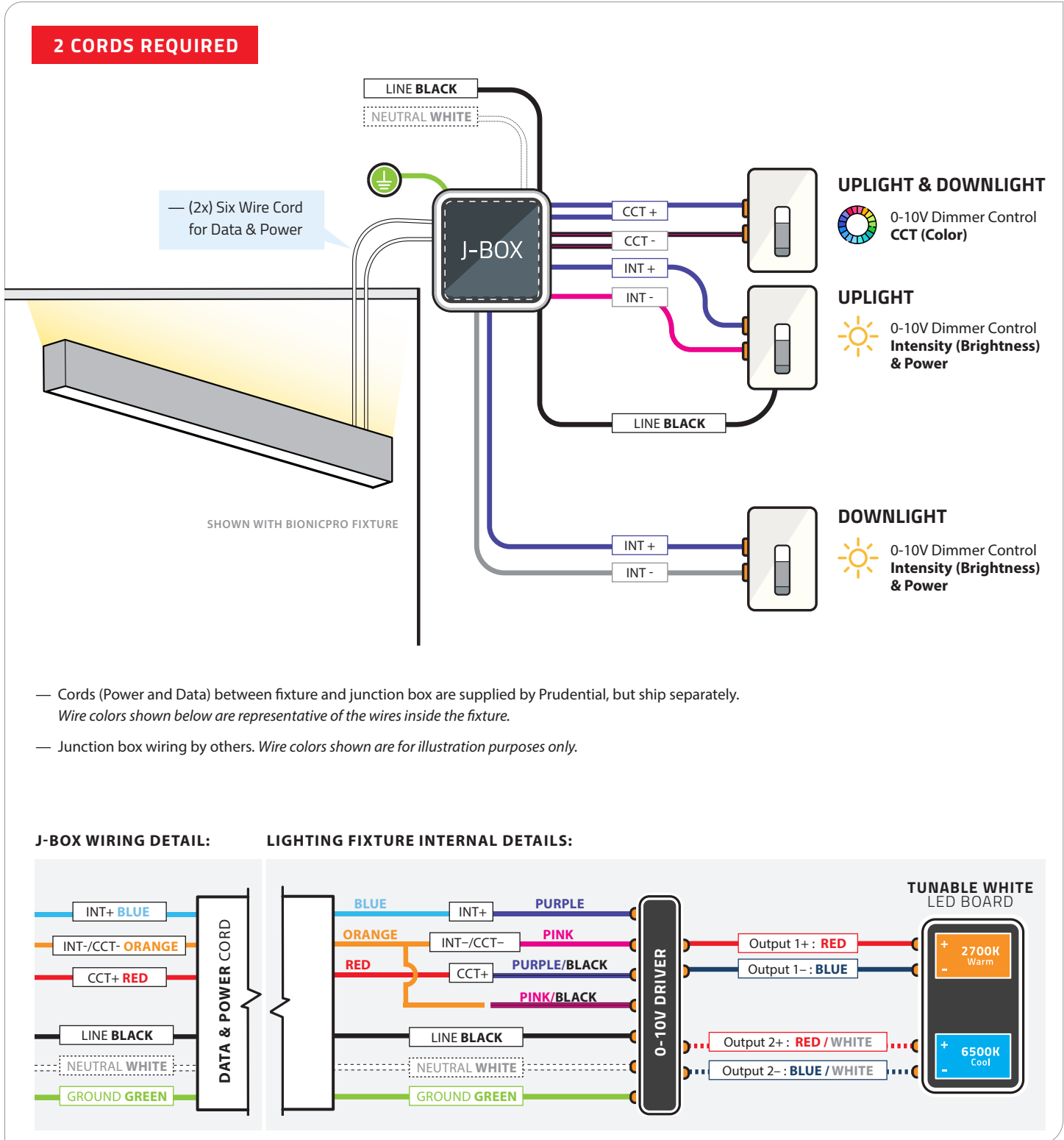

WARNING: Ground fixture in accordance with local and national electrical codes. Failure to do so may result in serious personal injury. Fixture Installations should ONLY be done by a qualified licensed electrical professional.



TuHue/TuHue2 — DALI

Single Circuit (SC) — Direct & Indirect
 CCT & Intensity controlled with ONE PruTune Controller (direct & indirect)
 (or other DALI controller, by others)

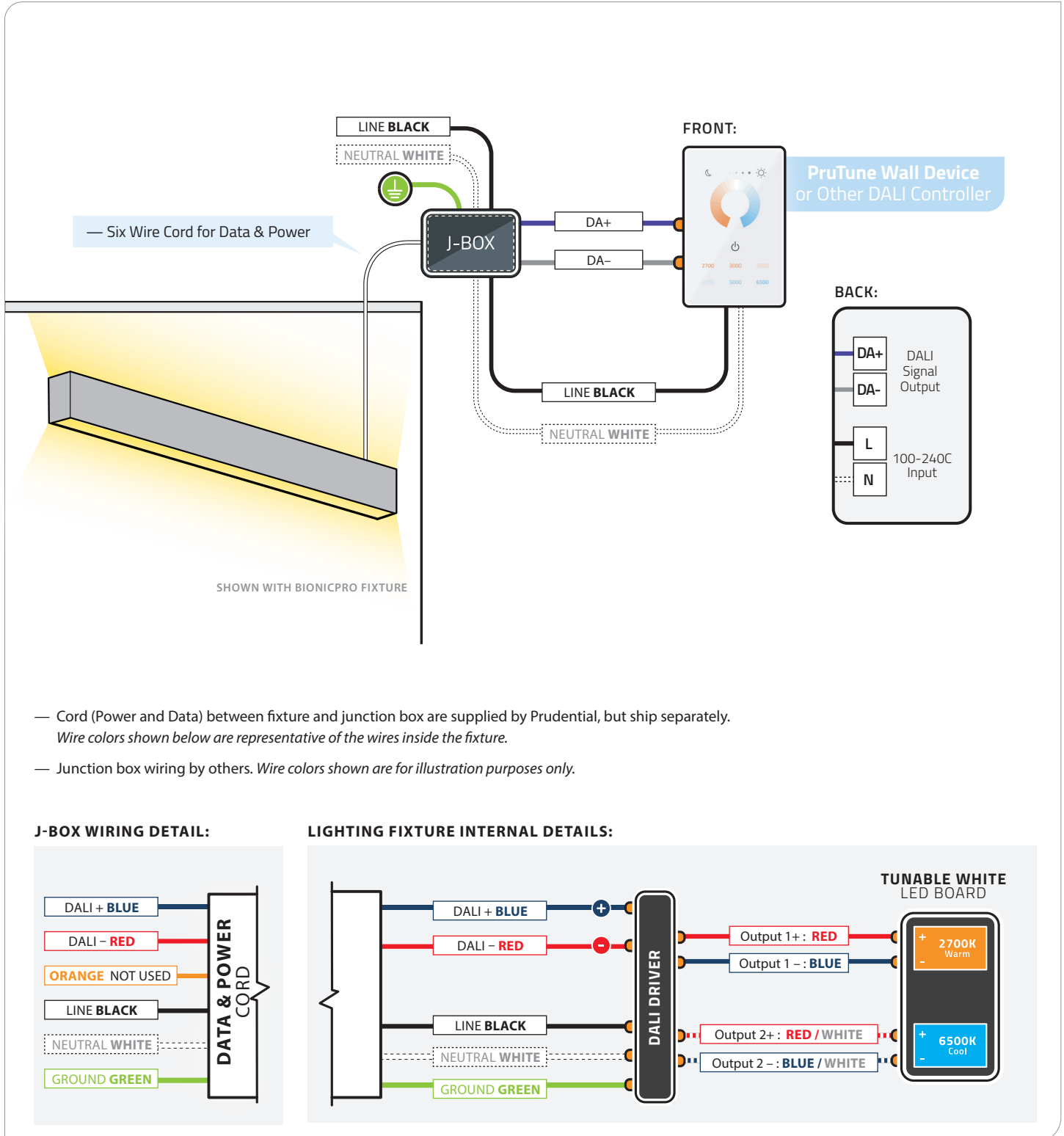

- Cord (Power and Data) between fixture and junction box are supplied by Prudential, but ship separately. Wire colors shown below are representative of the wires inside the fixture.
- Junction box wiring by others. Wire colors shown are for illustration purposes only.

J-BOX WIRING DETAIL:

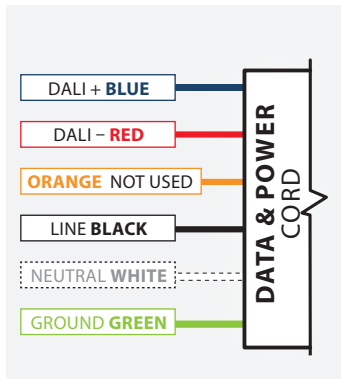

LIGHTING FIXTURE INTERNAL DETAILS:

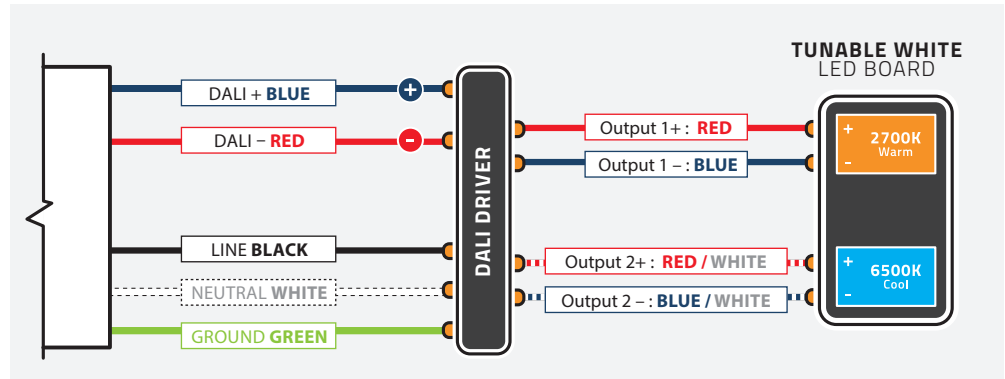

WARNING: Ground fixture in accordance with local and national electrical codes. Failure to do so may result in serious personal injury. Fixture Installations should ONLY be done by a qualified licensed electrical professional.

TuHue/TuHue2 — DALI

Dual Circuit (DC) — Direct & Indirect
CCT & Intensity controlled with TWO PruTune Controllers (one direct, one indirect)
(or other DALI controller, by others)

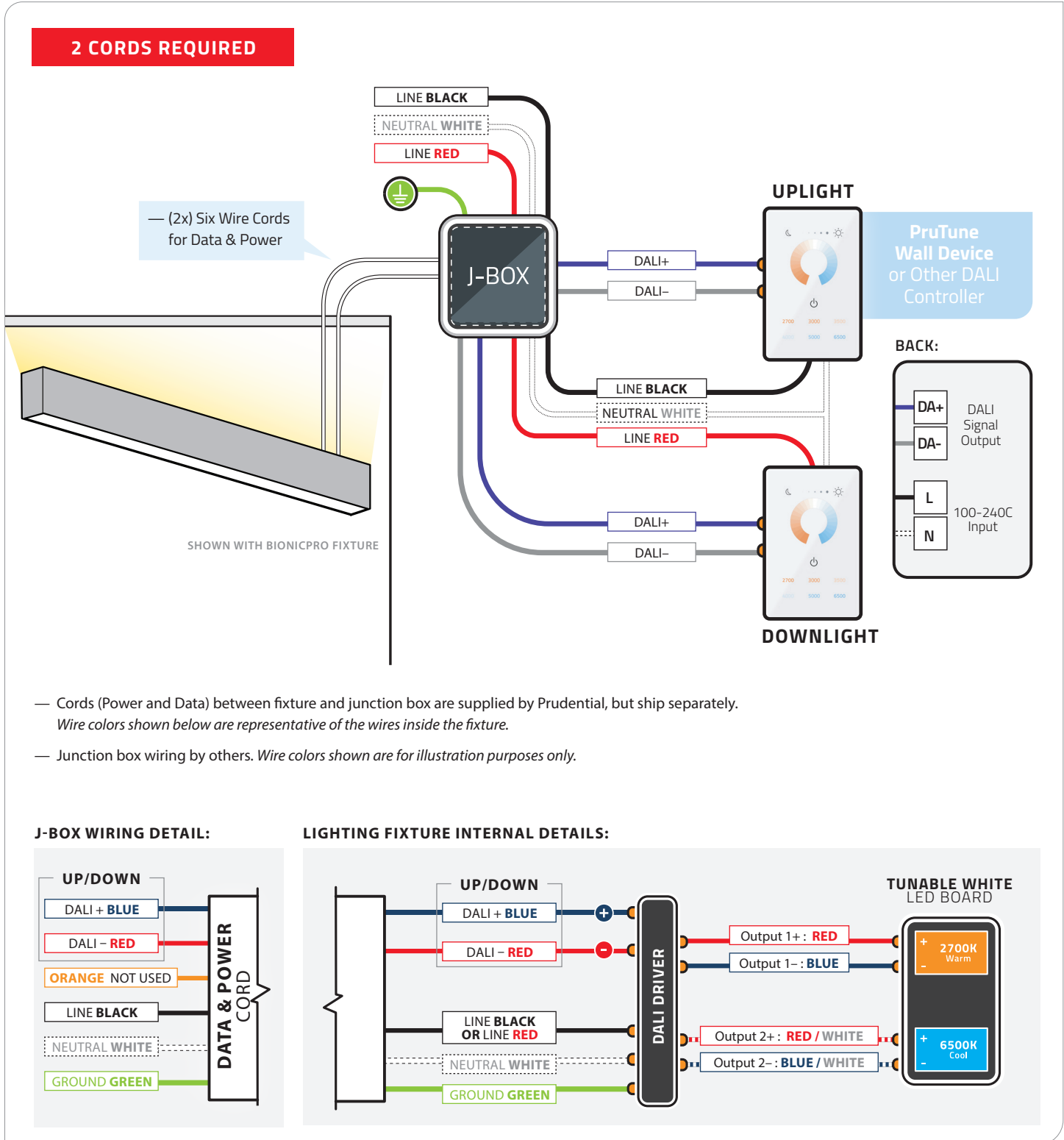

WARNING: Ground fixture in accordance with local and national electrical codes. Failure to do so may result in serious personal injury. Fixture Installations should ONLY be done by a qualified licensed electrical professional.

TuHue/TuHue2/ChromaHue — DMX

Single Circuit (SC) or Dual Circuit (DC)
CCT & Intensity controlled with DMX controller (by others)

3 CORDS REQUIRED

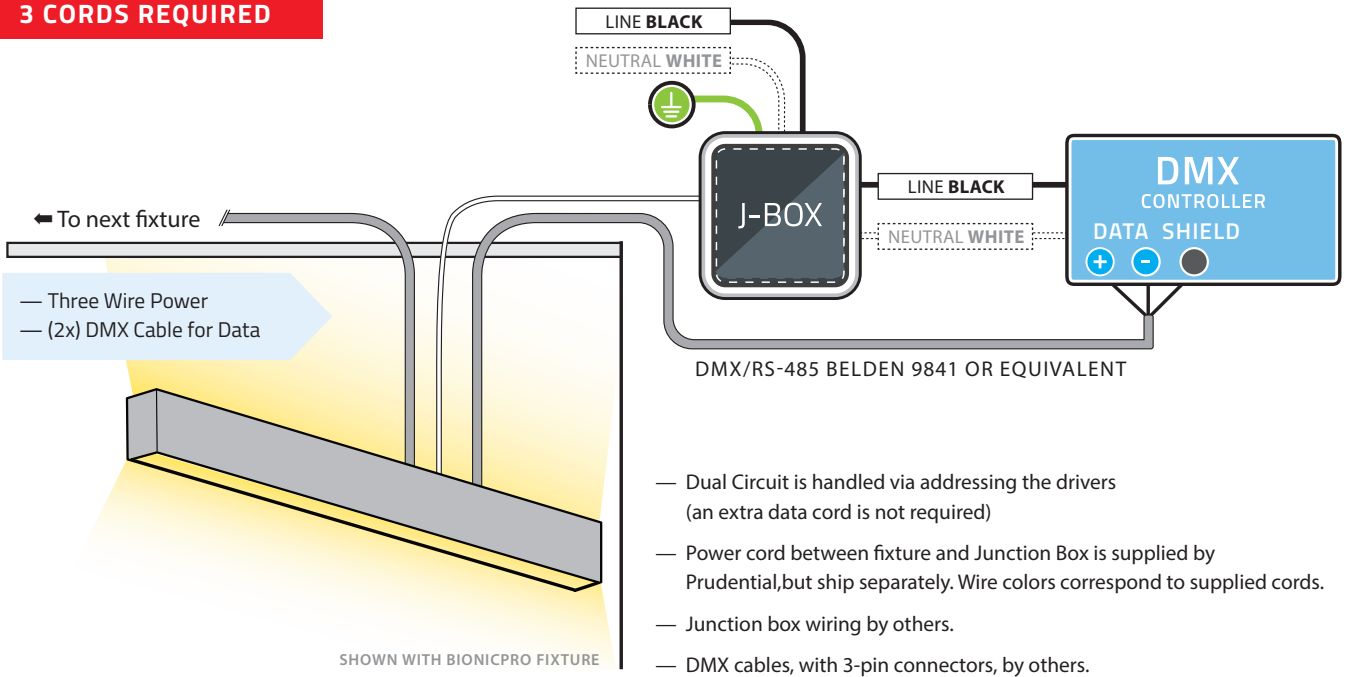

**J-BOX WIRING DETAIL:
DMX CONNECTIONS**

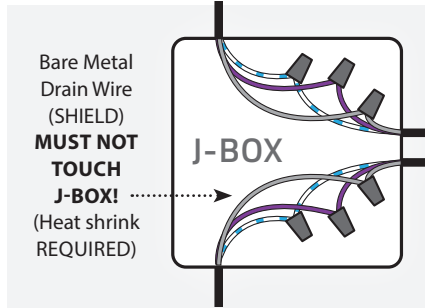

DMX CONNECTOR DETAIL:

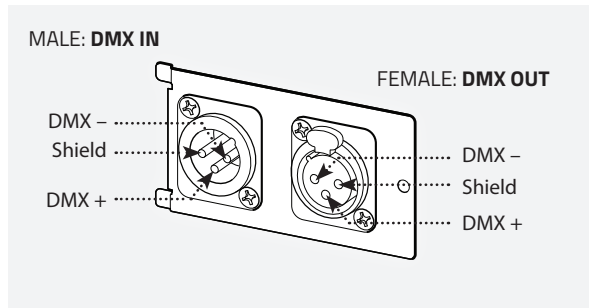

8 PIN CONNECTOR DETAIL:

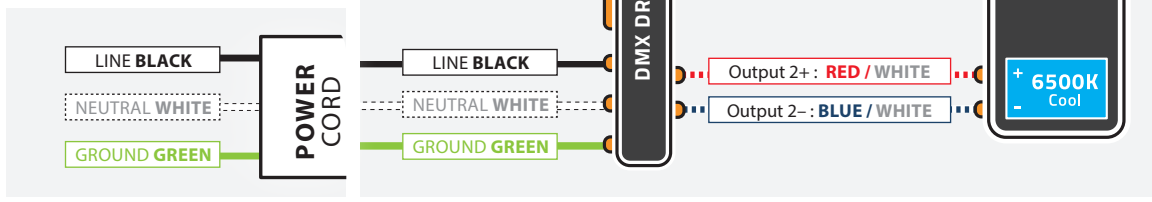
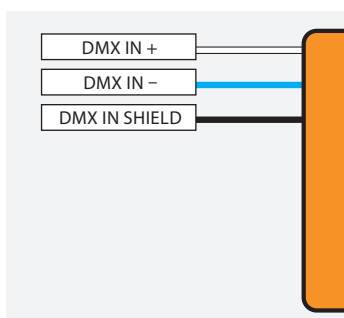

FOR MULTIPLE FIXTURES
SEE NEXT PAGE

WARNING: Ground fixture in accordance with local and national electrical codes. Failure to do so may result in serious personal injury. Fixture Installations should ONLY be done by a qualified licensed electrical professional.



TuHue/TuHue2/ChromaHue — DMX

Single Circuit (SC) or Dual Circuit (DC)

Multi-fixture layout

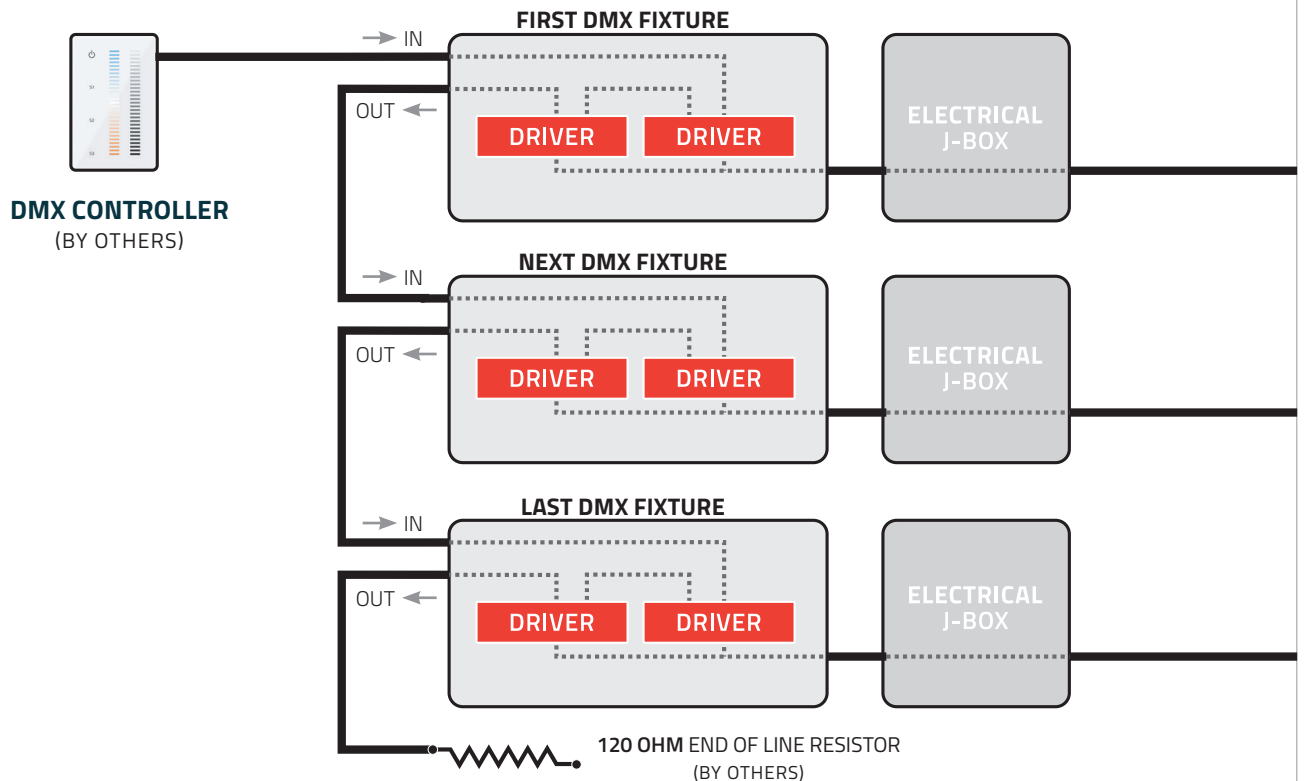

RECOMMENDATIONS

- Complete DMX requirements form.
- Fixtures must be daisy chained. (Drivers internal to fixture and daisy chained)
- Maximum 32 drivers per controller, consult factory for quantity of drivers per fixture.
If more than 32 drivers a DMX booster / repeater (by others) must be used.
- Keep DMX cable less than 1000ft between controller and end of line resistor.
- Cables connecting fixtures must be designed for DMX/RS-485, Beldin 9841 or equivalent.
- If more than one zone, fixtures per zone must be specified.

WARNING: Ground fixture in accordance with local and national electrical codes. Failure to do so may result in serious personal injury. Fixture Installations should ONLY be done by a qualified licensed electrical professional.



TuHue/TuHue2 — nLight

Single Circuit (SC)

CCT & Intensity controlled with nLight controller (by others)

3 CORDS REQUIRED

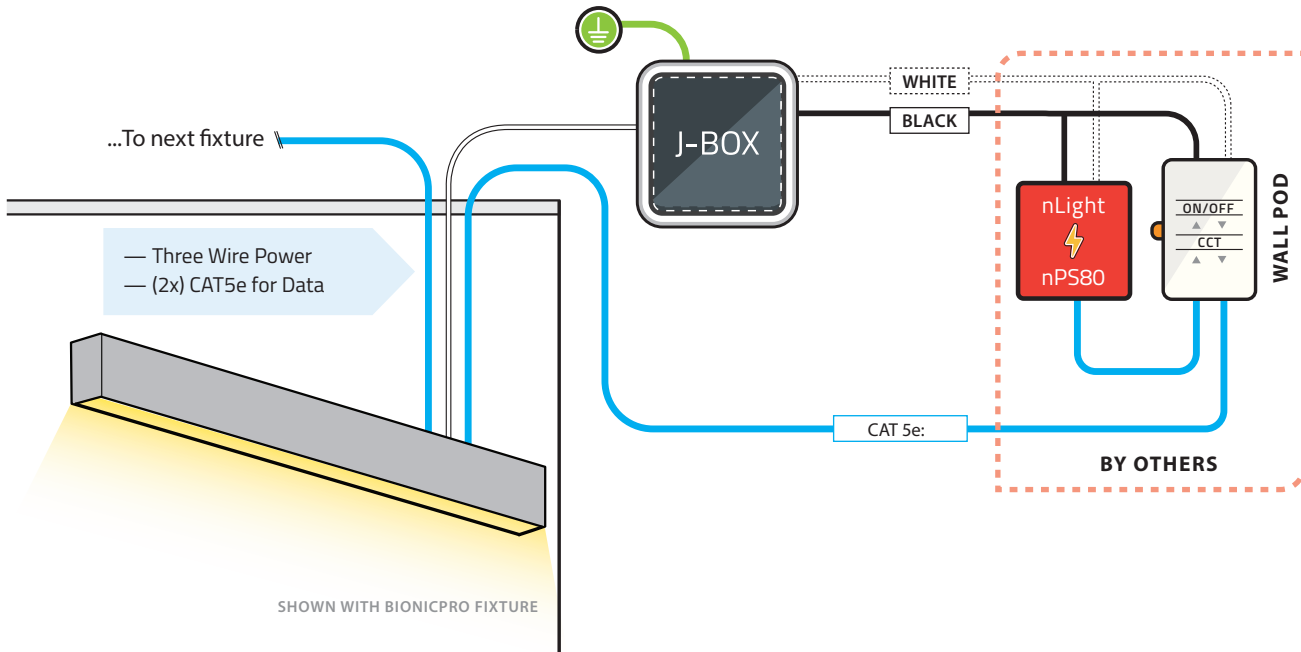

RJ45 CONNECTOR DETAIL:

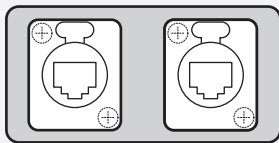

- Cords (Power and Data) between fixture and Junction Box are supplied by Prudential, but ship separately. Wire colors correspond to supplied cords
- Wiring from Junction Box to Controllers is by others. Wire colors are for illustration purposes only
- CAT5e cables by others

LIGHTING FIXTURE INTERNAL DETAILS:

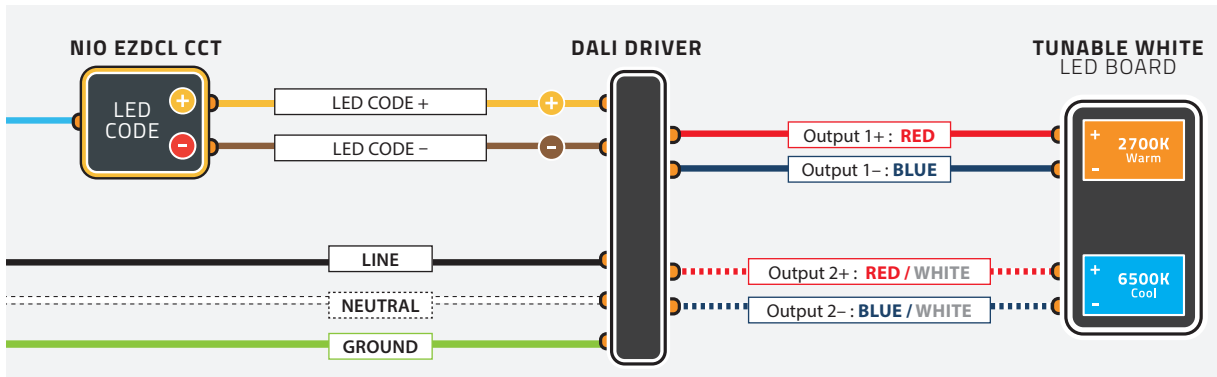

WARNING: Ground fixture in accordance with local and national electrical codes. Failure to do so may result in serious personal injury. Fixture Installations should ONLY be done by a qualified licensed electrical professional.



TuHue/TuHue2 — nLight

Single Circuit (SC)
Multi-fixture layout

TYPICAL NETWORK LAYOUT

3 CORDS REQUIRED

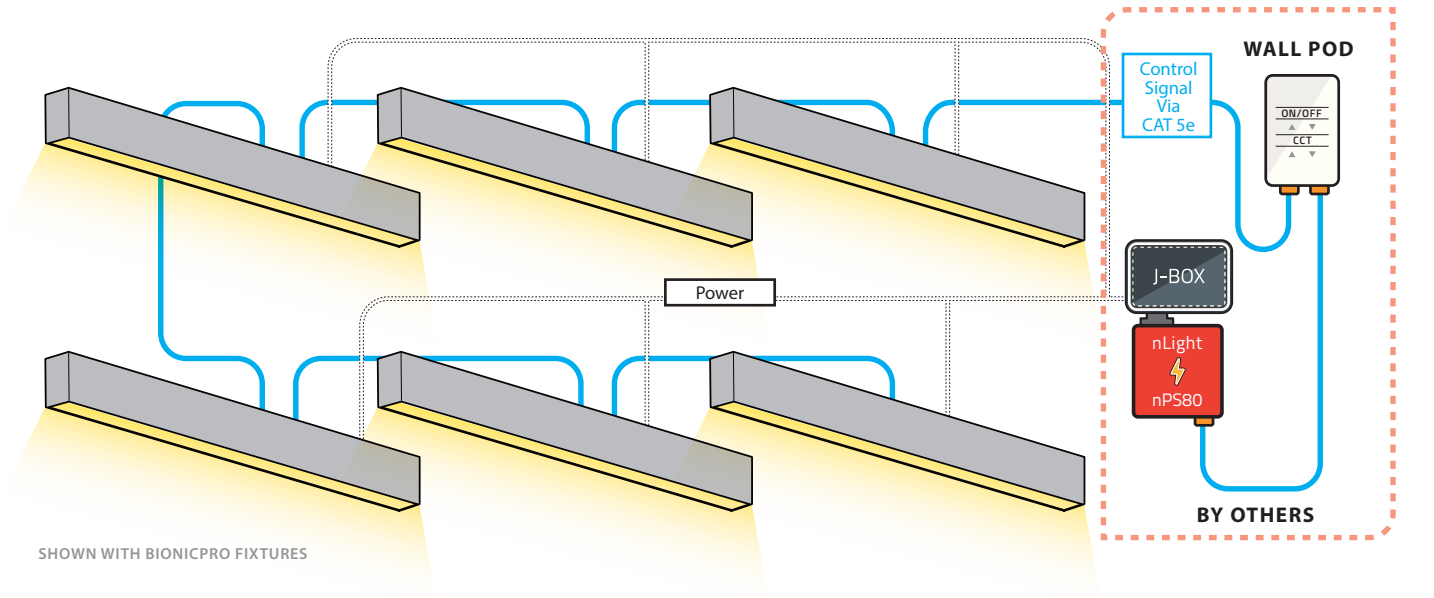

- All nLight RJ45 ports are interchangeable (no dedicated IN or OUT).
- nLight zones must have a net positive amount of bus power. See table below for bus power consumption as a function of fixture size and output. Bus power is supplied by power/relay packs (nPP16 family and nPS80), power supplies (PP20 PL BP and nPANELS), nLight enabled fixtures, and bridges.

BUS POWER CONSUMPTION

	LO				MO				SO				HO			
	D1	D9	SC	DC	D1	D9	SC	DC	D1	D9	SC	DC	D1	D9	SC	DC
P4018	1mA			N/A	1mA			N/A				2mA				2mA
P4020	1mA			N/A	1mA			N/A	2mA	1mA	2mA	3mA	2mA	1mA	2mA	3mA
P4030	2mA	2mA		3mA	3mA	3mA		4mA	4mA	4mA		5mA	N/A			
P4040	3mA	3mA		4mA	3mA	4mA		4mA	5mA	6mA		6mA	N/A			

WARNING: Ground fixture in accordance with local and national electrical codes. Failure to do so may result in serious personal injury. Fixture Installations should ONLY be done by a qualified licensed electrical professional.