

Snap's sleeker, more sophisticated sibling now with much higher lumen levels (and efficiencies). Improved aesthetic with more LEDs close together for smooth, soft side viewing of lens. Available in any row length (1/8" increments) and a multitude of fully illuminated corners.

UP TO **140** LPW

High Output:
BOLTPRO-LED4-HO-04-SAL-DM01
 6853 Delivered Lumens
 49 Watts
 140 lm/w
 4000 CCT

| SAL: | LO | MO | SO | HO |
|--|------|-----|------|------|
| lm/ft | 525 | 925 | 1300 | 1700 |
| w/ft | 3.75 | 6.5 | 9.4 | 12.5 |
| BLUHUE, TUHUE, TUHUE2, AMBERHUE | | | | |
| lm/ft | 450 | 670 | 890 | 1100 |
| w/ft | 4 | 6 | 8 | 10 |

TUNABLE WHITE

Tu Hue
 Amber Hue
 Blu Hue
 Chroma Hue



Lumen output may vary +/- 5%
 Light Loss Factor (LLF) for CCTs other than 3500K:
 4000K +2%, 3000K -5%, 2700K -20%
 90 CRI -15% (3K, 3500K, 4K & 5K)

| SERIES | LED COLOR | OUTPUT | NOMINAL LENGTH | SHIELDING | COLOR/ FINISH | VOLT- AGE | MOUNT- ING | CEILING SYSTEMS | DRIVERS | OPTIONS, SENSORS & CORNERS |
|----------|--|---|---|------------------------|--|---|--|---|---|---|
| BOLT-PRO | | | | SAL | | | | | | |
| | LED27 2700K (90CRI) LED3 3000K LED35 3500K LED4 4000K LED3-90 3000K (90CRI) LED35-90 3500K (90CRI) LED4-90 4000K (90CRI) LED5-90 5000K (90CRI) | LO Low MO Medium SO Standard HO High PROG Programmable Light Output (Specify desired lm/ft or w/ft) | 2' 3' 4' 5' 6' 7' 8' R____ (Row length to 1/8") | SAL Satin Acrylic Lens | TMW Textured Matte White YGW Gloss White (Standard) Y____ Premium Color CC Custom Color LUXE METALLICS: YBZ Bronze YCP Copper Penny YGN Gold Nugget NOTE: All canopies are painted the same color as the fixture. Consult factory to specify | UNV (120-277) 347 (Emergency battery requires a Step Down transformer) | SUR Ceiling or Wall Mount CA48", 96" & 144" Aircraft Cable (Adjustable) | X1 T-Bar 1 5/16" or 3/16" (Standard) Consult factory for 3/16" Tegular X2 Dimensional T-Bar Armstrong Interlude® X3 Hard Ceiling X6 Slot Grid or Interlude | ND Non-Dimming DM01 0-10v, 1% Dimming (Standard) LDE1 Hi-lume 1% EcoSystem LED (Soft fade on, fade-to-black dimming) ECO 1% 0-10v, EldoLED (Logarithmic dimming std) ECDA 1% DALI, EldoLED (Logarithmic dimming std) nLight-Air Acuity nLight Drivers (ECDA driver ONLY) nLight-Wired Acuity nLight nLO Drivers (ECO driver ONLY, Requires Remote Driver) SOLO 0.1% 0-10v, EldoLED (Dim-to-dark, Logarithmic dimming std) SODA 0.1% DALI, EldoLED (Dim-to-dark, Logarithmic dimming std) STEP Signify Advance Step Dimming 2WIRE ELV/Forward/Reverse Phase Driver PRUHUES: E10V 2 Channel Color Control EDALI 2 Channel Color Control EDMX ChromaHue or Static White | EMHE CA T20 Emergency Battery (1250 Delivered lumens; CA Title 20 compliant; 4' or longer) ETS-DR Iota ETS-DR Emergency Transfer Switch EBCP1G/2G Single/ Dual Gang (Electrical Box Cover Plate/Mud Ring) JA8 90 CRI, ECO Driver Only (Consult factory for pricing) PruTune Wall Device (EDALI driver only, one PruTune device for each zone) |
| | PRUHUES: bios STATIC: BLU3S BLU35S BLU4S DYNAMIC: BLU3D* BLU35D* BLU4D* * Dynamic BIOS, SkyBlue spike can be dimmed, CCT warms slightly TU TuHue 2700-6500K Tunable White TU2 TuHue 2200-5000K Tunable White AMB AmberHue Warm Dim 2200K-5000K CHR ChromaHue RGBW (DMX at HO only) | | SRL Symmetric Row Length (See page 5) Row lengths are typically made up of 8' and 4' fixtures, (eg. 12' row is (1) 8' and (1) 4', unless SRL Symmetric Row Lengths are specified NOTE: Individual fixtures are NOT intended for row mounting For Patterns, Specifiers may write in 'Pattern' and include a drawing with corners and dimensions | | | | | | 205 WattStopper PIR Occupancy 205-ON/OFF 205-STEP: Dim to 50% 205-DM: Dim to 1% (NA with DALI) ATHENA Lutron RF (Dim-to-Off Standard) LVOC** Lutron Vive (Occ & RF) LVRF** Lutron Vive (RF Only) ** Requires Lutron driver NXSMF Hubbell (Occ) rE57 Daylight+ (PIR Acoustic) (Occ) (nLight-Air) Part Number: rE57-PDT-180D-G2 nE57 Daylight+(PIR Acoustic) (Occ) (nLight-Wired) Part Number: nE5-PDT7-ADCX LUX Philips DLR | |
| | | | | | | | | | | SENSORS: (NA w/EDMX) CORNERS: C2 Lit 2-Way C3T Lit 3-Way 90°: T C3Y 120° Lit 3-Way: Y C4 Lit 4-Way 90° Cross C2X Lit 2-Way, (Any angle 45° to 179°, 1" increments) C3T-X Lit 3-Way: T (45° to 135°) C3Y-X Lit 3-Way: Y (45° to 135°) C4X Lit 4-Way (45° to 135°) |



PHOTOMETRICS

High Output:

BOLTPRO-LED4-HO-04-SAL-DM01

6853 Delivered Lumens

49 Watts

140 lm/w

4000 CCT

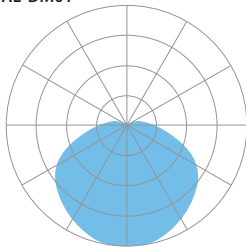

Zonal Lumen Summary:

0-90 (Down) = 86.9%

90-180 (Up) = 13.1%

| Vertical Angle | 0° | 22.5° | 45° | 67.5° | 90° |
|----------------|------|-------|------|-------|------|
| 0° | 1849 | 1849 | 1849 | 1849 | 1849 |
| 5° | 1862 | 1856 | 1840 | 1839 | 1843 |
| 15° | 1804 | 1797 | 1775 | 1757 | 1739 |
| 25° | 1668 | 1655 | 1620 | 1583 | 1540 |
| 35° | 1523 | 1493 | 1420 | 1347 | 1271 |
| 45° | 1406 | 1349 | 1218 | 1083 | 973 |
| 55° | 1280 | 1206 | 1022 | 825 | 684 |
| 65° | 1089 | 1018 | 822 | 593 | 427 |
| 75° | 833 | 783 | 615 | 383 | 209 |
| 85° | 578 | 548 | 421 | 216 | 44 |
| 90° | 473 | 453 | 98 | 165 | 5 |
| 95° | 405 | 391 | 310 | 150 | 4 |
| 105° | 307 | 300 | 246 | 124 | 4 |
| 115° | 246 | 240 | 192 | 72 | 5 |
| 125° | 205 | 193 | 120 | 56 | 5 |
| 135° | 146 | 114 | 82 | 45 | 6 |
| 145° | 105 | 80 | 66 | 36 | 7 |
| 155° | 74 | 56 | 46 | 27 | 8 |
| 165° | 17 | 23 | 11 | 16 | 10 |
| 170° | 9 | 9 | 9 | 9 | 9 |

LUMEN MAINTENANCE

L70 — 200,000+ Hours

L90 — 100,000+ Hours (LO, MO & SO)

L90 — 60,000+ Hours (HO)

LED SYSTEM LED modules and drivers are field replaceable.

PROG (OPTIONAL)

Programmable light output. Specify desired lumens or watts per linear foot. Min: 3.75 w/ft, Max 12.5 w/ft.

LABELS CSA and ETL damp labeled and I.B.E.W. manufactured.

ELECTRICAL

Must specify LED dimming controls. LED fixtures have constant current driver(s) with less than 20% THD when loaded to a minimum of 60%. Drivers sink a maximum of 6mA per driver. DM01 LED drivers are 0-10V dimmable and are compatible with most 0-10V wall slide dimmers and direct 0-10V analog signal dimmers. Max driver size 1.65" w x 1.25" h.

32v Forward Voltage (+/- 1 volt based on drive current)

Drive Currents: **LO:** 100mA, **MO:** 100mA, **SO:** 250mA, **HO:** 325mA

CONSTRUCTION

Housing Extruded aluminum, 25% PC recycled, 100% recyclable

End Caps Cast aluminum, >25% PC recycled, 100% recyclable

Lens Single-piece (up to 8' lengths) extruded acrylic, 100% recyclable

Weight 2 lbs/ft

MOUNTING

Surface mounted to walls or ceilings or suspended by cable.

WARRANTY

Single-source, 5 year limited warranty covers standard components and construction.



FINISH COLORS

STANDARD:

| | |
|----------------------------|-------------------|
| TMW — Textured Matte White | YGW — Gloss White |
|----------------------------|-------------------|

PREMIUM:

| | |
|------------------------------|-------------------------------|
| YSW — Seashell White (Matte) | YRG — Rain Grey (Gloss) |
| YPE — Pewter (Matte) | YSTM — Storm Grey (Matte) |
| YBK — Black (Matte) | YBB — Black (Semi Gloss) |
| YSKM — Sky (Matte) | YMB — Military Blue (Matte) |
| YSAM — Sapphire (Matte) | YIB — Interstate Blue (Matte) |
| YBR — Bronze (Matte) | YSRM — Sunset Red (Matte) |
| YOR — Orange (Matte) | YDAM — Daffodil (Matte) |
| YFGM — Forest Green (Matte) | YSL — Silver (Metallic) |

LUXE METALLICS:

| | |
|-------------------------------|------------------------------|
| YCP — Copper Penny (Metallic) | YGN — Gold Nugget (Metallic) |
| YBZ — Bronze (Metallic) | |

Choose from one of our Premium Colors with no set-up fee.

For paint chip samples, please email: info@prulite.com



ADJOINING DETAILS

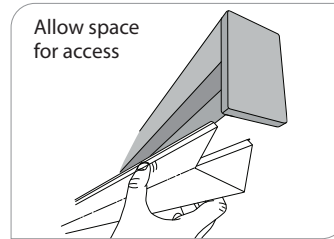
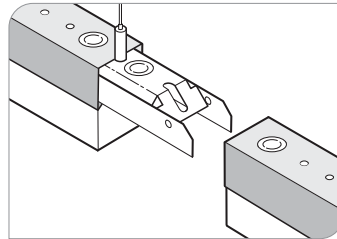

EBCP ELECTRICAL BOX COVER (OPTIONAL)

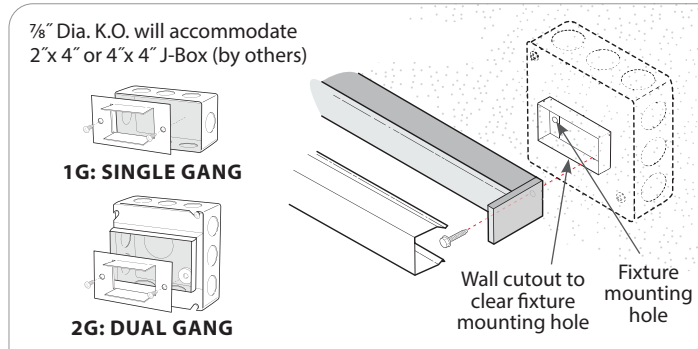

MOUNTING LOCATIONS

INDIVIDUAL FIXTURE:

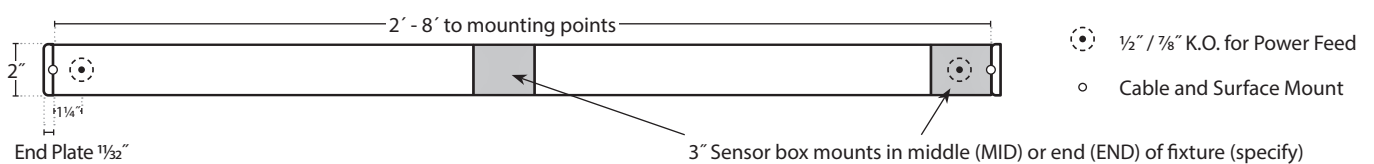

CABLE OR SURFACE MOUNTING WITH SENSOR BOX:

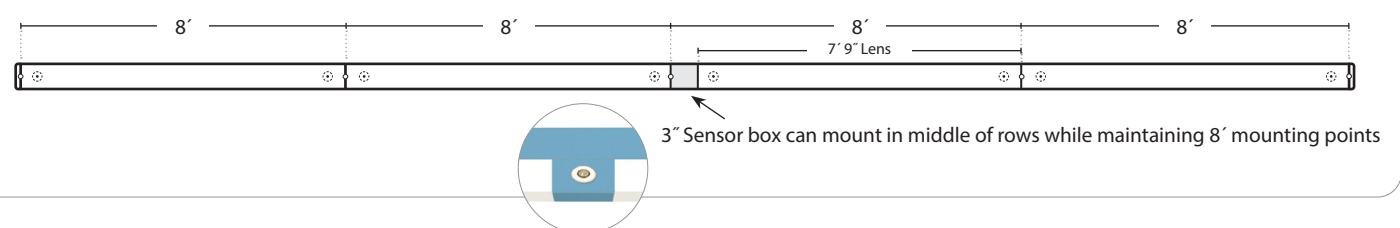



CORNERS

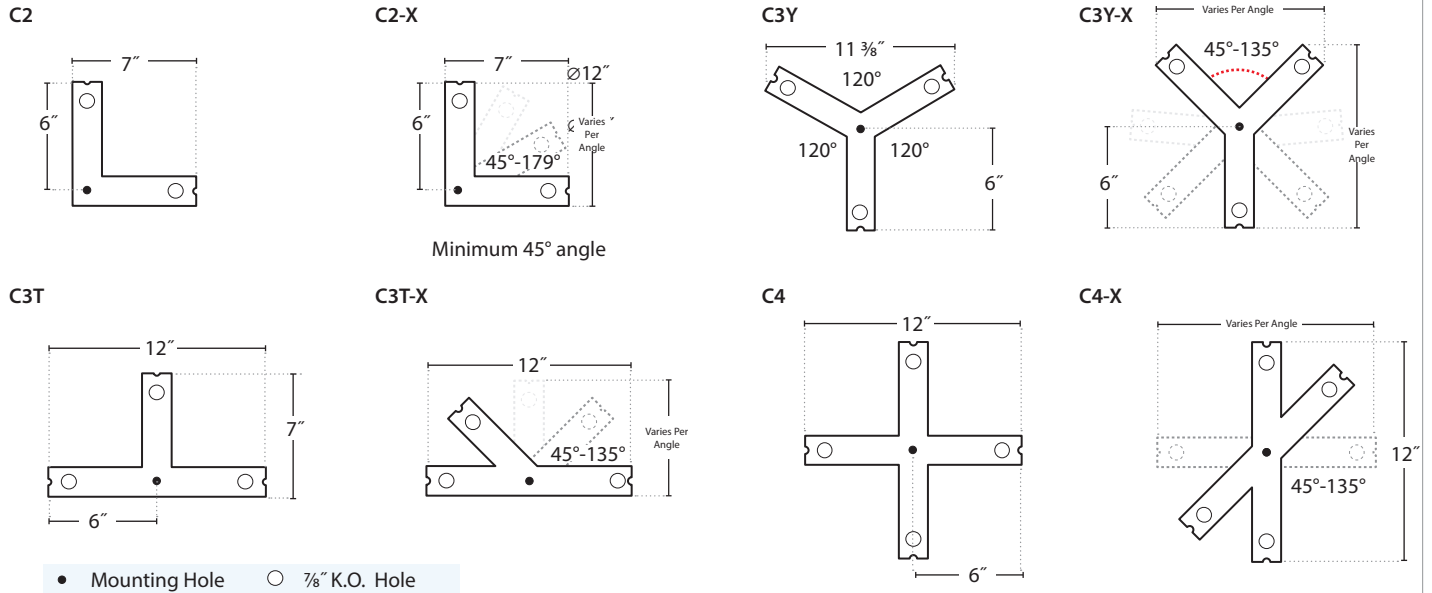

SPECIFYING PATTERNS:

A configuration drawing is required (examples below), consult factory for assistance.

NOTE:

- Lens seams only at mitered corners or lengths above 8'
- Aluminum extrusion

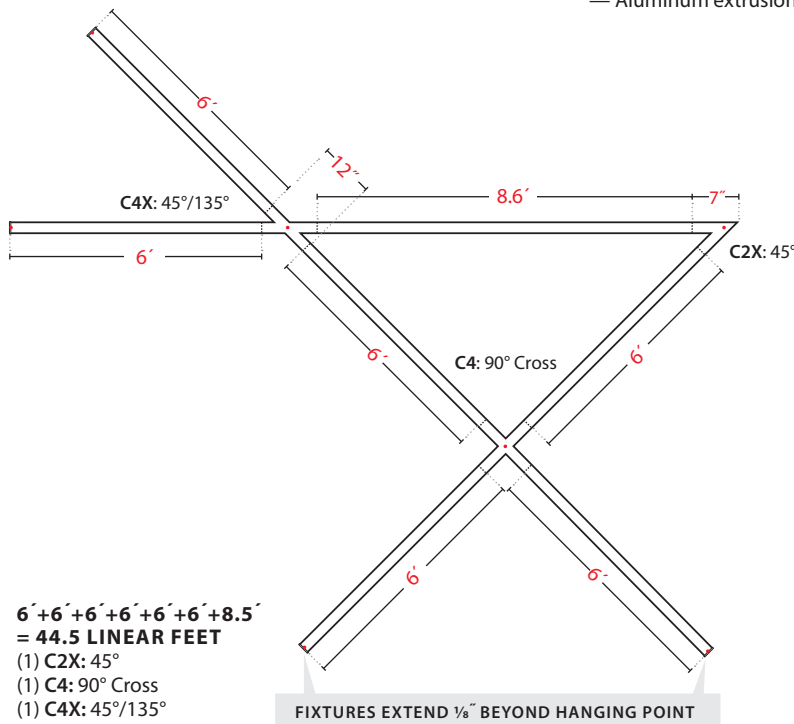

$6' + 6' + 6' + 6' + 6' + 6' + 8.5'$
= 44.5 LINEAR FEET
 (1) C2X: 45°
 (1) C4: 90° Cross
 (1) C4X: 45°/135°

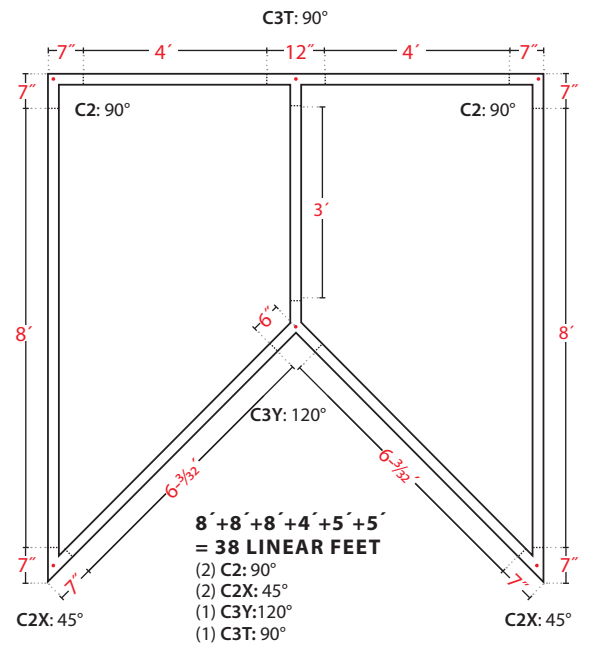

$8' + 8' + 8' + 4' + 5' + 5'$
= 38 LINEAR FEET
 (2) C2: 90°
 (2) C2X: 45°
 (1) C3Y: 120°
 (1) C3T: 90°



18' TYPICAL:

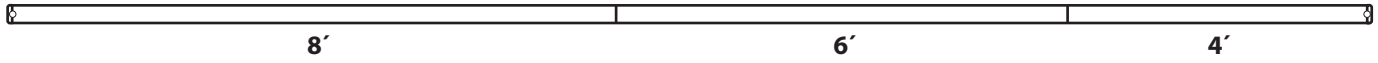

18' SYMMETRIC ROW LENGTH (SRL):

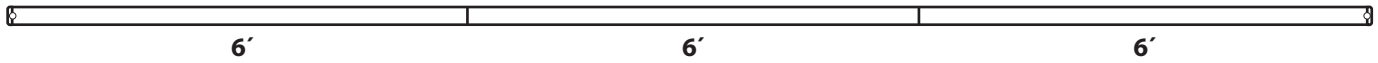

| ROW LENGTH | FIXTURE BREAKDOWN | SYMMETRIC ROW LENGTH (SRL) |
|------------|--------------------------|----------------------------|
| 9' | (1) 6' + (1) 3' | (3) 3' |
| 10' | (1) 6' + (1) 4' | 5' + 5' |
| 11' | (1) 8' + (1) 3' | 4' + 3' + 4' |
| 12' | (1) 8' + (1) 4' | (2) 6' |
| 13' | (1) 8' + (1) 5' | 4' + 5' + 4' |
| 14' | (1) 8' + (1) 6' | (2) 7' |
| 15' | (1) 8' + (1) 7' | (3) 5' |
| 16' | (2) 8' | — |
| 17' | (1) 8' + (1) 6' + (1) 3' | 6' + 5' + 6' |
| 18' | (1) 8' + (1) 6' + (1) 4' | (3) 6' |
| 19' | (2) 8' + (1) 3' | 6' + 7' + 6' |
| 20' | (2) 8' + (1) 4' | 8' + 4' + 8' |
| 21' | (2) 8' + (1) 5' | (3) 7' |
| 22' | (2) 8' + (1) 6' | 8' + 6' + 8' |
| 23' | (2) 8' + (1) 7' | 8' + 7' + 8' |
| 24' | (3) 8' | — |
| 25' | (2) 8' + (1) 6' + (1) 3' | (5) 5' |
| 26' | (2) 8' + (1) 6' + (1) 4' | 7' + 6' + 6' + 7' |
| 27' | (3) 8' + (1) 3' | 5' + 5' + 7' + 5' + 5' |
| 28' | (3) 8' + (1) 4' | (4) 7' |
| 29' | (3) 8' + (1) 5' | 6' + 6' + 5' + 6' + 6' |

| ROW LENGTH | FIXTURE BREAKDOWN | SYMMETRIC ROW LENGTH (SRL) |
|------------|--------------------------|----------------------------------|
| 30' | (3) 8' + (1) 6' | (5) 6' |
| 31' | (3) 8' + (1) 7' | 6' + 6' + 7' + 6' + 6' |
| 32' | (4) 8' | — |
| 33' | (3) 8' + (1) 6' + (1) 3' | 7' + 7' + 5' + 7' + 7' |
| 34' | (3) 8' + (1) 6' + (1) 4' | 7' + 7' + 6' + 7' + 7' |
| 35' | (4) 8' + (1) 3' | (5) 7' |
| 36' | (4) 8' + (1) 4' | (6) 6' |
| 37' | (4) 8' + (1) 5' | 8' + 8' + 5' + 8' + 8' |
| 38' | (4) 8' + (1) 6' | 8' + 8' + 6' + 8' + 8' |
| 39' | (4) 8' + (1) 7' | 8' + 8' + 7' + 8' + 8' |
| 40' | (5) 8' | — |
| 41' | (4) 8' + (1) 6' + (1) 3' | 6' + 6' + 6' + 5' + 6' + 6' + 6' |
| 42' | (4) 8' + (1) 6' + (1) 4' | (6) 7' |
| 43' | (5) 8' + (1) 3' | 6' + 6' + 6' + 7' + 6' + 6' + 6' |
| 44' | (5) 8' + (1) 4' | 6' + 6' + 6' + 8' + 6' + 6' + 6' |
| 45' | (5) 8' + (1) 5' | 7' + 7' + 7' + 3' + 7' + 7' + 7' |
| 46' | (5) 8' + (1) 6' | 7' + 7' + 7' + 4' + 7' + 7' + 7' |
| 47' | (5) 8' + (1) 7' | 7' + 7' + 7' + 5' + 7' + 7' + 7' |
| 48' | (6) 8' | — |
| 49' | (5) 8' + (1) 6' + (1) 3' | (7) 7' |
| 50' | (5) 8' + (1) 6' + (1) 4' | (10) 5' |

NOTE: SRL will effect pricing – please consult factory.



WIRING DIAGRAMS
SPEC



PRUDENTIAL LTG.

PRULITE.COM 213.746.0360



Prudential Lighting's **TuHue** Tunable White provides warm to cool white light simulating sunlight. Controlling the light source color temperature offers differing design aesthetics with potential benefits via circadian rhythm support. Blue light for alertness while warm light conveys tranquility.

- 2700K-6500K or 2200K-5000K.
- Adjust the color temperate and brightness separately.
- Simulates warm to cool to warm transition of sunlight.

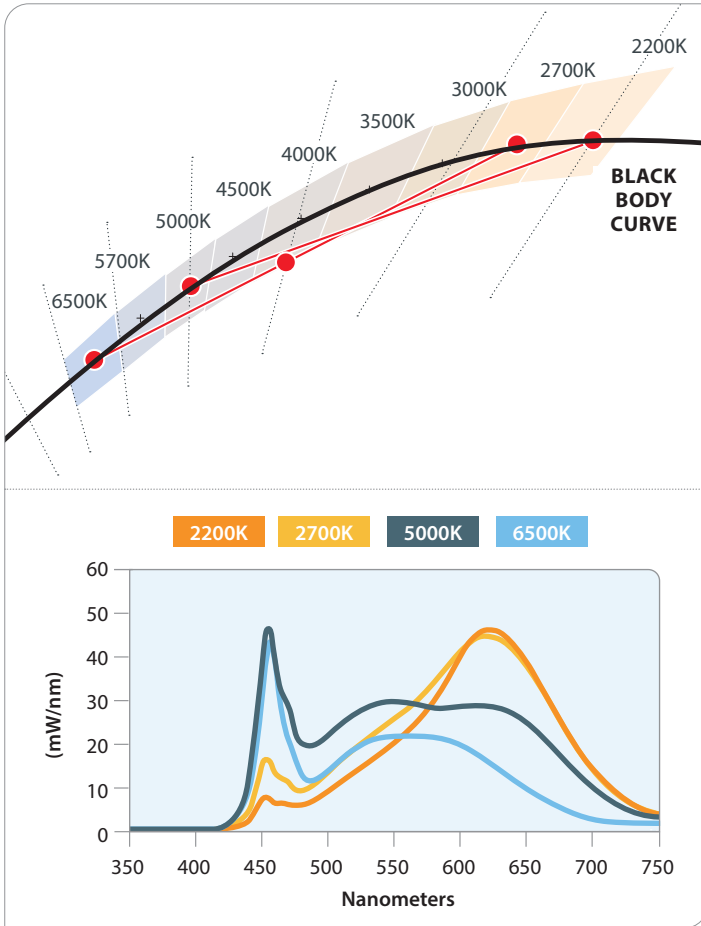

BluHue BIOS SkyBlue™ circadian LED lighting brings the benefits of blue skies inside. Newly discovered blue-sky receptors in our eyes drive improved daytime alertness, mood, brain function, and strengthens circadian rhythms leading to overall better health and well-being.

- Circadian rhythms play an integral role in physical and mental health.
- BluHue BIOS SkyBlue pinpoints peak 490nm sensitivity to provide the most benefit from an electric light source.
- At night, simply dim the lights to remove SkyBlue™ wavelengths (specify "Blu_D" to dim Cyan SkyBlue spike separately [night model]).

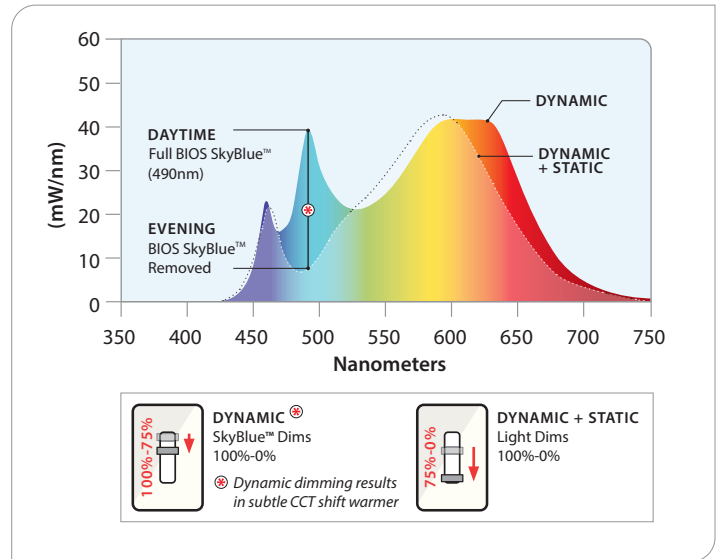

AmberHue is Prudential Lighting's Warm Dim offering. It transitions bright white light to warm amber light as brightness is dimmed, reflecting sunlight's transitioning from intense blue midday light to a dimmed golden hue near sunset, also reminiscent of soft glowing candlelight.

- Warm Dim 2200K-5000K.
- Color temperature warms as the luminaire is dimmed.
- Calm, relaxing mood communicated – hospitality, residential feel.

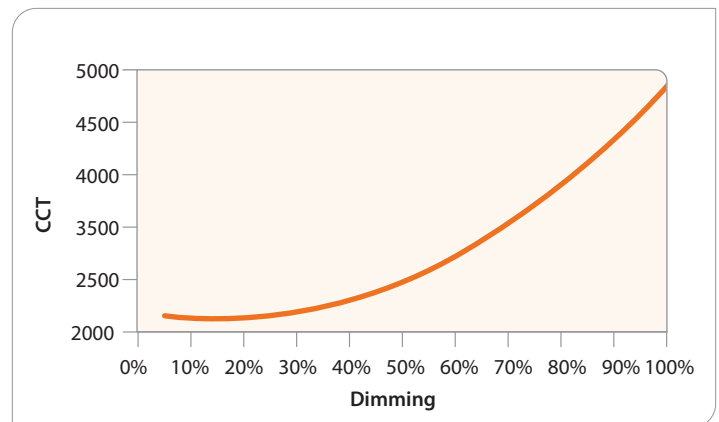



ChromaHue offers a vibrant full gamut of colors for seemingly endless architectural interior applications. Rich color-changing light offers tremendous design flexibility while white light can be achieved with the White chip, or mixing of Red, Green and Blue light. No longer just for the entertainment industry, ChromaHue can be intermixed on BionicPro luminaires for mood-creating indirect illumination combined with static white direct light.

- RGBW LED array (Red, Green, Blue, White) with full spectrum color and white light on the black body curve.
- Four-channel control, DMX drivers.
- Any color point within the triangle can be reached by setting the proper output levels for each individual red, green, blue and white channels.
- Standard DMX is one zone with one XLR drop at start, one XLR return at the end.

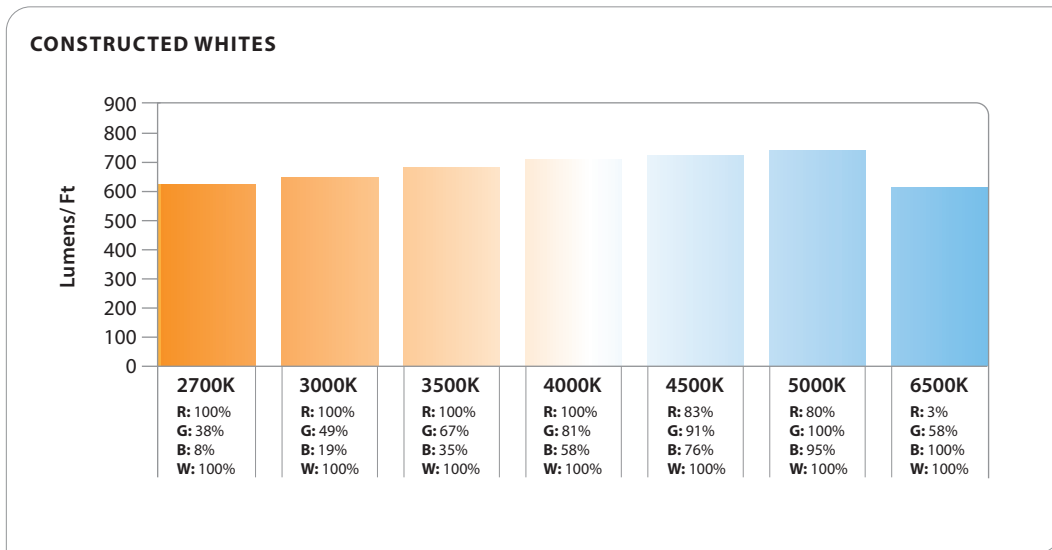
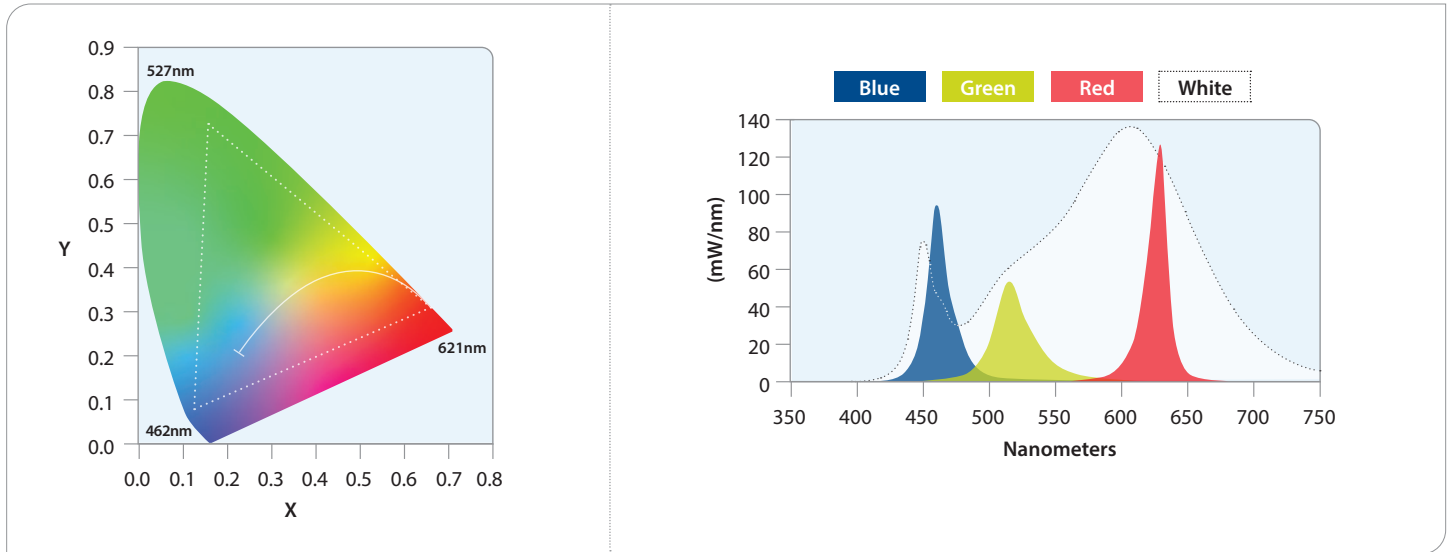



PRUTUNE WALL DEVICE

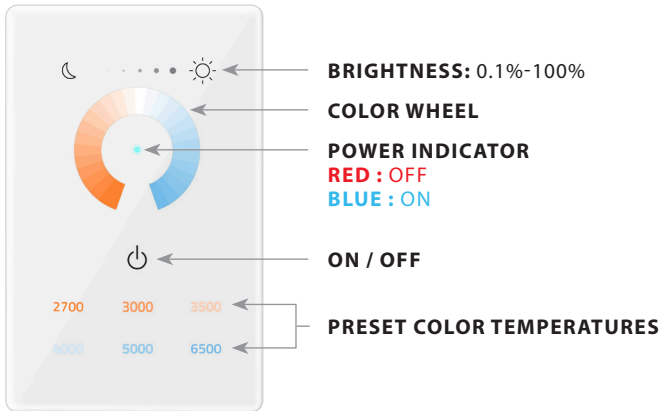

PRUTune DALI device includes:

- Easy-to-understand user control with intuitive design
- Out-of-the-box set-up, no commissioning needed
- Color wheel for color change from 2700K to 6500K
- Dimming to 0.1% (255 Steps)
- Six preset colors (2700K, 3000K, 3500K, 4000K, 5000K, 6500K)
- Must use DALI driver, consult factory to control non-Prudential Ltg Tunable White fixtures
- Control one (1) zone - up to 30 drivers
 (Consult factory for fixture quantity dependant upon fixture type, size & output)

PRUTune + EMHE: — Prutune does not have memory

- Once normal power is restored, the controller sends a signal of 100% intensity and 6500K CCT

EXPLODED VIEW

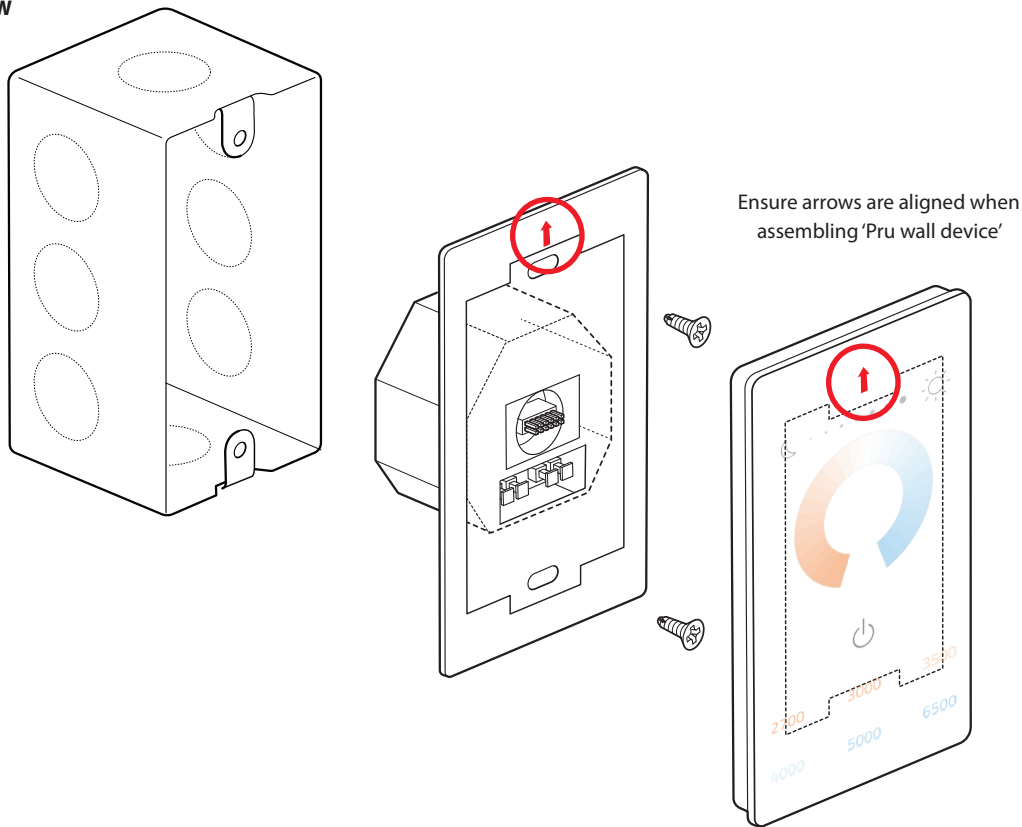



LM79 & TM30 DATA:

| | MEASURED CCT | MEASURED LUMENS | CRI | R9 | DuV | SPD | TM30 — COLOR VECTOR | TM30 — COLOR DISTORTION |
|-----------------|--------------|-----------------|-----|----|-------|-----|---------------------|-------------------------|
| LED27 | 2680 | 80% | 93 | 58 | 0.001 | | 89 Rf | 97 Rg |
| LED3 | 3042 | 95% | 82 | 6 | 0.001 | | 81 Rf | 92 Rg |
| LED3-90 | 3016 | 85% | 93 | 61 | 0.000 | | 88 Rf | 96 Rg |
| LED35 | 3482 | 100% | 82 | 3 | 0.002 | | 81 Rf | 92 Rg |
| LED35-90 | 3417 | 85% | 93 | 67 | 0.000 | | 88 Rf | 96 Rg |
| LED4 | 3952 | 102% | 82 | 4 | 0.003 | | 81 Rf | 92 Rg |
| LED4-90 | 3882 | 85% | 92 | 67 | 0.003 | | 87 Rf | 96 Rg |
| LED5-90 | 4889 | 85% | 94 | 84 | 0.002 | | 86 Rf | 95 Rg |



LM79 & TM30 DATA:

| | | MEASURED CCT | MEASURED LUMENS | CRI | R9 | LED27 | SPD | TM30 — COLOR VECTOR |
|--------------------|---------------------------------|--------------|-----------------|-----|----|--------|-----|---------------------|
| BH3S&D | bios 3000K | 2779 | 2758 | 87 | 81 | 0.003 | | |
| | BH3D SKY BLUE DIMMED | 2715 | 2425 | 82 | 3 | 0.002 | | |
| BH35S&D | bios 3500K | 3245 | 3488 | 85 | 87 | 0.003 | | |
| | BH35D SKY BLUE DIMMED | 3061 | 2502 | 83 | 7 | 0.001 | | |
| BH4&D | bios 4000K | 3624 | 2993 | 85 | 86 | 0.004 | | |
| | BH4D SKY BLUE DIMMED | 3388 | 2585 | 83 | 5 | 0.002 | | |
| TH | LED27 | 2684 | 4056 | 92 | 57 | 0.0001 | | |
| | LED65 | 6061 | 4052 | 82 | -1 | 0.006 | | |
| TH2 | LED22 | 2209 | 4012 | 92 | 52 | 0.0005 | | |
| | LED50 | 4796 | 4044 | 93 | 77 | 0.004 | | |
| CH | 2700K | 2632 | 4076 | 82 | 50 | 0.003 | | |
| | 3500K | 3388 | 4424 | 83 | 5 | 0.002 | | |
| | 4000K | 3977 | 4444 | 83 | 29 | 0.003 | | |
| | 5000K | 5233 | 4548 | 84 | 21 | 0.003 | | |



SENSORS

| | | | | |
|--|--|---|--|--|
|  |  |  |  |  |
| <p>205: Wattstopper</p> | <p>LVOC: Lutron Occupancy /Daylight Sensor</p> | <p>LVRF: Lutron Vive Control Node</p> | <p>NXSMP: Hubbell Occupancy /Daylight Sensor</p> | <p>ATHENA</p> |
| <p>Low voltage PIR fixture integrated occupancy sensor.</p> | <p>Measures light in the space (daylighting) while detecting people moving within an area using passive infrared to determine occupancy.</p> <p>Controls the lights to balance the light level in the space, combining convenience, exceptional energy savings, and ease of installation.</p> | <p>Provides wireless control of the fixture when neither occupancy nor daylight sensing is needed.</p> | <p>Hubbell Integrated/embedded networked lighting control, luminaire-level lighting control, LLLC.</p> <p>PIR motion sensor for automatic On/Off control.</p> <p>Integrated daylight sensor for daylight harvesting and/or lumen maintenance.</p> <p>Bluetooth radio provides wireless control of luminaire.</p> <p>Simple plug-in connection to NX Fixture Modules.</p> <p>Wireless Internet.</p> | <p>The Athena wireless node is a radio frequency (RF) device that enables simple, digital control of individual light fixtures in an Athena control system.</p> <p>The small size and compatibility with a wide variety of drivers allow for seamless integration with common commercial lighting fixtures from any manufacturer.</p> <p>Requires drivers with auxiliary power, consult factory for lead times</p> |
|  |  |  |  | |
| <p>NLT-AIR-rIO: Daylight+Occ</p> | <p>NLT-AIR-ADCX: Daylight+(PIR Acoustic) Occ</p> | <p>NLT-WIRED-nIO: Daylight+Occ</p> | <p>NLT-WIRED-ADCX: Daylight+(PIR Acoustic) Occ</p> | |
| <p>The rIO is a fixture embedded low voltage wireless nLight AIR device capable of individual fixture control and analog or digital dimming. This smart device results in the luminaire being “nLight AIR-enabled” — making it an addressable nLight AIR device. It uses a 900MHz radio to communicate with other nLight AIR devices, such as occupancy sensors, photocells, wall switches, powerpacks and other nLight AIR-enabled luminaires. This allows for advanced operation and design flexibility ranging from stand-alone rooms to building and campus-wide networks.</p> | <p>The nLight® AIR rES7 sensor is an in-fixture, low voltage, digital sensor providing embedded wireless lighting control, analog or digital dimming, occupancy detection and daylight harvesting capabilities.</p> <p>The rES7 is designed for mounting heights up to 20 ft in indoor luminaires. The rES7 sensor provides Passive Infrared (PIR) occupancy detection over a 15-20 ft (4.57 - 6.10 m) radial coverage pattern and photocell light level detection in one compact low profile design with optional Dual Technology, which adds Microphonics™ to PIR detection. The rES7 sensor is ideal for occupancy and daylighting control in suspended or recessed luminaires.</p> | <p>nLight digital nIO modules are low voltage control devices that enable digital control of LEDcode enabled eldoLED LED drivers. Through eldoLED's bi-directional 2-wire interface, these modules deliver natural, flicker-free high performance dimming while eliminating common issues related to 0-10 VDC alternatives. The modules also enable the eldoLED LED Drivers to be addressable, as well as capable of digitally communicating with other nLight controls such as occupancy sensors, photocells, and WallPods. This allows for advanced operation and design flexibility ranging from stand-alone rooms to building and campus-wide networks.</p> | <p>The nES7 is a small passive infrared occupancy sensor designed to be easily embedded into luminaires. This sensor provides excellent line of sight 360° PIR detection of small motion and walking motion. The nES7 is ideal for small rooms without obstructions or areas with primarily walking motion (e.g. corridors, library stacks). Additionally, an optional integrated photocell enables daylight harvesting control as well. Typically one or more nES7 sensors are paired with an nLight controller within an nLight enabled luminaire.</p> <p>For rooms like classrooms and private offices or any space with obstructions, the nES PDT 7 dual technology sensor is recommended.</p> | |