

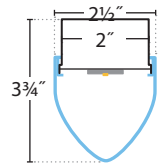

Type:

Job:



Sleek and streamlined with a touch of retro style.

Minimalist and Machine-Age inspired, this aerodynamic spin on our ever-popular Snap offers a subtle retro nod without being 'themey.'

It has a timeless appeal that spans everything from the Art Deco era through today's prevalent return of the mid-century modern aesthetic.

AERO-LED35-LO-SAL
2130 Delivered Lumens
18 Watts
120 lm/w

UP TO **120** LM/W

	LO	MO	SO
lm/ft	530	650	1000
w/ft	4.2	5.5	9

[CLICK HERE](#)



Lumen output may vary +/- 5% 3500K used for lm/ft estimates above 4000K +2% If, 3000K -2%, 2700K -4% -10% LLF for 90 CRI (4K, 3500K and 3K)

See LED Details PDF for more info

SE-RIES	LED COLOR	OUT-PUT	NOMINAL LENGTH	SHIELD-ING	COLOR/ FINISH	VOLT-AGE	MOUNT-ING	CEILING SYSTEMS	DRIVERS	OPTIONS & SENSORS	
AERO											
Snap-Aero	LED27 2700K (90CRI) LED3 3000K LED35 3500K LED4 4000K LED3-90 90CRI LED35-90 90CRI LED4-90 90CRI	LO Low MO Medium SO Standard PROG Programmable Light Output (Specify desired lm/ft or w/ft)	2' 3' 4' 6' 8' R____ (Row length in 1' increments) SML Sym-metric Row Length	SAL Satin Acrylic (WA Lens N/A)	TMW Textured Matte White YGW Gloss White (Standard) Y____ Premium Color CC Custom Color	UNV (120-277) 347 (Emergency battery requires a Step Down transformer)	SUR Surface or Wall Mount CA48", 96" or 144" Aircraft Cable (Adjustable)	X1 T-Bar 1 5/16" or 9/16" X3 Hard Ceiling X6 Slot Grid	ND Non-Dimming DM10 0-10v, 10% Dimming (Standard) DM01 0-10v, 1% Dimming STEP Step Dimming, 100-50-Off, Osram NOTE: Lumens and watts per foot may differ for STEP drivers, consult factory LDE5 5-Series EcoSystem LED LDE1 Hi-lume 1% EcoSystem LED (Soft fade on, fade-to-black dimming) LTE Hi-lume 1% 2-Wire LED Driver (120V forward phase only) * NA with HO ECO 1% 0-10v, EldoLED (Logarithmic dimming std) ECDA 1% DALI, EldoLED (Logarithmic dimming std) SOLO 0.1% 0-10v, EldoLED (Dim-to-dark, Logarithmic dimming std) SODA 0.1% DALI, EldoLED (Dim-to-dark, Logarithmic dimming std)	EML* Emergency Battery, Low (850 delivered lumens) EMH* Emergency Battery, High (1175 delivered lumens) *4' or longer (remote for < 4') EBCP1G Single Gang LED EBCP2G Dual Gang (Electrical Box Cover Plate/ Mud Ring) SENSORS: 205† WattStopper PIR Occupancy 205-ND: On/off 205-DM: Dim to 10% / 1% 205-STEP: Dim to 50% 505 WattStopper Ultrasonic Occupancy (SUR on wall mount only, N/A galvanized) 505-STEP: Dim to 50% 505-DM: Dim to 10%	TRS Tamper-Resistant Screws PRUBIN Meticulous Binning and Labeling every LED Board within a 2-Step MacAdams Ellipse LUX† Phillips DLH ENL† Enlighted 2-Wire DLH & Environmental † Adds 3' to fixture length



PHOTOMETRICS

Low Output:

AERO-LED35-LO-SAL

2130 Delivered Lumens

18 Watts

120 lm/w

Test

#103143275LAX-001

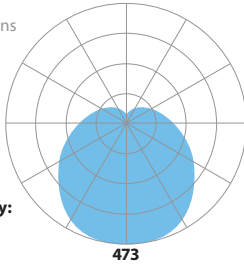

Zonal Lumen Summary:

0-90 (Down) = 84%

90-180 (Up) = 16%

Vertical Angle	0°	25°	45°	65°	90°
0°	472	472	472	472	472
5°	473	473	470	471	470
15°	477	473	461	451	446
25°	479	468	439	413	400
35°	469	451	406	360	338
45°	447	422	361	297	266
55°	408	383	314	232	192
65°	352	329	264	171	123
75°	290	271	214	126	65
85°	229	214	166	89	20
90°	201	188	145	73	3
95°	176	164	125	60	2
105°	133	123	91	37	3
115°	99	90	63	22	3
125°	70	62	41	14	3
135°	46	40	25	9	3
145°	27	23	15	7	4
155°	15	13	8	5	4
165°	8	6	5	5	4
175	3	3	4	4	0

LUMEN MAINTENANCE

Designed to last with cool running mid-power LEDs projected to maintain 90% (L90) of their initial output for 100,000 hours (at HO), and L70 exceeding 150,000 hours.

LED SYSTEM LED modules and drivers are field replaceable.

PROG (OPTIONAL) Programmable light output. Specify desired lumens or watts per linear foot. Min: 2.5 w/ft, consult factory for requests above 12 w/ft.

BINNING Standard binning (all Prudential LED boards) includes testing at the chip level and board integration to provide consistent color temperature within a 3-step MacAdams ellipse, with +/- 5% lumen output range and +/- .004 Duv.

PRUBIN* (OPTIONAL) Prudential Ltg's exclusive 'job binning' method that ensures color temperature consistency across all luminaires on a project. Meticulously testing and labeling **EVERY LED BOARD** to +/- 25 lumens, +/- 50k CCT and +/- .004 Duv — while also separating positive from negative — allows us to match color, hue and intensity throughout a project and provides a consistent color temperature within a 2-step MacAdams ellipse.

LABELS ETL damp labeled and I.B.E.W. manufactured.

ELECTRICAL Must specify LED dimming controls. LED fixtures have constant current driver(s) with less than 20% THD when loaded to a minimum of 60%. Drivers sink a maximum of 6mA per driver. DM10 LED drivers are 0-10V dimmable and are compatible with most 0-10V wall slide dimmers and direct 0-10V analog signal dimmers. Max driver size 1.65" w x 1.25" h.

CONSTRUCTION

Housing Die-formed 22-gauge steel, >20% PC recycled, 100% recyclable.

End Plates Spring-fastened aluminum, >25% PC recycled, 100% recyclable.

Lens Single-piece (up to 8' lengths) extruded acrylic, 100% recyclable.

Weight 2 lbs/ft.

MOUNTING Surface mounted to walls or ceilings or suspended by cable.

WARRANTY Single-source, 5 year limited warranty covers standard components and construction.





ADJOINING DETAIL

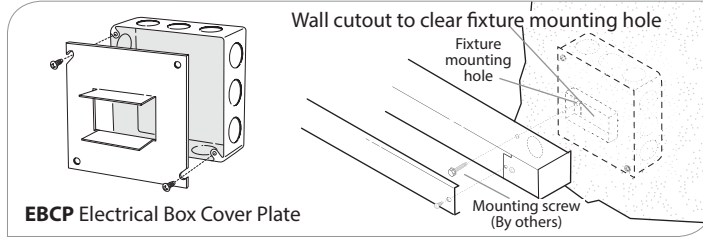
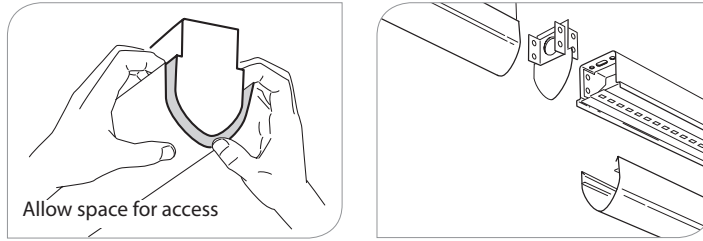

OPTIONAL ELECTRICAL BOX COVERS
7/8" Dia. K.O. will accommodate 2"x4" or 4"x4" J-Box

CONTROL SENSORS



505: WattStopper Ultrasonic Occupancy Sensor
NOTE: Small cut-out of lens around sensor, Surface mount on walls only



AERO SENSOR BOX: 205, LUX, 3E
NOTE: Adds 3" to length, 3E: enlightened control module required

Choose from one of our Premium Colors with no set-up fee.

For paint chip samples, please email: info@prulite.com

MOUNTING LOCATIONS

- ⊕ Cable mount
- Surface mount
- ⊕ 7/8" Dia. K.O.
- 1 1/16" K.O. / Stem & powerfeed

3" Sensor module added to fixture length for 205, LUX and 3E, end of run or between fixtures

