



INSTALLATION INSTRUCTIONS

X1 T-BAR & SURFACE

PRULITE.COM 213.746.0360

PARTS LIST

PARTS (SHIPPED SEPARATELY)

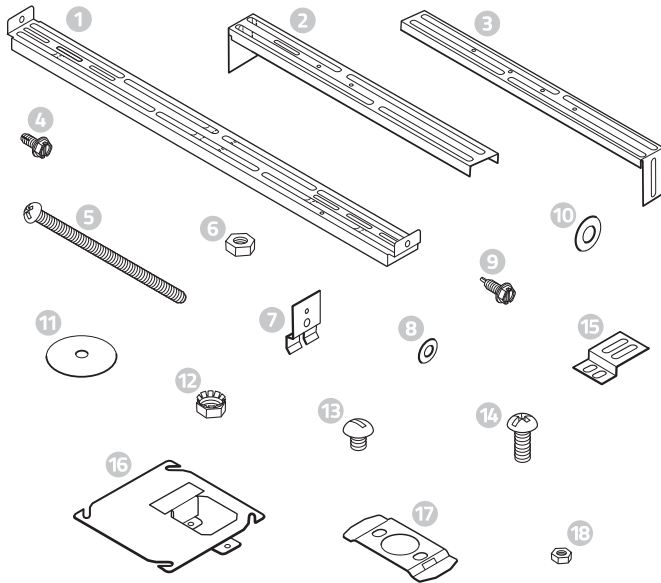

NO.	PART NO.	DESCRIPTION	
1	101959	T-Bar Surface Mount Main Rail	2
2	101961	T-Bar Surface Mount Track Rail	2
3	101960	T-Bar Surface Mount Extension Rail	2
4	100-00035-14	#8-32 x 1/2 Hex WR. HD. self Tap Screw Type F	18
5	100-00000-14	1/4-10 x 5" Round HD. Machine Screw	4
6	100-00012-14	1/4-20 Hex Nut	12
7	101977	T-Bar Surface Mount Clamp	4
8	91083A009	#8 x 7/16" O.D. Washer	4
9	94056A330	#8 x 1/2" Hex HD. Self Drill Tek Screw	4
10	100-00008-14	1/4" x 3/8" O.D. Washer	8
11	100-00126-14	1/4" x 1 1/4" O.D. Fender Washer	4
12	100-00255-14	1/4-20 Keps Hex Nut	3
13	100-00005-14	1/4-20 x 3/8" RD. HD. Machine Screw	1
14	100-00114-14	1/4-20 x 3/8" Truss HD. Machine Screw	2
15	104033	Offset Surface Plate J-Box Bracket	1
16	104032	Offset Surface Plaster Plate Assy.	1
17	101732	Surface Mount Ceiling Plate	4
18	100-00010-14	#8-32 Hex Machine Screw Nut	8

INSTALLATION

3' DIAMETER OLIVE:

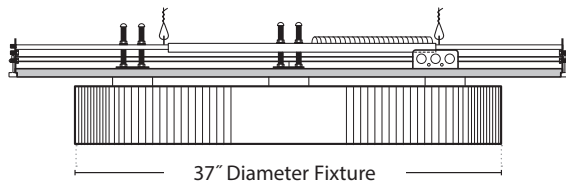

4' DIAMETER OLIVE:

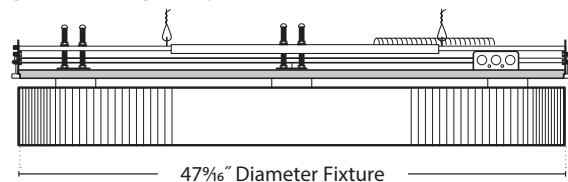

WARNING: Ground fixture in accordance with local and national electrical codes. Failure to do so may result in serious personal injury.





INSTALLATION INSTRUCTIONS

X1 T-BAR & SURFACE

PRULITE.COM 213.746.0360

GENERAL NOTES

1. 3' and 4' diameter fixtures require (2) surface mounting kits for t-bar installation.
One for power feed and a second for non power feed. (See exploded views and parts).
2. T-bar surface mounting bracket adjust from 24" min. to 60" max. Maximum t-bar mounting centers are 60".
Consult factory if t-bar centers exceed 60".
3. All t-bar configurations and ceiling shown on page 2 are based on 4', 48" t-bar centers.

FEED SURFACE MOUNT:

NON FEED SURFACE MOUNT:

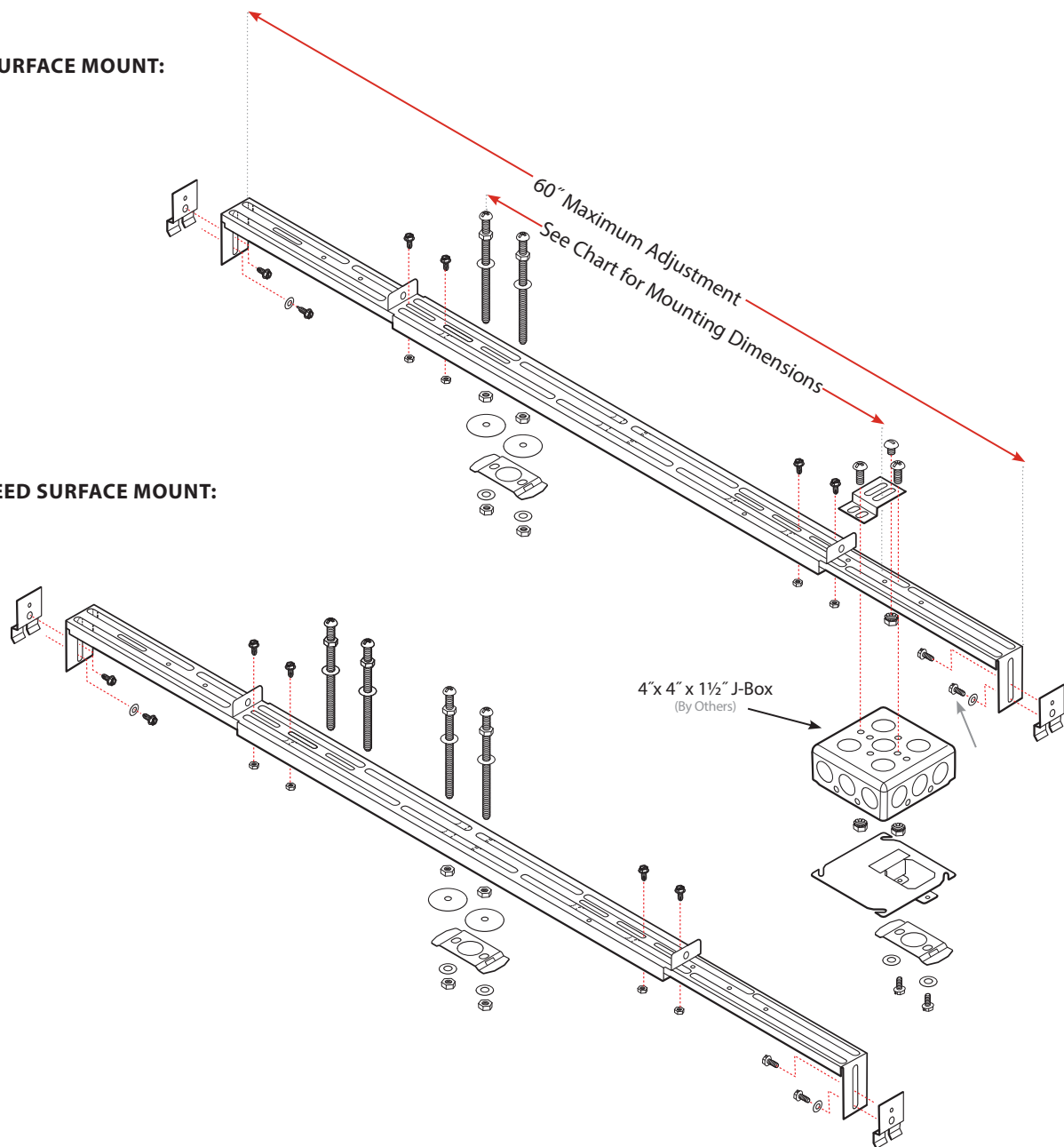

WARNING: Ground fixture in accordance with local and national electrical codes. Failure to do so may result in serious personal injury.





INSTALLATION INSTRUCTIONS

X1 T-BAR & SURFACE

PRULITE.COM 213.746.0360

3' DIAMETER OLIVE - D1, D9

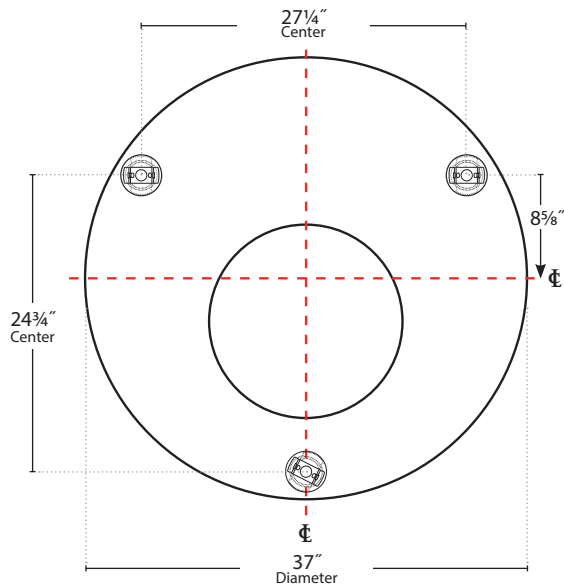

4' DIAMETER OLIVE - D1, D9

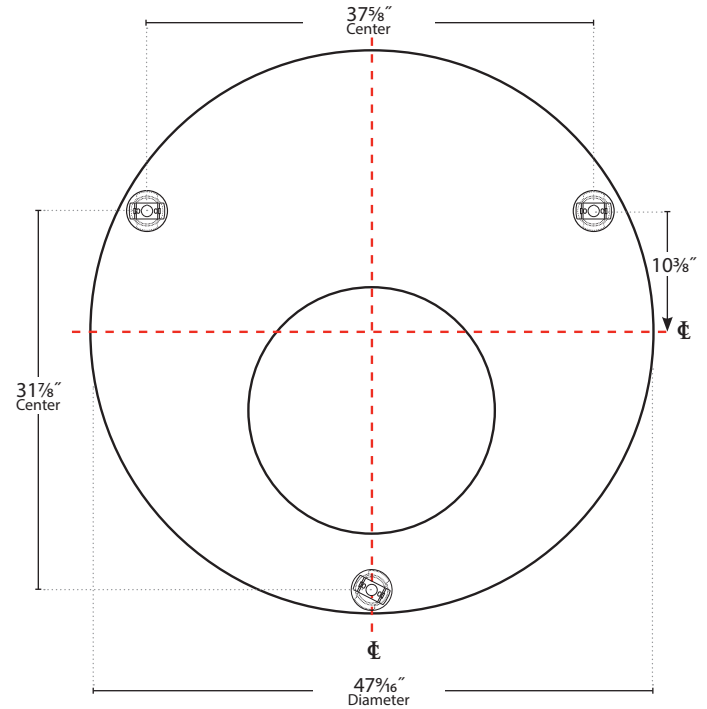

INLINE FEED AND SUPPORT CEILING PLATES

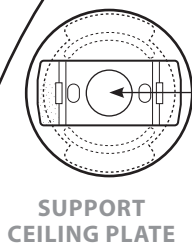

Dim. A
(Mounting Centers)

Feed and support
ceiling plate must be
collinear, 180° across.

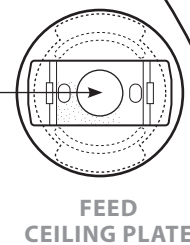

**FEED
CEILING PLATE**

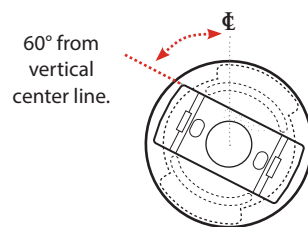

Non feed single ceiling plate
must be mounted at 60° from
vertical center line.

NON FEED SINGLE CEILING PLATE

WARNING: Ground fixture in accordance with local and national electrical codes. Failure to do so may result in serious personal injury.





INSTALLATION INSTRUCTIONS

PRULITE.COM 213.746.0360

X1 T-BAR & SURFACE

POWER FEED SECTION A-A

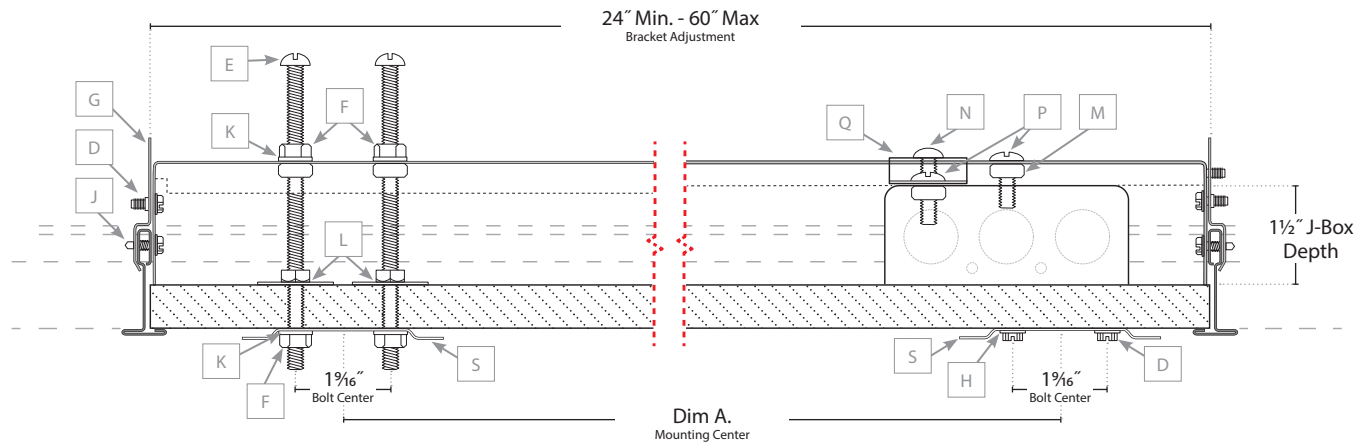

NON FEED SECTION B-B

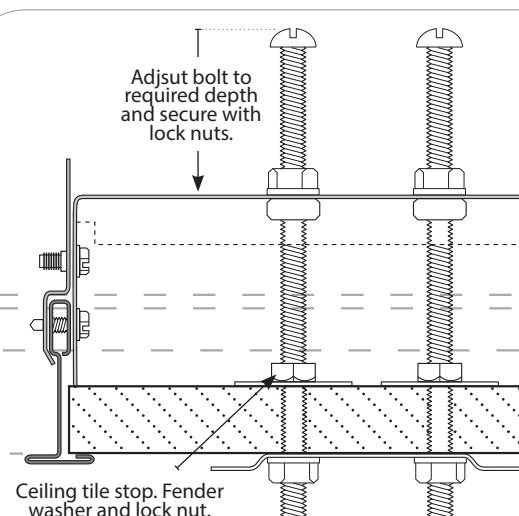
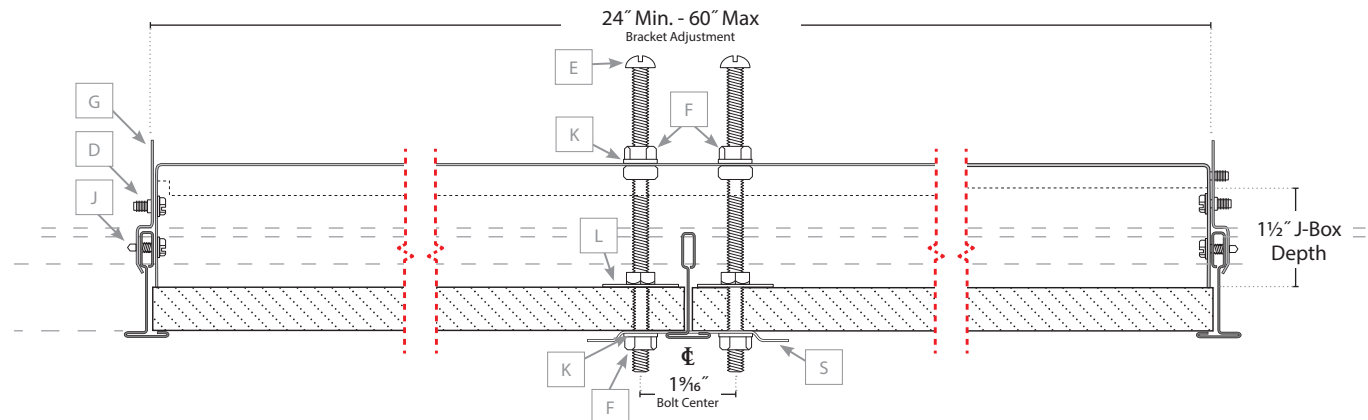

WARNING: Ground fixture in accordance with local and national electrical codes. Failure to do so may result in serious personal injury.





INSTALLATION INSTRUCTIONS

X1 T-BAR & SURFACE

PRULITE.COM 213.746.0360

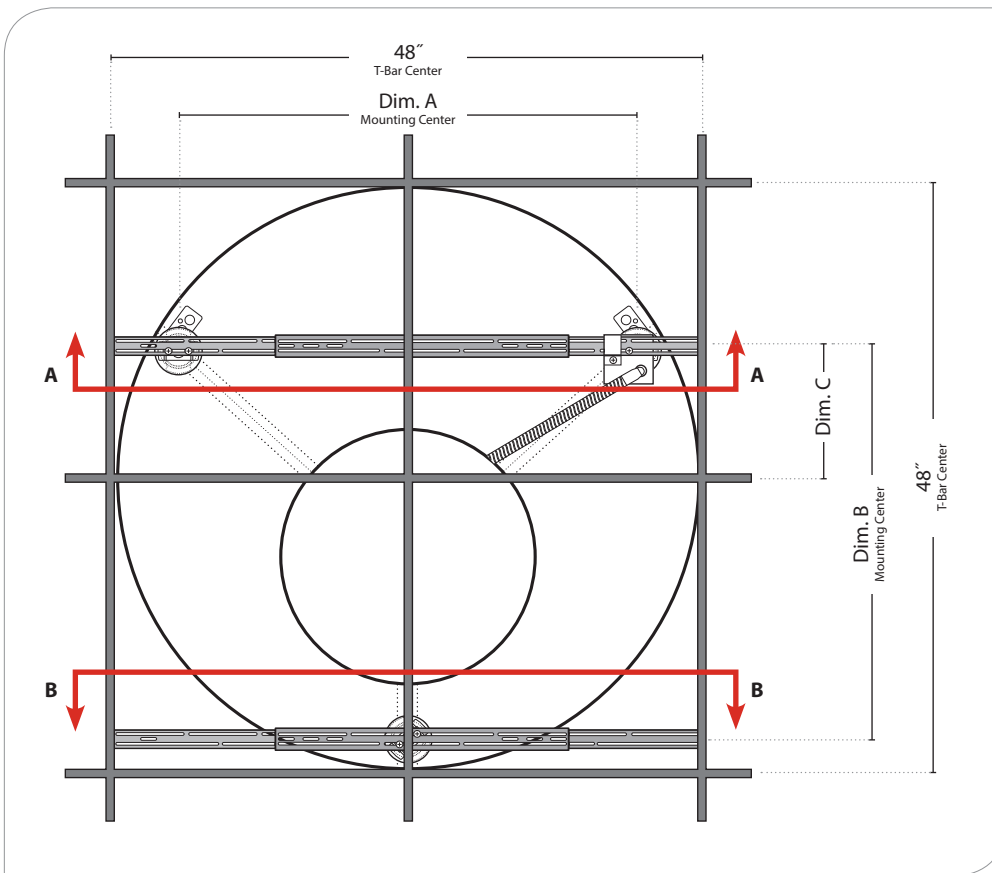

Fixture	Size	Dim. A	Dim. B	Dim. C
Olive	3' Diameter	27 $\frac{1}{4}$ "	31 $\frac{1}{8}$ "	8 $\frac{5}{8}$ "
	4' Diameter	37 $\frac{5}{8}$ "	24 $\frac{3}{8}$ "	10 $\frac{3}{8}$ "

WARNING: Ground fixture in accordance with local and national electrical codes. Failure to do so may result in serious personal injury.



INSTALLATION INSTRUCTIONS

X1 T-BAR & SURFACE

3' CEILING CONFIGURATION

2' x 4' GRID - 3' DIAMETER FIXTURE

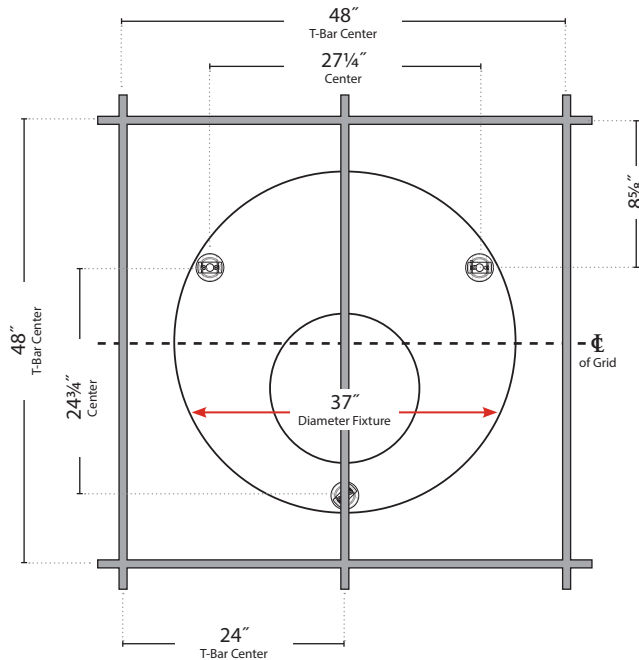

2' x 2' GRID - 3' DIAMETER FIXTURE

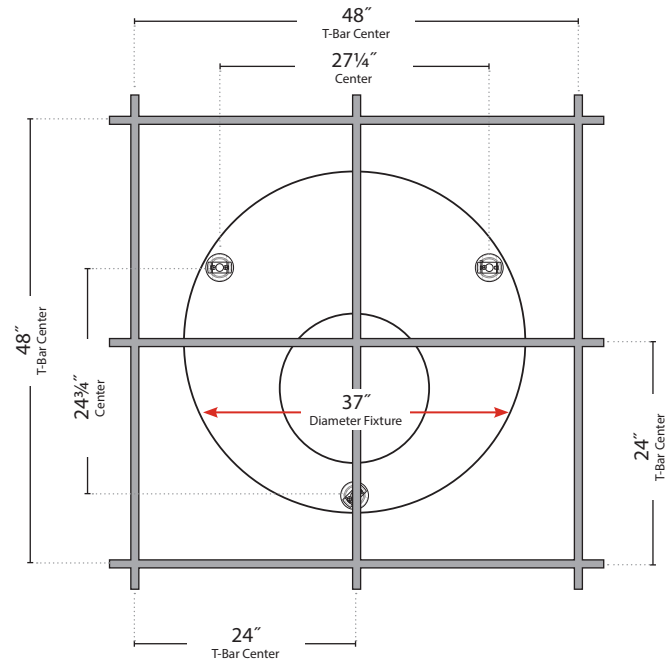

2' x 4' TILE PLAN VIEW

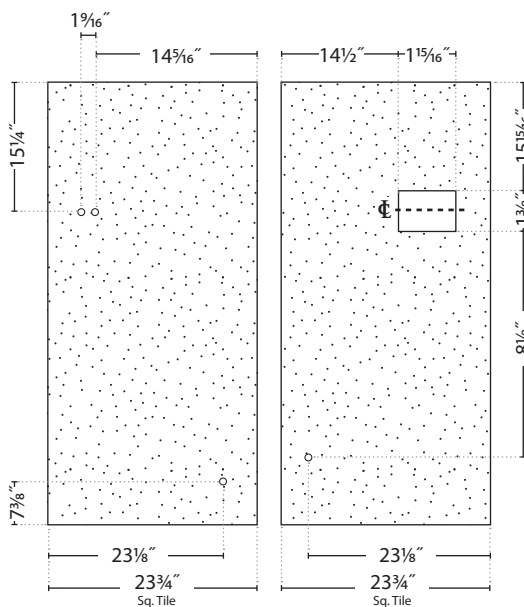

2' x 2' TILE PLAN VIEW

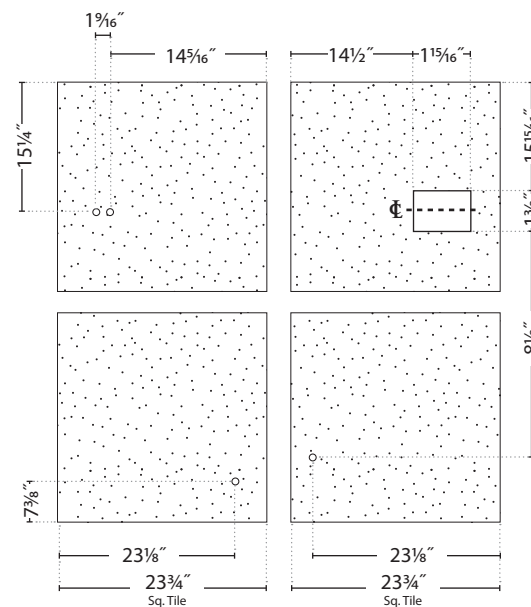

WARNING: Ground fixture in accordance with local and national electrical codes. Failure to do so may result in serious personal injury.



INSTALLATION INSTRUCTIONS

X1 T-BAR & SURFACE

PRULITE.COM 213.746.0360

4' CONFIGURATION

2' x 4' GRID - 4' DIAMETER FIXTURE

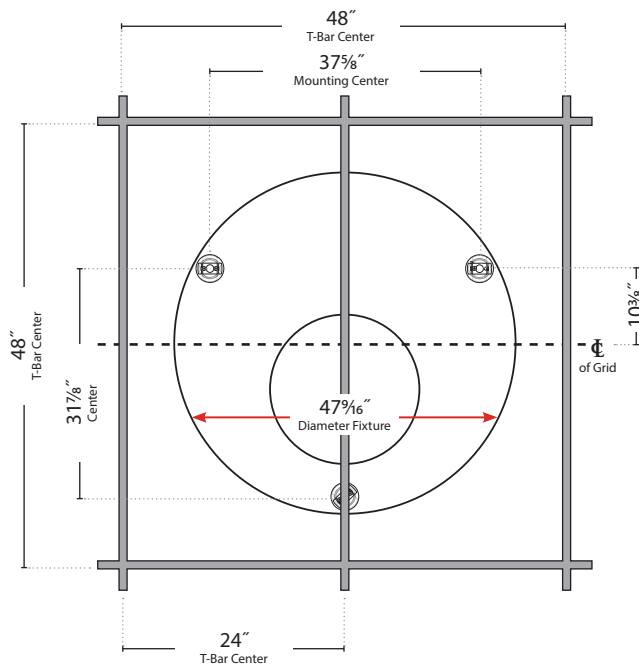

2' x 2' GRID - 4' DIAMETER FIXTURE

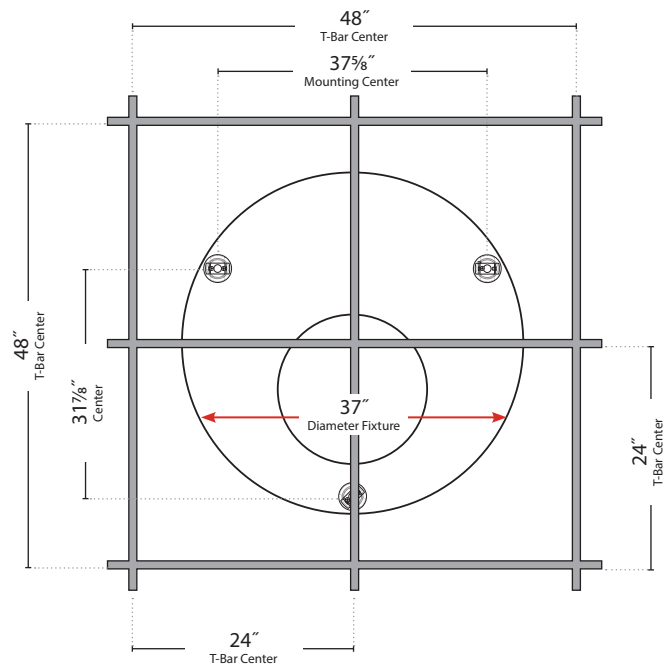

2' x 4' TILE PLAN VIEW

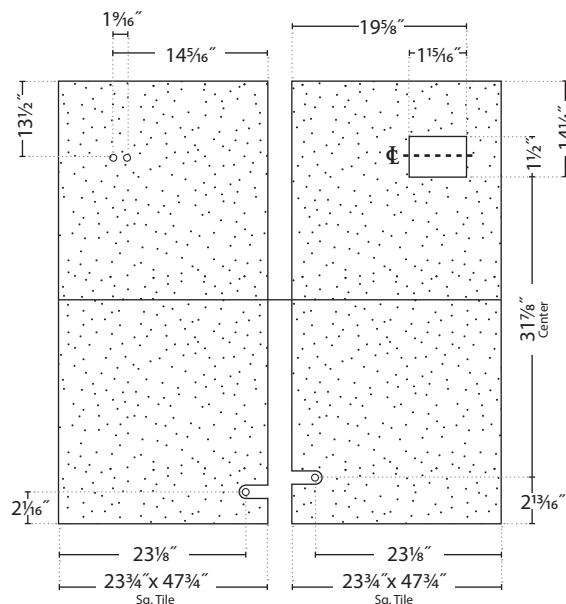

2' x 2' TILE PLAN VIEW

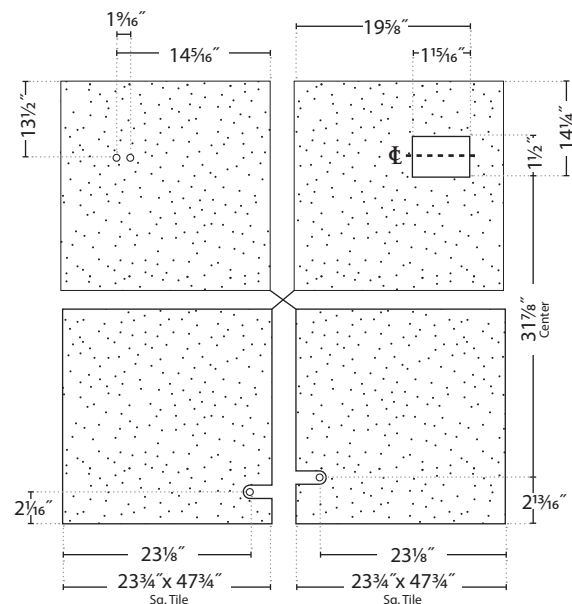

WARNING: Ground fixture in accordance with local and national electrical codes. Failure to do so may result in serious personal injury.





INSTALLATION INSTRUCTIONS

X1 T-BAR & SURFACE

PRULITE.COM 213.746.0360

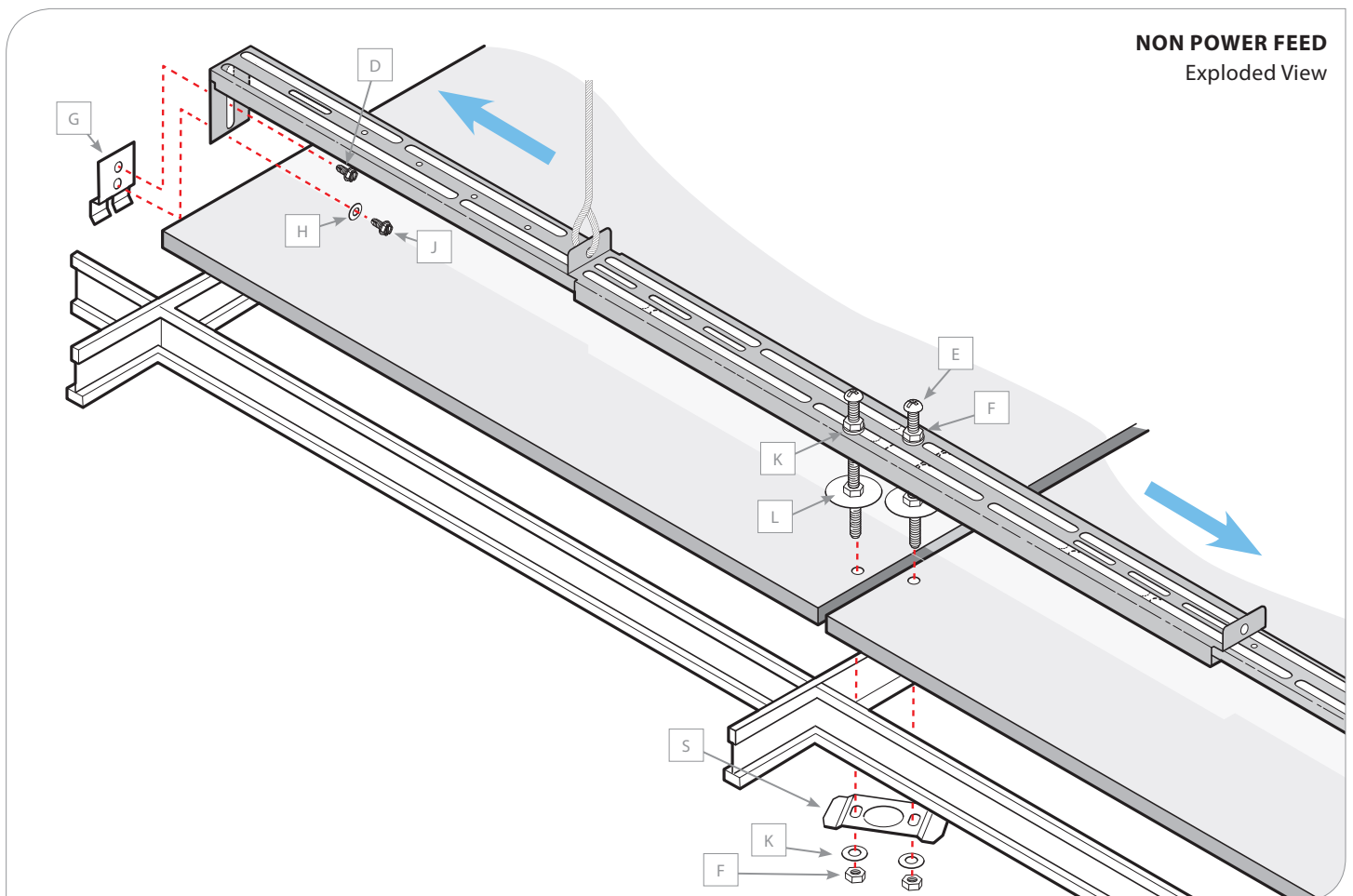
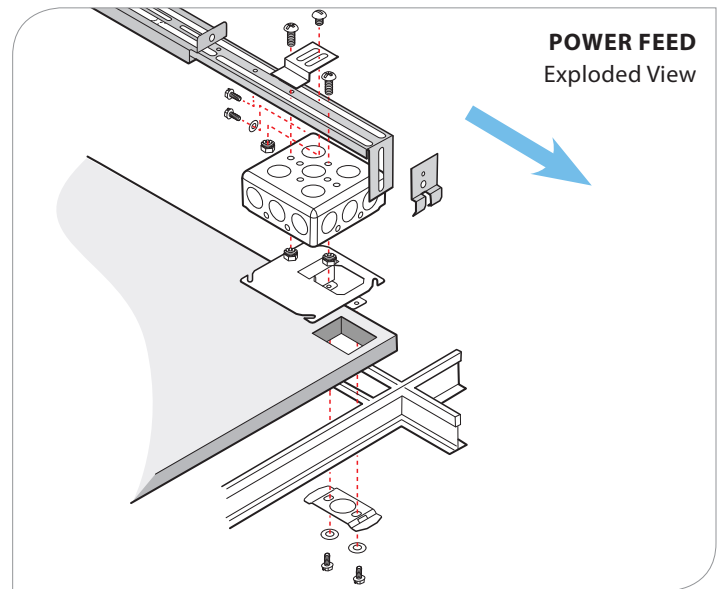
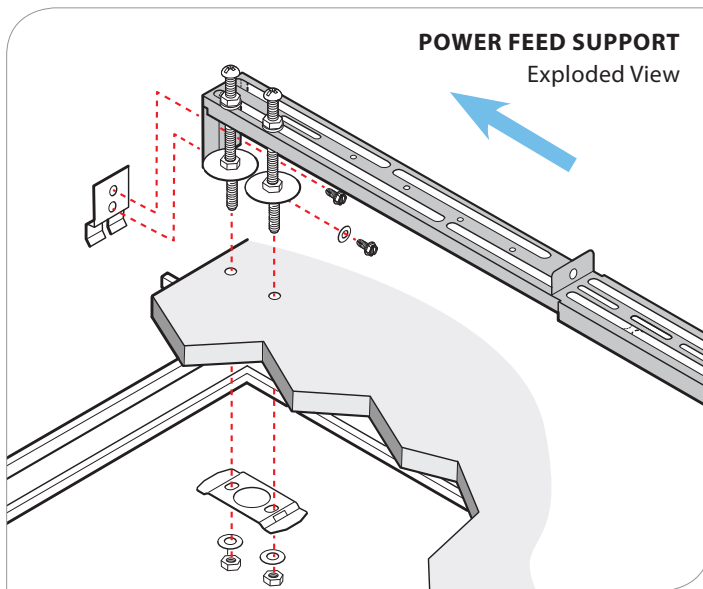

WARNING: Ground fixture in accordance with local and national electrical codes. Failure to do so may result in serious personal injury.





INSTALLATION INSTRUCTIONS

PRULITE.COM 213.746.0360

X1 T-BAR & SURFACE

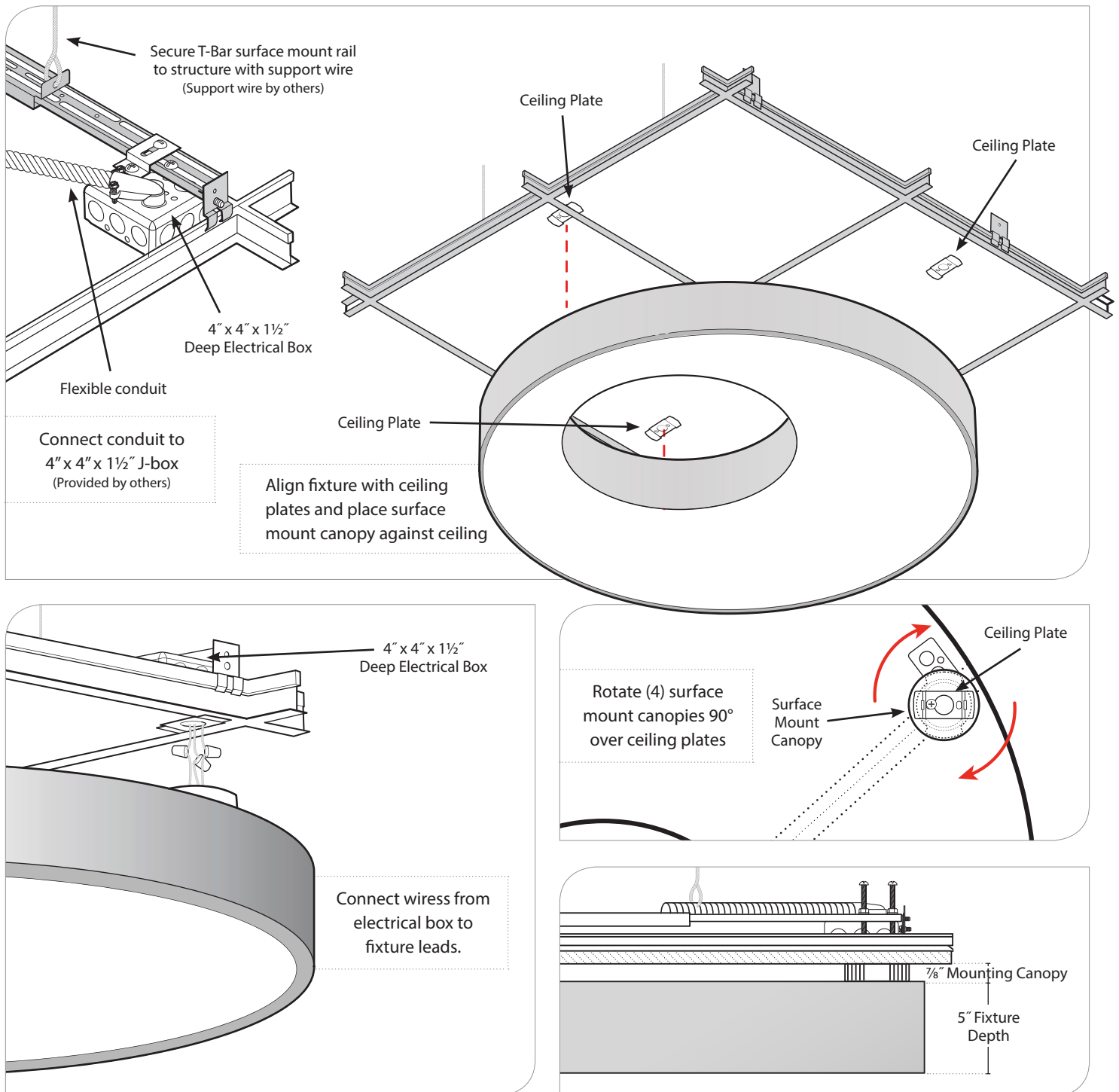

WARNING: Ground fixture in accordance with local and national electrical codes. Failure to do so may result in serious personal injury.

