

# P8900 SERIES HARD CEILING INSTALLATION INSTRUCTIONS

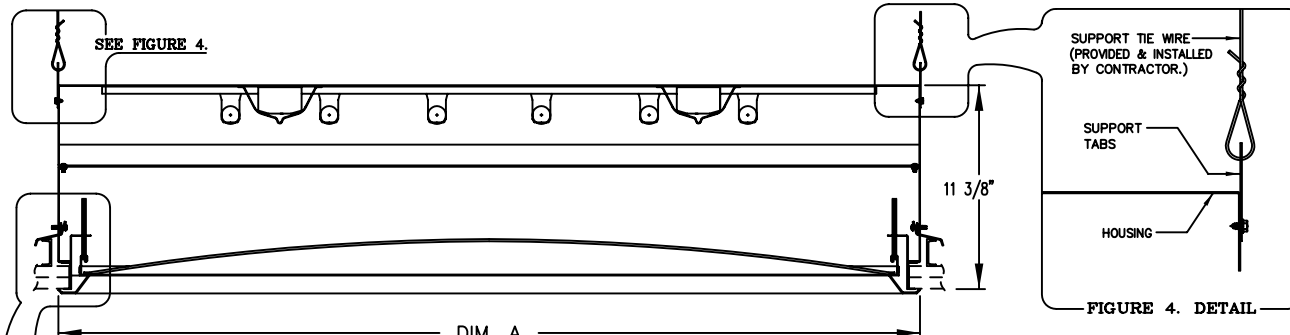
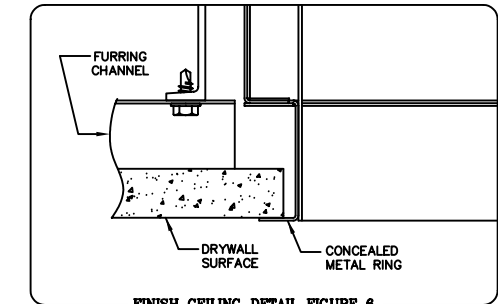
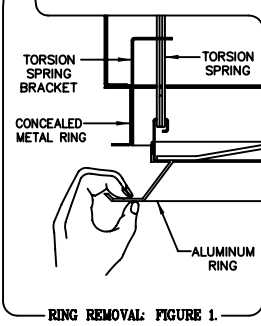

FIGURE 4. DETAIL



FINISH CEILING DETAIL FIGURE 6.



RING REMOVAL: FIGURE 1.

## FIXTURE CROSS SECTION

### GENERAL NOTES:

1. FIXTURE SHOULD BE INSTALLED PRIOR TO FINISH CEILING INSTALLATION.
2. INSTALL HOUSING AS LEVEL AS POSSIBLE BEFORE PROCEEDING TO DRY WALL OR GYPSUM BOARD INSTALLATION.
3. ALTHOUGH METAL STUD INSTALLATION IS FEASIBLE, IRON "C" CHANNEL INSTALLATION IS BETTER SUITED FOR FINAL LEVELING ADJUSTMENT. (SEE FIGURE 2 DETAIL.)

### ALUMINUM RING

REMOVE THE ALUMINUM RING FROM SQUARE HOUSING BY PULLING RING AWAY FROM HOUSING. WHEN RING STOPS AGAINST TORSION SPRING

BRACKET, RELEASE TORSION SPRING BY HAND PRESSING TOWARDS CENTER OF BRACKET. FRAME WILL DISENGAGE FROM BRACKET. (SEE FIGURE 1.)

### IRON "C" CHANNEL

1. SQUARE OPENING OF IRON "C" CHANNEL SHOULD BE 1" LARGER THAN O.A. SQUARE HOUSING DIMENSION. (SEE OPENING DETAIL FIGURE 2 CHART FOR VARIOUS "C" CHANNEL OPENINGS.)
2. RAISE SQUARE HOUSING UPWARD INTO ROUGHED IN OPENING. FROM HOUSING INTERIOR, INSERT CHANNEL CLAMP THROUGH FOUR LOWER HORIZONTAL SLOTS. CLAMP MUST SIT ON TOP OF "C" CHANNEL. DISTANCE BETWEEN BOTTOM OF "C" CHANNEL AND BOTTOM OF CONCEALED METAL RING SHOULD BE 1-1/2". TIGHTEN CHANNEL CLAMP IF FINAL LEVELING ADJUSTMENT IS REQUIRED. (SEE FIGURE 3 DETAIL.)

### METAL STUD MOUNTING

1. SQUARE OPENING OF METAL STUD FRAME SHOULD BE 3/8" LARGER THAN O.A. SQUARE HOUSING DIMENSION. (SEE OPENING DETAIL FIGURE 2 CHART FOR VARIOUS METAL STUD OPENINGS.)
2. RAISE SQUARE HOUSING UPWARD INTO ROUGHED IN OPENING. FROM HOUSING INTERIOR DRIVE TEK SCREWS THROUGH WALL OF HOUSING AND METAL STUDS. DISTANCE BETWEEN BOTTOM OF METAL STUD AND BOTTOM OF CONCEALED METAL RING SHOULD BE 1-1/2". (SEE FIGURE 5.)

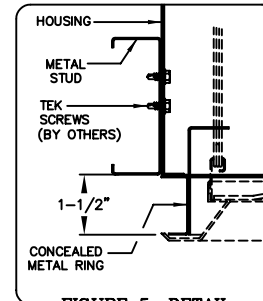
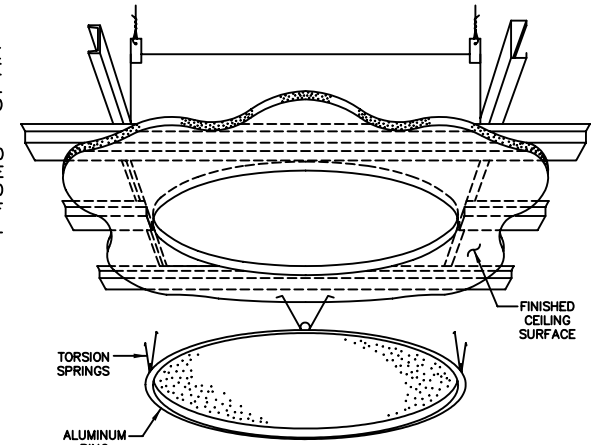

FIGURE 5. DETAIL



### ATTACHING ALUMINUM RING

1. REPLACE ALUMINUM RING TORSION SPRINGS INTO TORSION SPRING BRACKETS. PUSH ALUMINUM RING UPWARD TOWARDS FIXTURE. ALUMINUM RING SHOULD STOP AGAINST CEILING SURFACE. (SEE CEILING DETAIL FIGURE 7.)

3. FASTEN SUPPORT TABS ON EACH CORNER WITH #8 SHEET METAL SCREWS PROVIDED. TIE FIXTURE SUPPORT TABS TO STRUCTURAL MEMBER. (SEE FIGURE 4 DETAIL.)

### FINISH CEILING SURFACE

4. ATTACH FURRING CHANNEL OR OTHER SUITABLE MATERIAL TO IRON "C" CHANNEL OR METAL STUD. MOUNT DRY WALL OR GYP. BOARD SHEET TO FURRING CHANNEL. FINISH CEILING SURFACE SHOULD REST ON TOP OF CONCEALED METAL RING. (SEE FIGURE 6.)

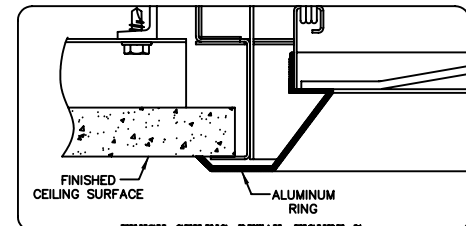

FINISH CEILING DETAIL FIGURE 7.

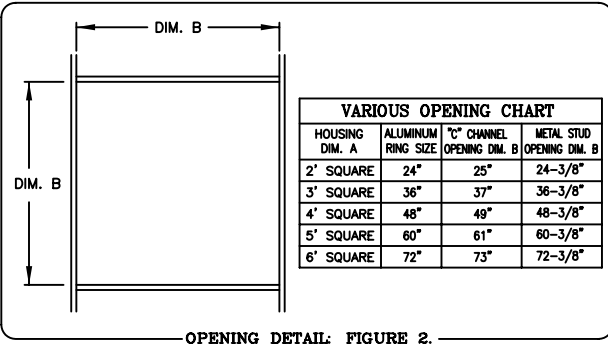

OPENING DETAIL: FIGURE 2.

### VARIOUS OPENING CHART

HOUSING DIM. A	ALUMINUM RING SIZE	"C" CHANNEL OPENING DIM. B	METAL STUD OPENING DIM. B
2" SQUARE	24"	25"	24-3/8"
3" SQUARE	36"	37"	36-3/8"
4" SQUARE	48"	49"	48-3/8"
5" SQUARE	60"	61"	60-3/8"
6" SQUARE	72"	73"	72-3/8"

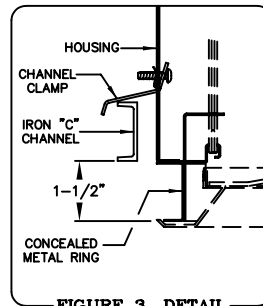

FIGURE 3. DETAIL



1774 EAST 21ST STREET L.A. CA 90058  
WWW.PRULITE.COM  
TEL. (213)746-0360 FAX (213)746-8838

DRAWN BY: SPH  
DATE: 8/14/2003  
CHK: DATE:

DWG. No. 42135

DISK No. ZD2  
REV. A