

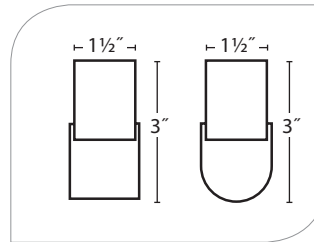

GENERAL INSTALLATION

1. See row diagram or prudential Lighting plan layout (if provided). Begin all row mounting from left to right (see arrows).
2. Depending upon ceiling construction structural support may be required at mounting hole locations.
3. For cable installation detail, see separate cable mounting instructions.



INDIVIDUAL: ROW DIRECTION: INSTALL FROM LEFT TO RIGHT

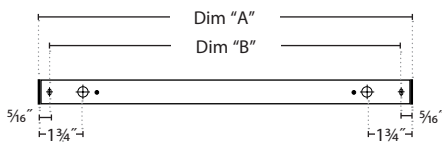

⊕ = 7/8" Diameter K.O.
♦ = 3/32" x 1/2" Slot

CABLE MOUNT DIMENSIONS

Dim "A"	Dim "B"	Dim "C"
22 7/8"	22 1/4"	22 7/8"
34 1/16"	34 1/16"	34 1/16"
46 1/2"	45 7/8"	46 1/2"
58 3/8"	57 3/4"	58 3/8"
69 3/8"	68 3/4"	69 3/8"
93"	92 3/8"	93"

ROW:

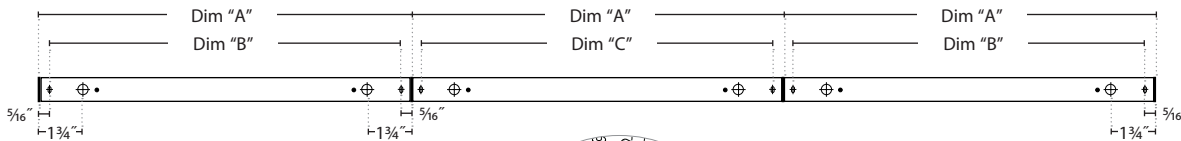

FIXTURE MOUNTING

1. Mount all support hardware to ceiling at required locations (see general installation).
2. Install cables to each end of fixture (Figure 1). Lift fixture and attach cables to installed hardware on the ceiling. Attach power feed cord to fixture and wire accordingly. Install finish plate on each end of fixture (see finish plate detail).

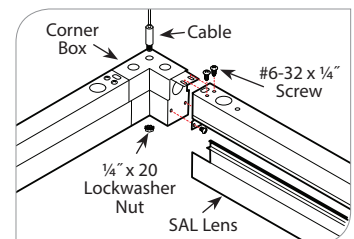
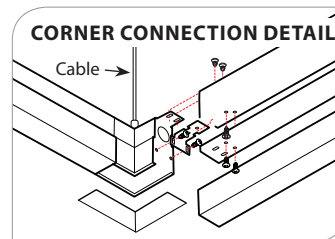
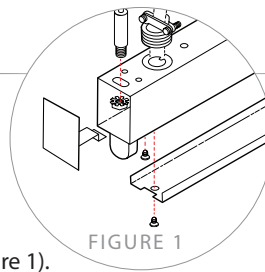

CONTINUOUS ROWS

1. Mount all support hardware to ceiling at required locations.
2. Install cables on each end of first fixture. Install aligner on joining end of first fixture. Lift fixture and attach cables to installed hardware in the ceiling. Attach power feed cord and wire accordingly.
3. Install cable and joiner on right end of each adjoining fixture. No joiner will be added to last adjoining fixture in the row. Attach each fixture to row separately (Figure 2). Plug internal circuit assembly quick connect to quick connect in previous fixture for continuous power.
4. Install top coupler plate at each fixture joint (see top coupler detail). Install finish plate at each end of row (see finish plate detail).

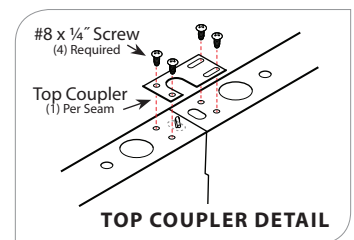
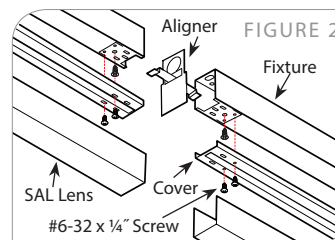
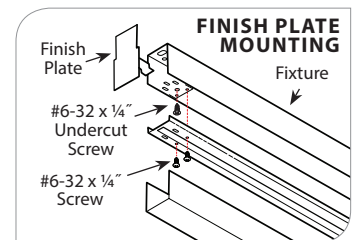
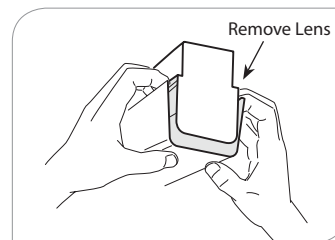

WARNING: Ground fixture in according with local and national electrical codes. Failure to do so may result in serious personal injury.