

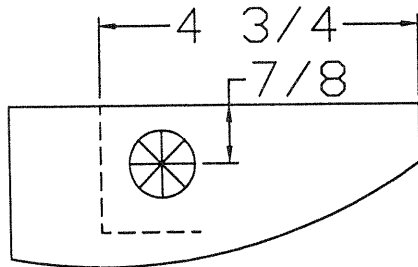

PRUDENTIAL DIRECT/INDIRECT WALL MOUNT LUMINAIRE, CAT# WAL-WAVE-D-1T8-04-TMW-120
WITH WHITE INTERIOR AND NO LENS

ONE PHILIPS 32 WATT T8 LAMP, CAT# F32T8/TL841. LUMEN RATING = 3000 LMS.
ONE SYLVANIA QT1X32/120 IS-SC BALLAST OPERATING AT 120 VAC AND 30 WATTS

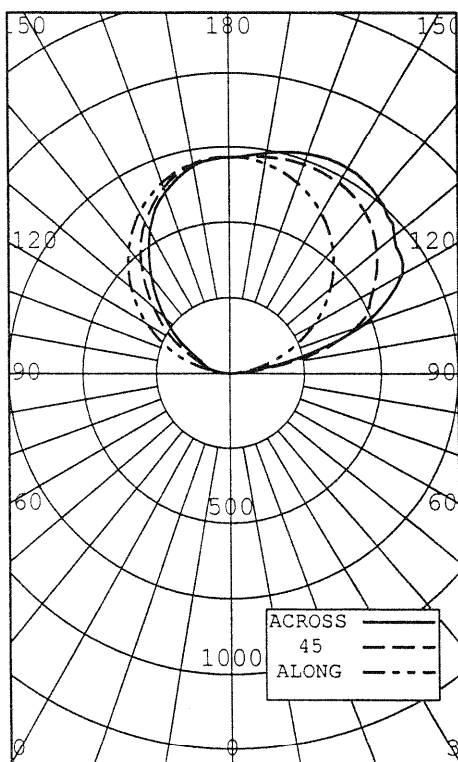

CANDLEPOWER SUMMARY

BEAM SIDE

OUTPUT

LUMENS

ANGLE	ALONG	22.5	45	67.5	ACROSS	
180	716	716	716	716	716	
175	715	717	721	725	724	35
170	706	714	728	738	742	
165	691	709	734	753	760	103
160	671	700	737	766	774	
155	645	686	735	774	784	168
150	614	669	729	777	786	
145	577	653	716	773	779	220
140	536	620	696	757	762	
135	490	588	669	735	736	251
130	439	551	634	706	710	
125	385	512	593	669	687	259
120	327	465	544	645	659	
115	265	411	507	596	571	237
110	201	351	442	495	472	
105	139	282	341	366	312	159
100	78	243	190	247	153	
95	28	103	55	70	46	43
90	0	0	0	0	0	

BOTH SIDES

ZONAL LUMENS AND PERCENTAGES

ZONE	LUMENS	% LAMP	% LUMINAIRE
180-150	577	19.24	24.81
180-140	958	31.95	41.20
180-120	1748	58.28	75.16
180-90	2326	77.54	100.00
140-90	1367	45.60	58.80
120-90	577	19.26	24.84
0-90	0	.00	.00
0-180	2326	77.54	100.00

** EFFICIENCY: 77.5% **

PAINT REFLECTANCE: .83

CERTIFIED BY:

Jan Lewin

DATE:
MAR 19, 2002

PREPARED FOR:

PRUDENTIAL LIGHTING CORP.
LOS ANGELES, CA

TESTED IN ACCORDANCE WITH IES PROCEDURES.

Lighting Sciences
7830 E. Evans Rd.
Scottsdale, AZ, USA 85260

CERTIFIED TEST REPORT No. LSI

16348

PRUDENTIAL DIRECT/INDIRECT WALL MOUNT LUMINAIRE, CAT# WAL-WAVE-D-1T8-04-TMW-120
WITH WHITE INTERIOR AND NO LENS
ONE PHILIPS 32 WATT T8 LAMP, CAT# F32T8/TL841. LUMEN RATING = 3000 LMS.
ONE SYLVANIA QT1X32/120 IS-SC BALLAST OPERATING AT 120 VAC AND 30 WATTS

BEAM SIDE
CANDLEPOWER DATA
IN 2.5 DEGREE STEPS

ANGLE	PLANE						OUTPUT
	ALONG	22.5	45	67.5	ACROSS	AVERAGE	LUMENS
180.0	716	716	716	716	716	716	
177.5	717	716	718	720	718	718	
175.0	715	717	721	725	724	721	35
172.5	711	716	724	731	733	723	
170.0	706	714	728	738	742	726	
167.5	699	713	731	742	751	728	
165.0	691	709	734	753	760	730	103
162.5	682	705	736	760	768	731	
160.0	671	700	737	766	774	731	
157.5	659	693	737	771	780	730	
155.0	645	686	735	774	784	728	168
152.5	630	678	733	777	786	724	
150.0	614	669	729	777	786	719	
147.5	596	659	723	775	783	712	
145.0	577	653	716	773	779	705	220
142.5	557	634	707	765	772	693	
140.0	536	620	696	757	762	681	
137.5	514	605	684	747	753	667	
135.0	490	588	669	735	736	651	251
132.5	465	570	652	722	732	636	
130.0	439	551	634	706	710	616	
127.5	413	532	615	689	693	597	
125.0	385	512	593	669	687	578	259
122.5	357	502	569	661	678	562	
120.0	327	465	544	645	659	537	
117.5	297	439	522	630	619	512	
115.0	265	411	507	596	571	483	237
112.5	233	381	484	547	526	448	
110.0	201	351	442	495	472	406	
107.5	170	318	390	443	392	358	
105.0	139	282	341	366	312	303	159
102.5	108	257	268	286	228	245	
100.0	78	243	190	247	153	199	
97.5	50	165	115	130	85	119	
95.0	28	103	55	70	46	66	43
92.5	24	45	18	34	15	29	
90.0	0	0	0	0	0	0	

Lighting Sciences
7830 E. Evans Rd.
Scottsdale, AZ, USA 85260

CERTIFIED TEST REPORT No. LSI

16348

PRUDENTIAL DIRECT/INDIRECT WALL MOUNT LUMINAIRE, CAT# WAL-WAVE-D-1T8-04-TMW-120
WITH WHITE INTERIOR AND NO LENS
ONE PHILIPS 32 WATT T8 LAMP, CAT# F32T8/TL841. LUMEN RATING = 3000 LMS.
ONE SYLVANIA QT1X32/120 IS-SC BALLAST OPERATING AT 120 VAC AND 30 WATTS

OPPOSITE SIDE TO BEAM
CANDLEPOWER DATA
IN 2.5 DEGREE STEPS

ANGLE	PLANE						OUTPUT LUMENS
	ALONG	22.5	45	67.5	ACROSS	AVERAGE	
180.0	716	716	716	716	716	716	
177.5	717	715	716	717	714	716	
175.0	715	712	714	714	711	713	34
172.5	711	708	710	707	706	708	
170.0	706	698	704	690	697	698	
167.5	699	695	695	684	684	691	
165.0	691	685	682	668	669	679	95
162.5	682	674	668	651	653	665	
160.0	671	660	653	633	636	650	
157.5	659	645	635	615	619	634	
155.0	645	628	617	595	599	615	141
152.5	630	609	597	568	572	594	
150.0	614	589	577	539	543	571	
147.5	596	554	556	491	513	539	
145.0	577	542	529	477	480	519	161
142.5	557	518	499	443	448	491	
140.0	536	491	469	412	415	462	
137.5	514	457	438	379	384	431	
135.0	490	445	405	347	352	405	155
132.5	465	415	374	315	320	374	
130.0	439	384	341	283	288	343	
127.5	413	353	308	253	258	312	
125.0	385	304	277	210	229	274	125
122.5	357	289	246	196	200	252	
120.0	327	256	216	167	172	222	
117.5	297	222	185	141	145	192	
115.0	265	190	158	116	122	164	82
112.5	233	159	131	100	105	140	
110.0	201	127	107	90	97	118	
107.5	170	101	88	82	88	100	
105.0	139	77	76	73	80	84	44
102.5	108	48	67	56	70	65	
100.0	78	43	54	49	58	54	
97.5	50	34	47	31	43	39	
95.0	28	21	28	12	24	22	13
92.5	24	3	9	1	6	7	
90.0	0	0	0	0	0	0	

Lighting Sciences
7830 E. Evans Rd.
Scottsdale, AZ, USA 85260

CERTIFIED TEST REPORT No. LSI

16348

PRUDENTIAL DIRECT/INDIRECT WALL MOUNT LUMINAIRE, CAT# WAL-WAVE-D-1T8-04-TMW-120
WITH WHITE INTERIOR AND NO LENS
ONE PHILIPS 32 WATT T8 LAMP, CAT# F32T8/TL841. LUMEN RATING = 3000 LMS.
ONE SYLVANIA QT1X32/120 IS-SC BALLAST OPERATING AT 120 VAC AND 30 WATTS

COEFFICIENTS OF UTILIZATION

ZONAL CAVITY METHOD

EFFECTIVE FLOOR CAVITY REFLECTANCE = .20

CC WALL	80				70				50				30				10				0
	70	50	30	10	70	50	30	10	50	30	10	50	30	10	50	30	10	50	30	10	0
RCR																					
0	.74	.74	.74	.74	.63	.63	.63	.63	.43	.43	.43	.25	.25	.25	.08	.08	.08	.00			
1	.67	.64	.61	.59	.57	.55	.53	.50	.38	.36	.35	.22	.21	.20	.07	.07	.07	.00			
2	.61	.56	.51	.48	.52	.48	.44	.41	.33	.31	.29	.19	.18	.17	.06	.06	.06	.00			
3	.56	.49	.44	.40	.47	.42	.38	.35	.29	.26	.24	.17	.16	.14	.05	.05	.05	.00			
4	.51	.43	.38	.33	.43	.37	.32	.29	.25	.23	.20	.15	.13	.12	.05	.04	.04	.00			
5	.46	.37	.32	.28	.39	.33	.28	.25	.23	.20	.17	.13	.11	.10	.04	.04	.03	.00			
6	.42	.34	.28	.24	.36	.29	.24	.21	.20	.17	.15	.12	.10	.09	.04	.03	.03	.00			
7	.39	.30	.25	.21	.33	.26	.21	.18	.18	.15	.13	.10	.09	.08	.03	.03	.03	.00			
8	.36	.27	.22	.18	.31	.23	.19	.16	.16	.13	.11	.10	.08	.07	.03	.03	.02	.00			
9	.33	.25	.19	.16	.28	.21	.17	.14	.15	.12	.10	.09	.07	.06	.03	.02	.02	.00			
10	.31	.22	.17	.14	.26	.19	.15	.12	.13	.11	.09	.08	.06	.05	.03	.02	.02	.00			

LUMINAIRE INPUT WATTS = 30.0

LABORATORY RESULTS MAY NOT BE REPRESENTATIVE OF FIELD PERFORMANCE.

BALLAST AND FIELD FACTORS HAVE NOT BEEN APPLIED.