

# illusory

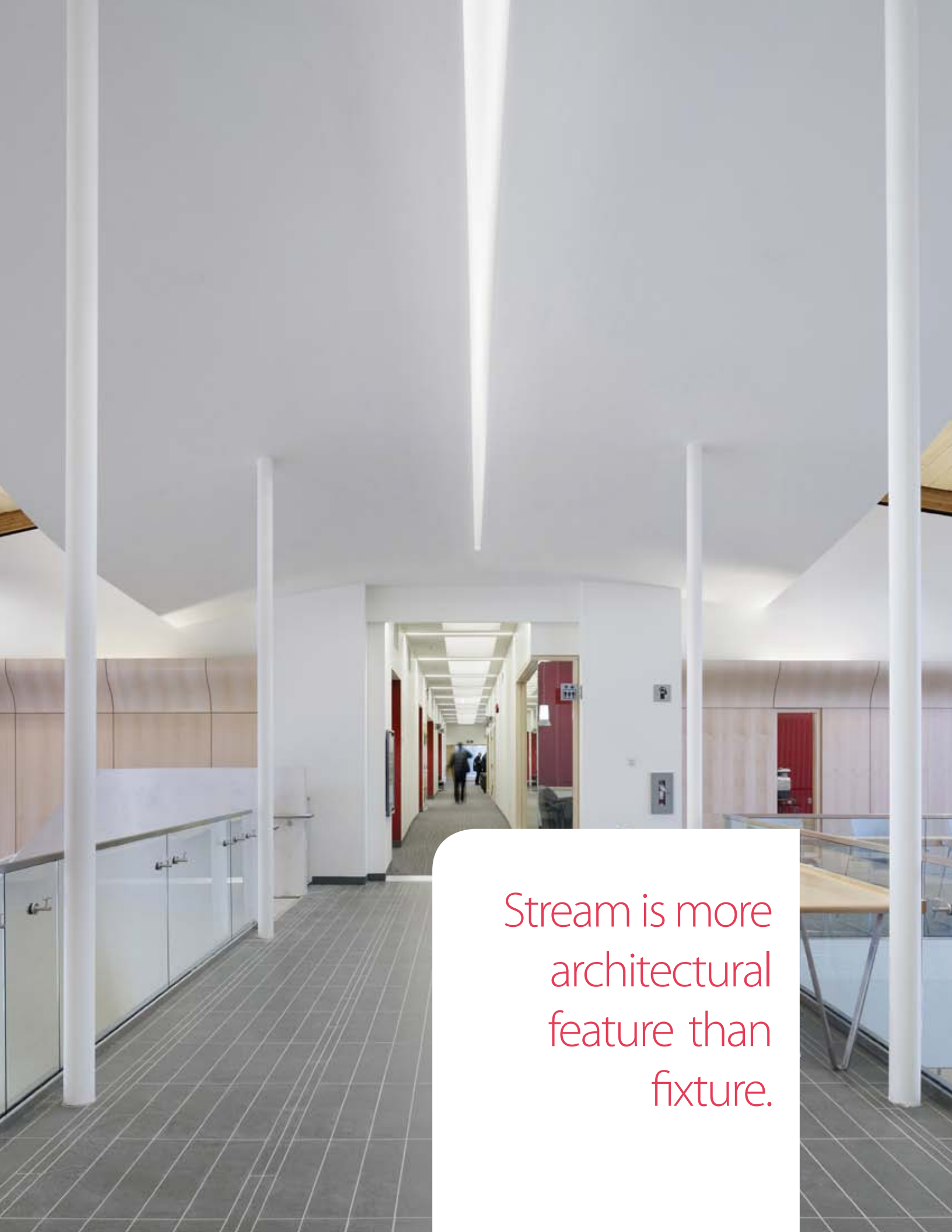

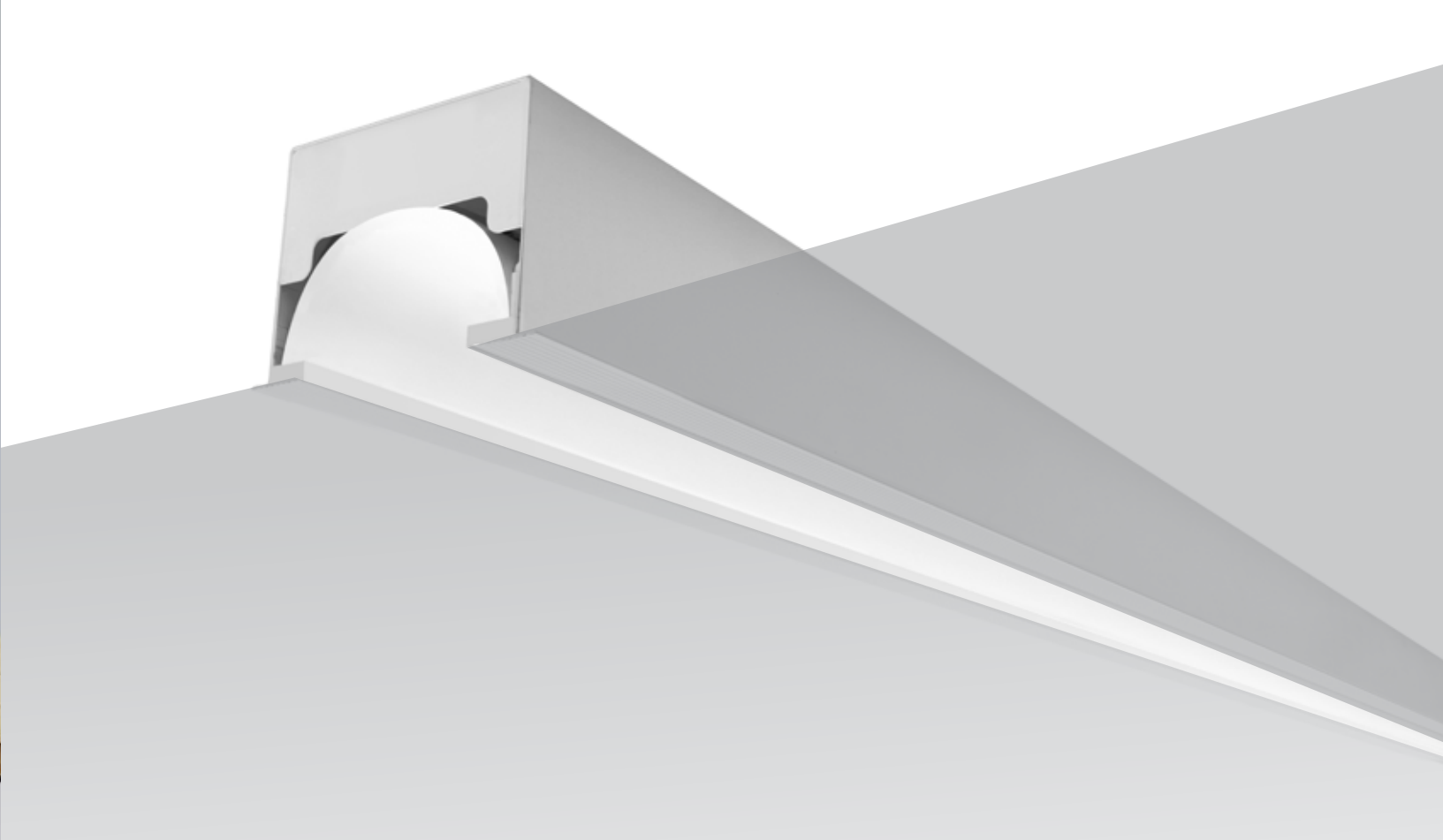

Stream is more  
architectural  
feature than  
fixture.



**INTRODUCING STREAM. REDUCTIONISM AT ITS BEST.**

**A paradigm-shifter for architectural recessed linear.**

Nuanced and understated in its presentation. Undeniably powerful in its impact. That's Stream, a mind-bending illumination breakthrough that plays with depth perception, creating an uninterrupted line of light that extends as far as the blueprint dictates. Its "barely there" presence radiates wondrously uniform light that seems to emanate from nowhere.

It's a slot lighting game-changer. And it's from Prudential Ltg., established and respected industry partner and innovator for 60 years.



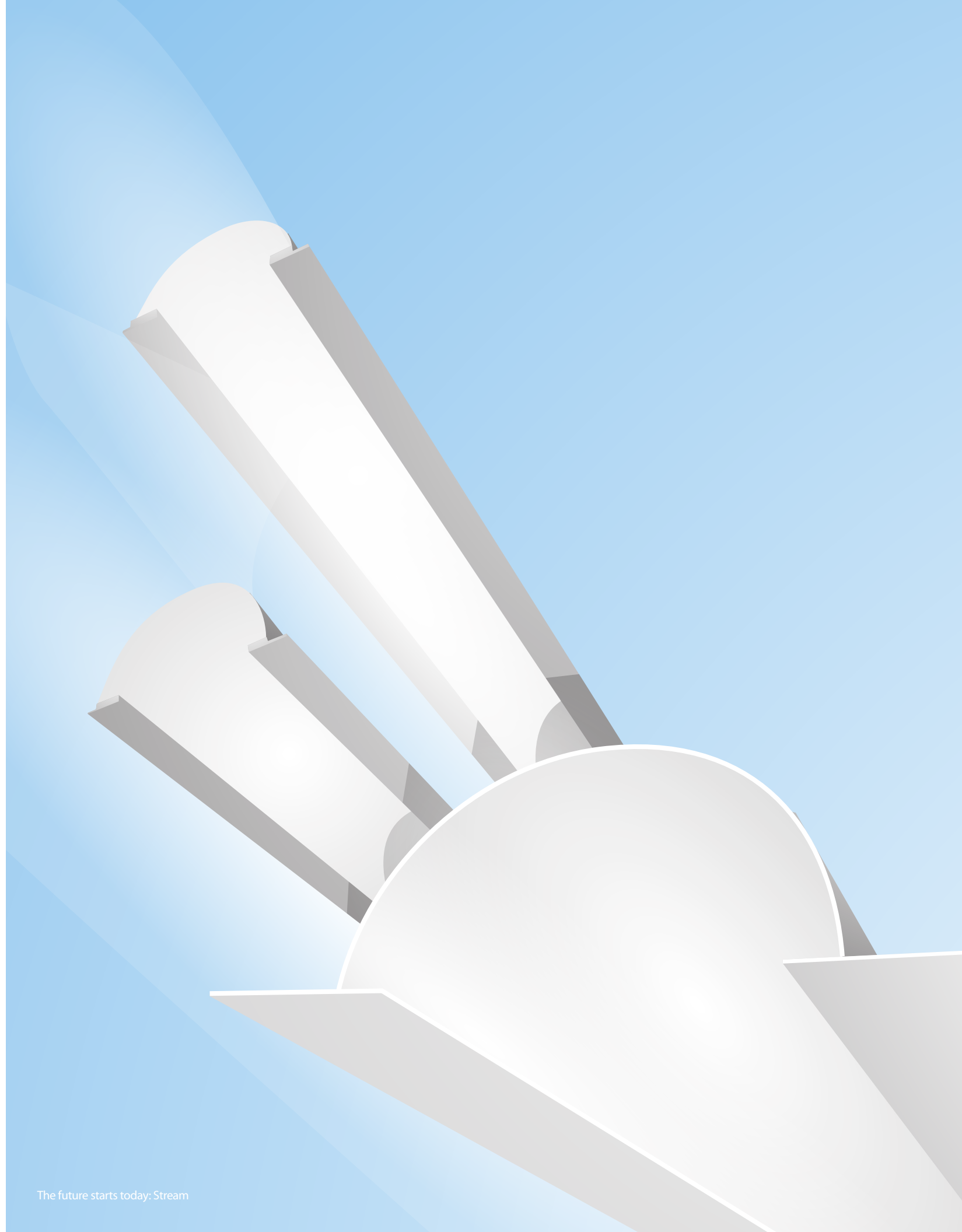

# No lens, no seams, no fixture.

Just light. Glorious, glowing, radiant light.

**Astoundingly simple concept. Intriguing industry firsts.**

Stream creates an evenly-illuminated alcove, free of unnecessary or cumbersome parts and pieces.

**No lens.** An impressive industry first for slot lighting. Patent-pending, lens-free, indirect high efficacy (90+ lm/w) LED illumination.

**No seams.** That's right. Another industry first. A flexible reflector ships on a roll (up to 200') and installs in three easy steps.

**Completely fixture-free.** Sleek and minimalist with its trimless mud-over flange and no lens or seams, Stream recedes into its environment, so you see nothing but light.

**FEATURES:**

- 0-10V dimming in 10% and 1% ranges
- 3 output levels (540, 765, 1000 lm/ft)
- Optional tunable output levels (specify lm/ft or w/ft)
- 3000K, 3500K, 4000K
- Calculated life of LEDs = L90 @100,000 hours
- Single-source, 5 year limited warranty covers all components and construction





## Lighting designed to be experienced.

Felt, rather than seen.

Try as they might, words and images cannot fully capture the Stream illumination effect.

Like light-driven contemporary installation art, it has a presence that has to be physically experienced to fully comprehend. Inherent in its design is a sense of mystique. It engages and invites. Inspires and delights.







## Experience Stream today.

For a sample, please contact your  
local agent or e-mail :

[info@prulite.com](mailto:info@prulite.com)

Wondering if Stream will work for your  
application? Just ask. As shown here,  
Stream is well-suited for most T-bar or hard  
ceiling recessed linear applications.

Pictured, Stream with LED P4030s, powder-  
coated Dusk Blue for a splash of color and  
LED Snaps to create incredibly efficient  
open office linear pendants at 116 lm/w.



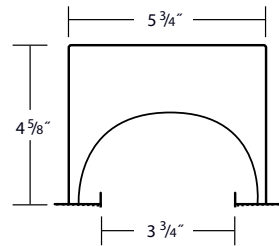
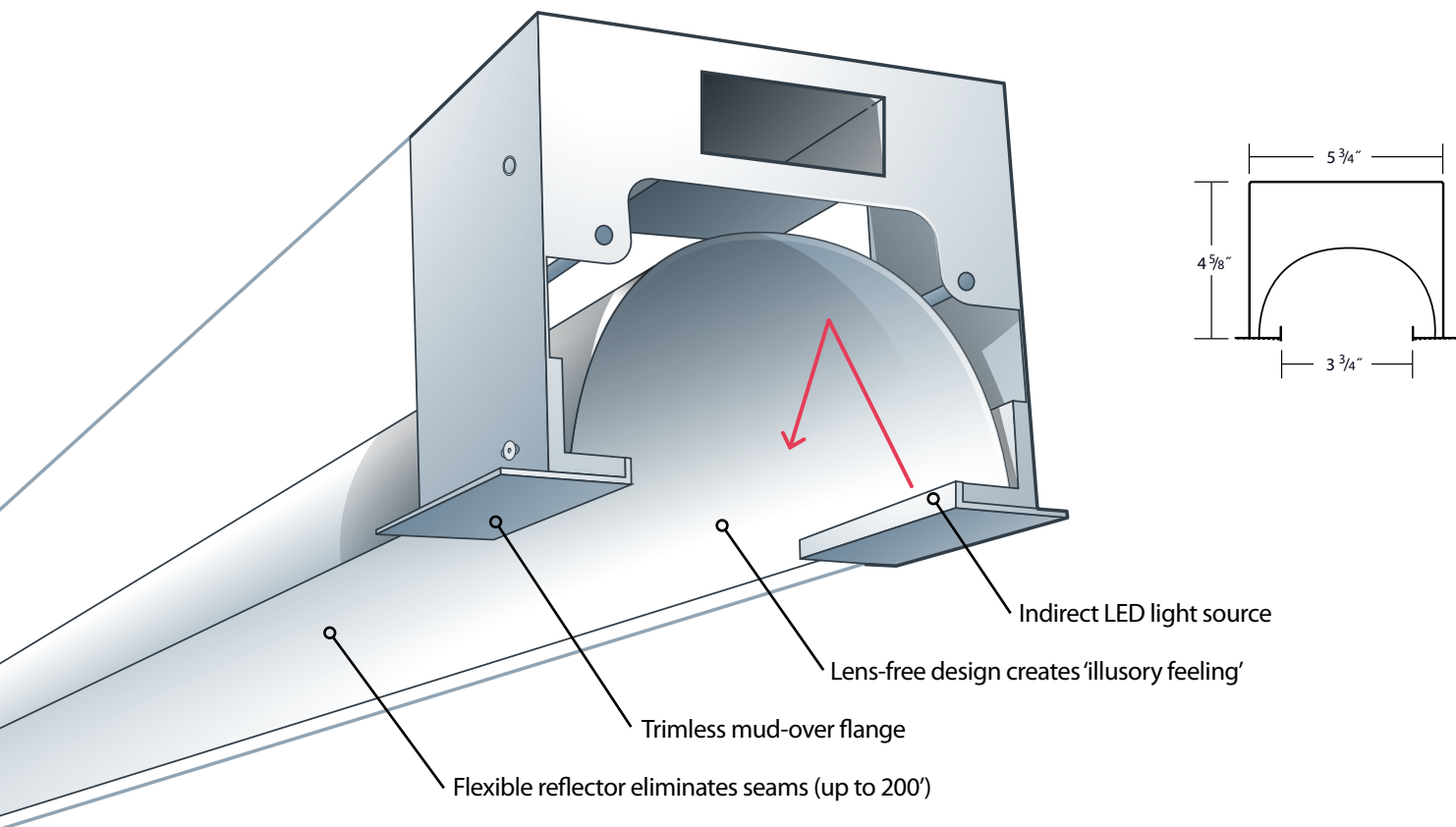

## Stream's wider spacing

Wide distribution (1.3 sc) means fewer luminaires per job, exceeding industry standards and saving energy.

Recessed Rows:

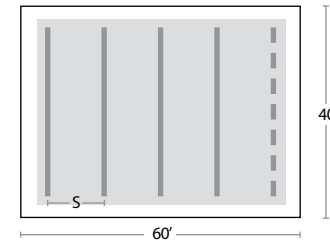

	watts/ft	spacing (S)	ceiling height	row length	# of 32' rows	average illuminance (30' working plane)	power density (w/sf)	Max	Min	Max/Min Ratio
Low Output - 540 lm/ft	6	12'	9'	32	5	30fc	.4	43fc	18fc	2.4
Standard Output - 765 lm/ft	8.5	14'	10'	32	4	36fc	.45	57fc	23fc	2.5

Calculation notes:

- 3500K
- .8 LLF (light loss factor) includes:
  - .86 LLD (lamp lumen depreciation)
  - .95 LDD (luminaire dirt depreciation)
  - .98 RSDD (room surface dirt dep)
- Grey area indicates calculation zone

STR-LED35SO-04  
3064 Delivered Lumens  
33.7 Watts  
1.3 Spacing Criteria  
83 CRI

Lumen output and wattages are nominal for all 3 color changes and may vary +/- 5%. 4000K is typically 2% more than and 3000K is 2% less than 3500K.

**90+**  
LM/W

	LOW	STANDARD	HIGH
lm/ft	540	765	1000
w/ft	6	8.5	11

### CONSTRUCTION

- Housing: Die-formed 20-gauge USA steel
- End Cap: Powder coated steel cap with magnetic attachment
- Reflector: 98% high diffuse reflector film (200' roll) UV Stable, UL 94v

### ELECTRICAL

- Driver: Must specify LED dimming controls. LED fixtures have constant current driver(s) with less than 20% THD when loaded to a minimum of 60%. Drivers sink a maximum of 6mA per driver. DM10 LED drivers are 0-10V dimmable and are compatible with most 0-10V wall slide dimmers and direct 0-10V analog signal dimmers.

### MOUNTING

- Recessed into ceilings or walls into exposed T-bar or hard ceilings

### LUMEN MAINTENANCE

Designed to last with cool running mid-power LEDs projected to maintain 90% of their initial output for 100,000 hours

PER TM21 CALCULATOR:

Calculated L90 100,000 hrs

PER IES TM21 STANDARDS:

Reported L70 >36,000 hrs

### Mounting Options:

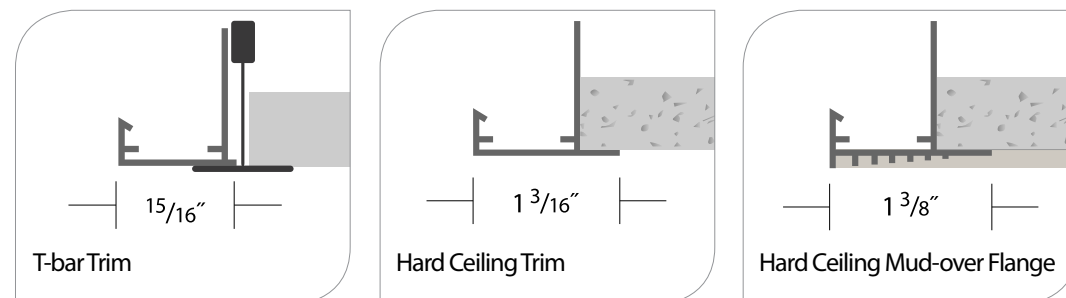

### Long runs of the flexible reflector installs in 3 easy steps:

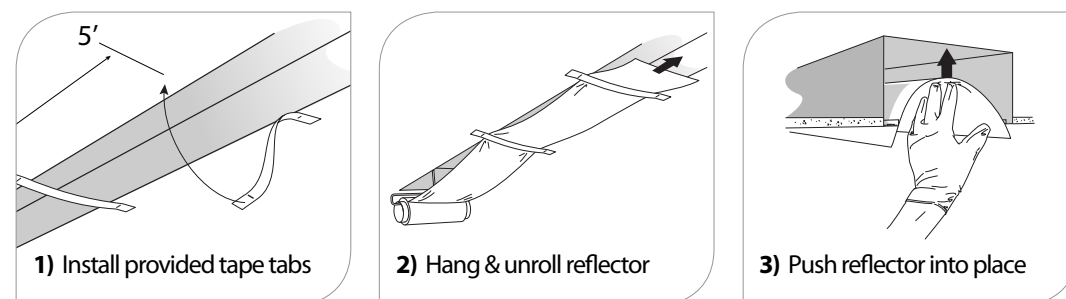

Visit [www.prulite.com](http://www.prulite.com) for a brief reflector installation video

SERIES	LED COLOR	OUTPUT	NOMINAL LENGTH	TRIM COLOR	DISTRI-BUTION	CIRCUIT-ING	VOLTAGE	CEILING SYSTEMS	CONTROLS	OPTIONS
STR Stream	LED3 3000K	LO Low Output 540 lm/ft	2' N/A T-bar	TMW Textured Matte White	D1 Direct	SC Single Circuit	UNV 120-277	X1' T-Bar X3 Hard Ceiling X7 Trimless Mud-Over Flange  *6" Armstrong TechZone compatible	ND Non-dimming standard DM10 0-10v 10% dimming DM01 0-10v 1% dimming STEP Step Dimming 100-50-Off DML 1% Lutron Dimming DMD 1% DALI Dimming	EML Emergency Battery (450-630 delivered lm) EMH Emergency Battery (900-1080 delivered lm) TUN Tunable light out- put (specify desired lm/ft or w/ft)
	LED35 3500K	SO Standard 765 lm/ft	3'	YGW Gloss White						
	LED4 4000K	HO High 1000 lm/ft	4' 6' 8' R____ 1' increments	Y____ Premium Color CC Custom Color						

\*STR-LED35SO-04 is DLC QPL listed. For other DLC listings, please consult the factory. Prudential Ltg. reserves the right to change design specifications or materials without notice.



Products  
Made in America **USA**



**PRUDENTIAL LTG.**

Light creates Life.  
Create with Prudential Ltg.

1737 East 22nd Street  
Los Angeles, CA 90058

352 7th Avenue, 7th Floor  
New York, NY 10001

**TEL** 213.746.0360  
**FAX** 213.741.8590

**TEL** 908.658.4231

**URL** [prulite.com](http://prulite.com)  
**EMAIL** [info@prulite.com](mailto:info@prulite.com)