



# P43 | Recessed Linear



PRUDENTIAL LTG.

PRULITE.COM 213.746.0360



Type:

Job:

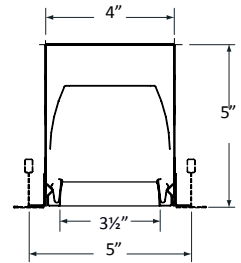

Open office illumination, wall washing or grazing, P43 has it all.

Industry best combination of optics, efficacy and aesthetics. See our Bionic Series for the same great optics with an aluminum housing.

### P40 Series includes:

- P40 - Direct Linear (Wash & Graze Optics)
- P46 - Direct/Indirect Linear (Wash & Graze Optics)
- P42 - 1" Regress Recessed Linear

P43-LED4-LO-SAL-D1  
1566 Delivered Lumens  
19 Watts  
82 lm/w  
84 CRI  
Light Labs Test  
#L041412304R01

# UP TO 82 LM/W

		LOW	MEDIUM	STANDARD	HIGH
SAL-D1	lm/ft	390	575	755	900
	w/ft	4.5	7	10	12
AWL-D1W	lm/ft	437	675	940	1070
	w/ft	4.5	7	10	12

Lumen output may vary +/- 5%  
4000K used for lm/ft estimates above  
3500K -2% llf, 3000K -4%, 2700K -6%  
See LED Details PDF for more info



SE-RIES	LED COLOR	OUTPUT	NOMINAL LENGTH	TRIM COLOR	SHIELDING	DISTRI-BUTION	CIRCU-ITING	VOLT-AGE	CEILING SYSTEMS	CONTROLS	OPTIONS
P43	LED27 2700K LED3 3000K LED35 3500K LED4 4000K	LO Low MO Medium SO Standard HO High PROG Programmable Light Output (Specify desired lm/ft or w/ft)	2' 3' 4' 6' 8' R (Row Length)	TMW Textured Matte White (Standard) YGW Gloss White Y Premium Color CC Custom Color	SAL* Satin Acrylic Lens AWL Acrylic Wall Wash Lens (D1W Only) AWW Acrylic Wall Graze Lens (D1G Only) OPL* Opal Frost Lens SPL-OL* Silver Parabolic Louver BLA-OL* Bladed Louver Anodized BLW-OL* Blade Louver, White *D1 Only, Louvers have a thin acrylic overly masking LEDs	D1 Direct (SAL or OPL) D1W Wall Wash (AWL lens Only) D1G Wall Grazer (AWW Only) D1R Asymmetric to Room (AWL lens Only)	SC Single Circuit	UNV (120-277)	X1 T-Bar 1/5/16 & 9/16 X2 Dimensional T-bar Armstrong Interlude® X6 Slot Grid X3B Hard Ceiling Flange Trim (Overhead mounting brackets) X7 Hard Ceiling Trimless Mud-over (Concealed flange)	ND Non-Dimming DM10 0-10v 10% Dimming (Standard) DM01 0-10v 1% Dimming STEP Step Dimming 100-50-Off DML 1% Lutron Dimming DMD 0.1% DALI Dimming DMG 1% DALI Dimming	EML Emergency Battery, Low (D1, D1W ~ 850 delivered lumens, D1G ~ 600) EMH Emergency Battery, High (D1, D1W ~1175 delivered lumens, D1G ~ 900) C2 90° 2-Way Lit Corner CX Special Connector (Consult factory) QC Quick Connect PRUBIN Meticulous Binning and Labeling every LED Board within a 2-Step MacAdams Elipse



Prudential Ltg. reserves the right to change design specifications or materials without notice. Please visit [www.prulite.com](http://www.prulite.com) for most current data.  
© 2014 All rights reserved - All products manufactured at: Prudential Ltg. 1774 E. 21st Street, Los Angeles, CA 90058

Recessed Linear

1

02-01-2016



### SAL-D1 GLOW

**Low Output:**

P43-LED4-LO-SAL-D1  
1566 Delivered Lumens  
19 Watts  
82 lm/w  
84 CRI  
4000 CCT  
Light Labs Test  
#L041412304R01

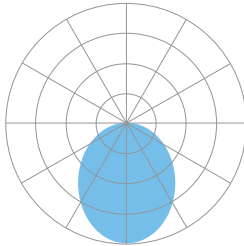

769

**Zonal Lumen Summary:**  
0-90 = 100%

Vertical Angle	0	25	45	65	90
0	769	769	769	769	769
5	762	763	763	760	760
15	720	717	709	698	693
25	642	632	612	592	582
35	538	522	494	469	457
45	421	403	373	349	337
55	303	303	263	243	234
65	199	188	171	157	151
75	100	93	84	78	75
85	24	23	21	21	20
90	0	0	0	0	0

### WALL WASH

**Low Output:**

P43-LED3SO-AWL-D1R  
3064 Delivered Lumens  
39 Watts  
82 lm/w  
82 CRI  
3000 CCT  
Light Labs Test #32273

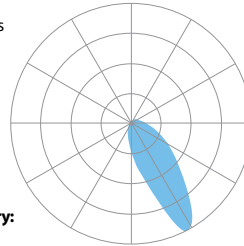

785

**Zonal Lumen Summary:**  
0-90 = 100%

Vertical Angle	0	22.5	45	67.5	90
0	785	785	785	785	785
5	979	969	920	850	786
15	1638	1548	1307	1000	763
25	2136	2065	1742	1147	715
35	1909	1946	1894	1253	644
45	1358	1400	1541	1238	548
55	863	890	991	1000	425
65	463	491	552	597	276
75	186	199	236	258	134
85	39	40	45	50	26
90	0	0	0	0	0

### WALL GRAZER

**Low Output:**

P43-LED4HO-AWW-D1G  
2899 Delivered Lumens  
47.4 Watts  
61 lm/w  
84 CRI  
4000 CCT  
Light Labs Test #31700

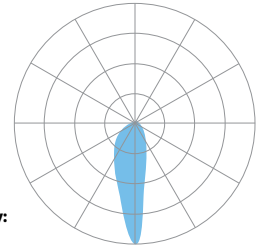

2619

**Zonal Lumen Summary:**  
0-90 = 100%

Vertical Angle	0	22.25	45	67.5	90
0	2619	2619	2619	2619	2619
5	2290	2337	2462	2578	2603
15	1486	1526	1675	2096	2463
25	1101	1134	1233	1588	2149
35	787	814	898	1145	1692
45	559	580	623	792	1141
55	381	394	432	521	673
65	255	260	272	311	346
75	157	153	151	147	146
85	54	50	47	41	32
90	0	0	0	0	0

### LUMEN MAINTENANCE

Designed to last with cool running mid-power LEDs projected to maintain 90% (L90) of their initial output for 100,000 hours (at HO), and L70 exceeding 150,000 hours.

### LED SYSTEM

LED modules and drivers are field replaceable.

### PROG (optional)

Programmable light output. Specify desired lumens or watts per linear foot. Min: 2.5 w/ft, consult factory for requests above 12 w/ft.

### BINNING

Standard binning (all Prudential LED boards) includes testing at the chip level and board integration to provide consistent color temperature within a 3-step MacAdam ellipse, with +/- 5% lumen output range and +/- .004 Duv.

### PRUBIN™ (OPTIONAL)

Prudential Ltg's exclusive 'job binning' method that ensures color temperature consistency across all luminaires on a project. Meticulously testing and labeling EVERY LED BOARD to +/- 25 lumens, +/- 50k CCT and +/- .004 Duv — while also separating positive from negative — allows us to match color, hue and intensity throughout a project and provides a consistent color temperature within a 2-step MacAdam ellipse.

### LABELS

ETL damp labeled and I.B.E.W. manufactured

### ELECTRICAL

Must specify LED dimming controls. LED fixtures have constant current driver(s) with less than 20% THD when loaded to a minimum of 60%. Drivers sink a maximum of 6mA per driver. DM10 LED drivers are 0-10V dimmable and are compatible with most 0-10V wall slide dimmers and direct 0-10V analog signal dimmers. Max driver size 1.625" w x 1.25" h.

### CONSTRUCTION

- Housing: 20-gauge USA steel, >20% PC recycled, 100% recyclable
- Lens: Acrylic, 100% recyclable
- Louvers: Aluminum, >25% PC recycled, 100% recyclable

### MOUNTING

Recessed into drywall or T-bar ceilings

### WARRANTY

Single-source, 5 year limited warranty covers standard components and construction





P43 Wall Wash visual continuity with P43 open office SAL lens

### MOUNTING OPTIONS

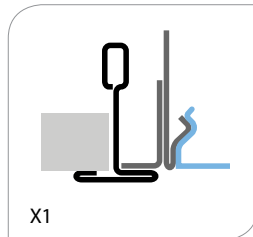

X1

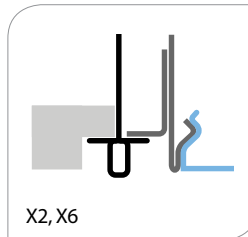

X2, X6

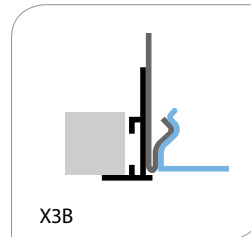

X3B

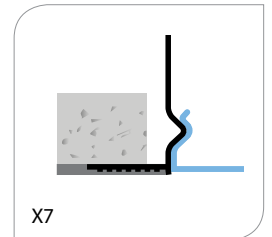

X7

### ADJOINING DETAILS

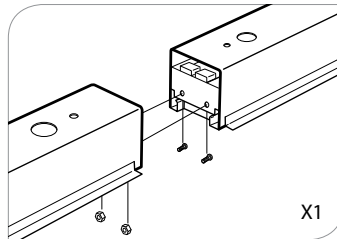

X1

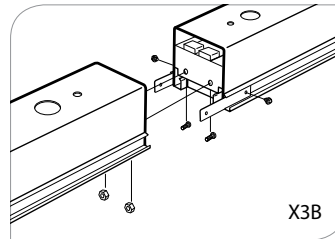

X3B

**Framing Dimensions X3B & X7**  
Add 1/2" in fixture width, Add 5/8" in fixture length or overall row length.

### MOUNTING LOCATIONS

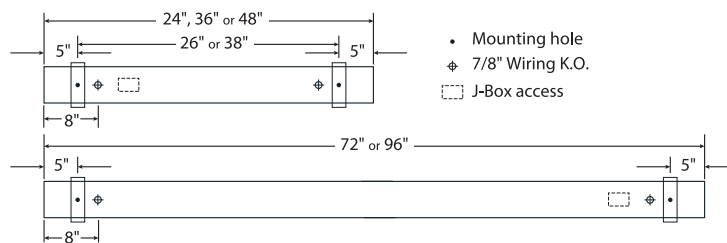

### WALL WASH/GRAZE REFLECTOR & LENS ORIENTATION

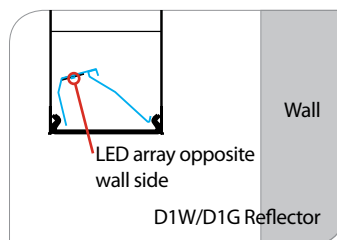

LED array opposite wall side

D1W/D1G Reflector

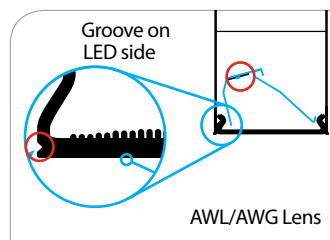

Groove on LED side

AWL/AWG Lens

