

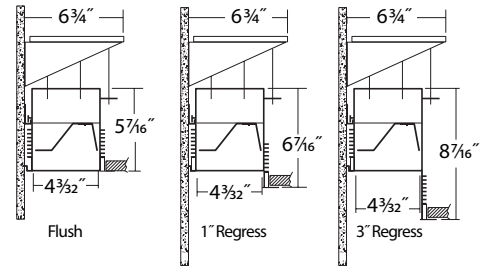

Type:

Job:



High performance 4" perimeter wall grazer.

Housing: Extruded aluminum accommodates a wide range of ceiling systems and complex installations. Armstrong™ TechZone compatible.

3 Optics: Soft Glow (D1), precise Wall Graze (D1G) or Fill a corridor in light (D1R) from the Perimeter (flush recommended).

Series: See also our Bionic recessed linear and Wall Wash for visual continuity. Our P43 Perimeter System is nearly identical with the same great optics and a budget-friendly steel housing.

BIO-PSTD-FLSH-LED4-LO-AWW-D1G
 1408 Delivered Lumens
 17.3 Watts
 81 lm/w
 84 CRI
 4000 CCT



UP TO **81** LM/W

		LOW	MEDIUM	STANDARD	HIGH
SAL-D1	lm/ft	390	600	840	1000
	w/ft	4.5	7	10	12
AWW-D1G	lm/ft	350	550	775	900
	w/ft	4.5	7	10	12
AWL-D1R	lm/ft	390	600	875	1000
	w/ft	4.5	7	10	12

Lumen output may vary +/- 5%
 4000K used for lm/ft estimates above
 3500K -2% lf, 3000K -4%, 2700K -6%
 See LED Details PDF for more info

*BIO-REG3-LED4HO-AWW-D1G is DLC QPL listed. For other DLC listings, please consult factory.

SERIES	LENS POSITION	LED COLOR	OUT-PUT	NOMINAL LENGTH	TRIM COLOR	SHIELD-ING	DISTRI-BUTION	MOUNT-ING	CIRCUIT-ING	VOLT-AGE	CEILING SYSTEMS	CONTROLS	OPTIONS
BIO-PSTD													
Bionic Perimeter Standard	FLSH Flush Lens REG1 1" Regress Lens REG3 3" Regress Lens	LED27 2700K LED3 3000K LED35 3500K LED4 4000K	LO Low MO Medium SO Standard HO High PROG Programmable Light Output (Specify desired lm/ft or w/ft)	2' 3' 4' 6' 8' R (Row length)	TMW Textured Matte White (Standard) YGW Gloss White Y Premium Color CC Custom Color	SAL Satin Acrylic Lens (D1 Only) AWW Acrylic Wall Grazer Lens (D1G Only) AWL Perimeter Fill Lens (D1R Only)	D1 Direct SAL Only D1G Wall Grazer AWW Only D1R Perimeter Fill (AWL Only, NA REG3)	WTW Wall to Wall LP Light Pocket	SC Single Circuit	UNV (120-277)	X1 T-Bar X1M 9/16 T-Bar X2 Interlude T-bar X6 Slot Grid X3 Hard Ceiling X7BF Hard ceiling (Trimless mud-over with backer flange)	ND Non-Dimming DM10 0-10v 10% Dimming Standard DM01 0-10v 1% Dimming STEP Step Dimming 100-50-Off DML 1% Lutron Dimming DMD 0.1% DALI Dimming DMG 1% DALI Dimming	EML Emergency Battery, Low (D1, D1W ~ 850 delivered lumens, D1G ~ 600) EMH Emergency Battery, High (D1, D1W ~ 1175 delivered lumens, D1G ~ 900) M1 12" MR16 Module (adj.) 1/50w (max) lamp M2 12" MR16 Module (adj.) 2/50w (max) lamp C2 90° 2-Way Lit Corner w/Acrylic Lens PRUBIN Meticulous Binning and Labeling every LED Board within a 2-Step MacAdams Elipse Note: All MR16 lamps by others

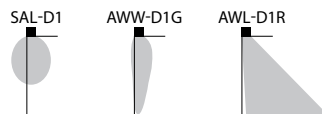



SAL-D1 GLOW

Low Output:

BIO-PSTD-FLSH-LED4-LO-SAL-D1

1682 Delivered Lumens

18.1 Watts

88 lm/w

85 CRI

4000 CCT

Light Labs Test

#L041412304R01

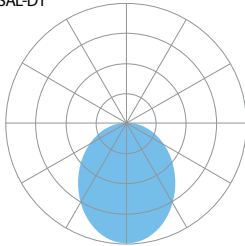

769

Zonal Lumen Summary:
0-90 = 100%

Vertical Angle	0	25	45	65	90
0	769	769	769	769	769
5	762	763	763	760	760
15	720	717	709	698	693
25	642	632	612	592	582
35	538	522	494	469	457
45	421	403	373	349	337
55	303	303	263	243	234
65	199	188	171	157	151
75	100	93	84	78	75
85	24	23	21	21	20
90	0	0	0	0	0

WALL GRAZER

Low Output:

BIO-PSTD-FLSH-LED4-LO-AWW-D1G

1408 Delivered Lumens

17.3 Watts

81 lm/w

85 CRI

4000 CCT

Light Labs Test #

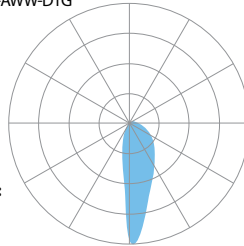

2619

Zonal Lumen Summary:
0-90 = 100%

Vertical Angle	0	22.25	45	67.5	90
0	2619	2619	2619	2619	2619
5	2290	2337	2462	2578	2603
15	1486	1526	1675	2096	2463
25	1101	1134	1233	1588	2149
35	787	814	898	1145	1692
45	559	580	623	792	1141
55	381	394	432	521	673
65	255	260	272	311	346
75	157	153	151	147	146
85	54	50	47	41	32
90	0	0	0	0	0

PERIMETER FILL

Low Output:

BIO-PSTD-FLSH-LED4-LO-AWL-D1R

1560 Delivered Lumens

17.3 Watts

90 lm/w

85 CRI

4000 CCT

Light Labs Test #

L021507501R01

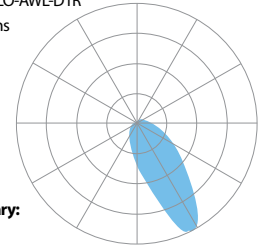

923

Zonal Lumen Summary:
0-90 = 100%

Vertical Angle	0	22.5	45	67.5	90
0	785	785	785	785	785
5	979	969	920	850	786
15	1638	1548	1307	1000	763
25	2136	2065	1742	1147	715
35	1909	1946	1894	1253	644
45	1358	1400	1541	1238	548
55	863	890	991	1000	425
65	463	491	552	597	276
75	186	199	236	258	134
85	39	40	45	50	26
90	0	0	0	0	0

UPTO **88** LM/W

	LOW	MEDIUM	STANDARD	HIGH
lm/ft	390	600	875	1000
w/ft	4.5	7	10	12

UPTO **81** LM/W

	LOW	MEDIUM	STANDARD	HIGH
lm/ft	350	550	775	900
w/ft	4.5	7	10	12

UPTO **88** LM/W

	LOW	MEDIUM	STANDARD	HIGH
lm/ft	390	600	875	1000
w/ft	4.5	7	10	12

LUMEN MAINTENANCE

Designed to last with cool running mid-power LEDs projected to maintain 90% (L90) of their initial output for 100,000 hours (at HO), and L70 exceeding 150,000 hours.

LED SYSTEM

LED modules and drivers are field replaceable.

PROG (optional)

Programmable light output. Specify desired lumens or watts per linear foot. Min: 2.5 w/ft, consult factory for requests above 12 w/ft.

BINNING

Standard binning (all Prudential LED boards) includes testing at the chip level and board integration to provide consistent color temperature within a 3-step MacAdam ellipse, with +/- 5% lumen output range and +/- .004 Duv.

PRUBIN™ (OPTIONAL)

Prudential Ltg's exclusive 'job binning' method that ensures color temperature consistency across all luminaires on a project. Meticulously testing and labeling EVERY LED BOARD to +/- 25 lumens, +/- 50k CCT and +/- .004 Duv — while also separating positive from negative — allows us to match color, hue and intensity throughout a project and provides a consistent color temperature within a 2-step MacAdam ellipse.

LABELS

ETL damp labeled and I.B.E.W. manufactured

ELECTRICAL

Must specify LED dimming controls. LED fixtures have constant current driver(s) with less than 20% THD when loaded to a minimum of 60%. Drivers sink a maximum of 6mA per driver. DM10 LED drivers are 0-10V dimmable and are compatible with most 0-10V wall slide dimmers and direct 0-10V analog signal dimmers. Max driver size 1.25" w x 1" h.

CONSTRUCTION

Housing

Extruded aluminum >25% PC recycled, 100% recyclable

Lens

Acrylic, 100% recyclable

MOUNTING

Recessed into drywall or T-bar ceilings

WARRANTY

Single-source, 5 year limited warranty covers standard components and construction





MOUNTING LOCATIONS

Mounting Detail (1) Housing Detail for 1/4" - 20

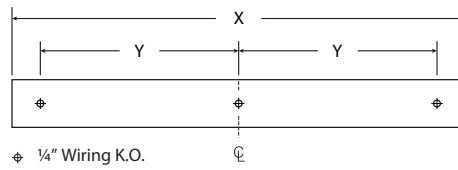

Mounting Conversion Chart

X =	2'	3'	4'	5'	6'	7'	8'
Y =	9"	15"	21"	27"	33"	39"	45"

* From centerline

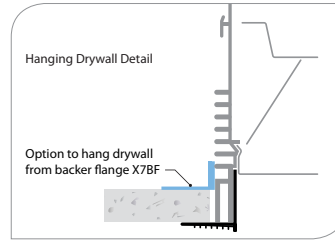
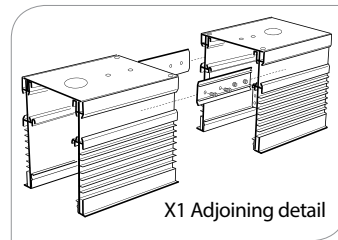

WALL WASH REFLECTOR ORIENTATION

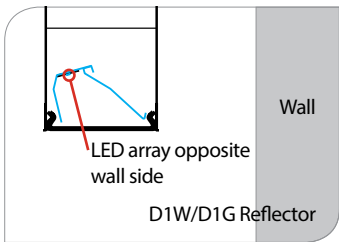

CONNECTORS

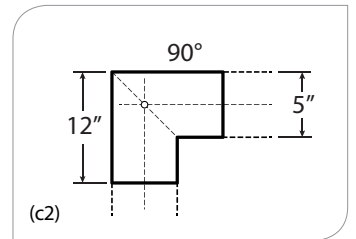
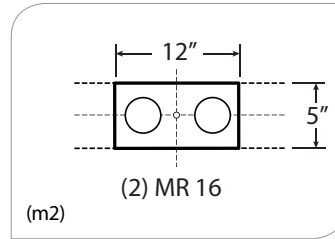
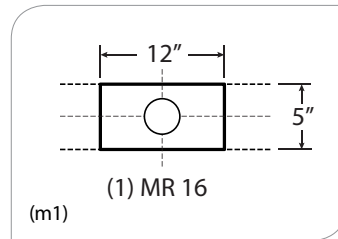

WALL WASH LENS ORIENTATION

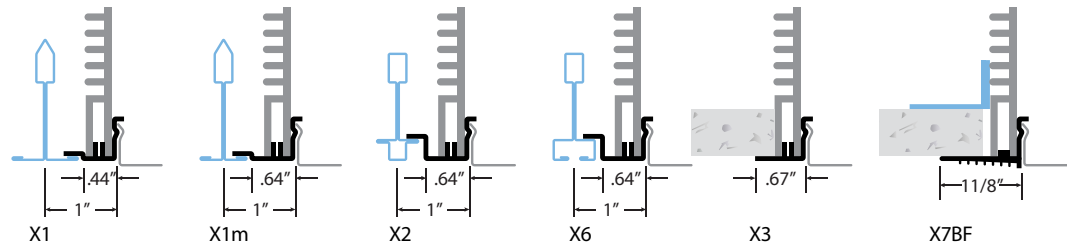
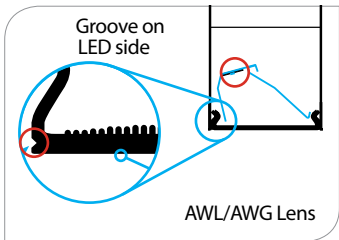

Smooth Wall Grazing

A tight, focused beam grazes wall textures evenly, accenting and highlighting details to elevate the visual drama.

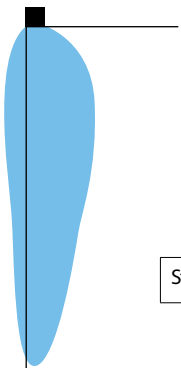

Standard Output - 625 lm/ft	10	9'	40fc	76fc	16fc	4.75
	watts/ft	ceiling height	average illuminance	Max	Min	Max/Min Ratio

Footcandles on Wall

9'	26	28	29	28	26
8'	55	60	62	60	55
7'	67	73	76	73	67
6'	62	68	72	68	62
5'	51	56	59	56	51
4'	39	43	44	43	39
3'	29	31	32	32	29
2'	22	23	24	23	22
1'	16	17	17	17	16