

Recessed **P9200**

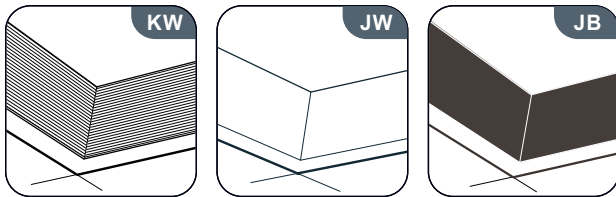
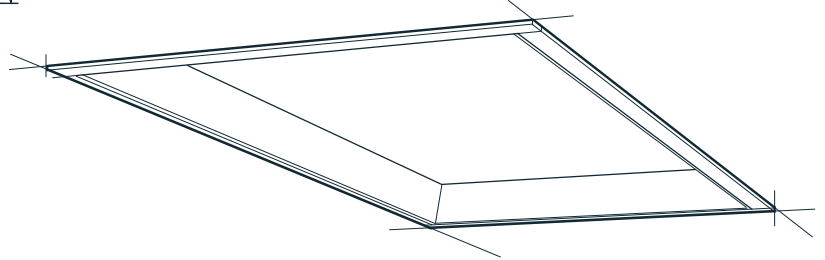
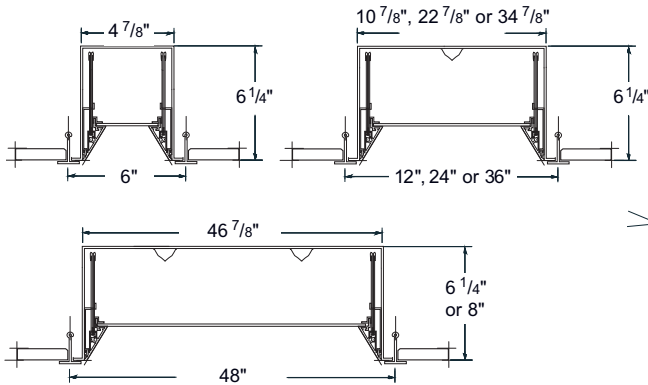

**ordering**

series	lamp rows	shielding	frame style/color	voltage	ceiling system	options
P9204 6" x 4'	1T8	PRA* prismatic acrylic lens	KW striated frame white <u>or</u>	120	X1* T-bar (exposed)	EML*
P9214 1' x 4'	2T8 3T8 2BX_w*	P19A prismatic acrylic lens, pattern 19	KB black	277	X3B hard ceiling (overhead mounting brackets)	EMH*
P9222 2' x 2'	2T8 3T8 4T8 2BX_w*	WA white acrylic diffuser	JW* smooth frame white <u>or</u>	347	X4B hard ceiling ("C" channel)	DM RSE
P9224 2' x 4'	2T8 3T8 4T8 6T8 4BX_w*	*standard	JB black	UNV* *120-277	X5B T-bar (concealed)	10THD B_
P9233 3' x 3'	4T8 6T8				X8B Armstrong Interlude® XL grid system compatible	MR FH
P9244S 4' x 4' x 6 1/4" housing	4T8		*standard Note: Fixture body flange finished in white enamel on mounting styles x3B & x4B.			*consult factory for fixture lengths < 4'
P9244D* 4' x 4' x 8" housing	6T8 8T8					
*standard	*biax, specify 40w, 50w or 55w				*standard	

**Finish** The standard housing color is gloss white (YGW) painted after fabrication. Standard door frame color is gloss white (YGW) or matte black (YBB) as specified in the ordering matrix.

**Electrical** T8 fixtures have instant start electronic ballasts with less than 20% THD. Fixtures are U.L. Damp labeled and I.B.E.W. manufactured. Maximum ballast size available: 2.38" width x 1.50" height.

**Mounting** Fixture is to be recessed-mounted into a wide variety of ceiling conditions including hard ceiling, exposed and concealed T-bar systems, and Armstrong Interlude® XL suspension grid system.

**Options** **EML**: emergency battery (600-700 lumens); **EMH**: emergency battery (1100-1400 lumens); **DM**: dimming (please specify requirements); **RSE**: rapid-start electronic; **10THD**: ballast with <10% total harmonic distortion; **B\_**: specific ballast, specify manufacturer and catalog number; **MR**: master remote with 11' whip; **FH**: fixture fusing (slow blow).

**Applications** Open or small offices, corridors, retail, healthcare, schools.

**Features** A 2"-deep regressed skylight troffer, with a 6 1/4" -deep housing (8" -deep housing is standard on 4' x 4' size). It features either prismatic or white acrylic lenses. P9200 is available with a variety of housing sizes, including 2-, 3- and 4-foot squares, with either smooth or striated, white or black doorframes.

**Construction** The housing is constructed of 20-gauge die-formed steel. The regressed door frame is made of extruded aluminum, held with torsion springs.

Prudential reserves the right to change design specifications or materials without notice.

# P9200 Recessed

## photometric data

### P-9214-2T8-PRA-KW

Report # LSI15381 D=100.0% I=0.0%  
Spacing Criteria: Along 1.2; Across 1.1  
Lamp Lumens: 2950 Input Watts: 60

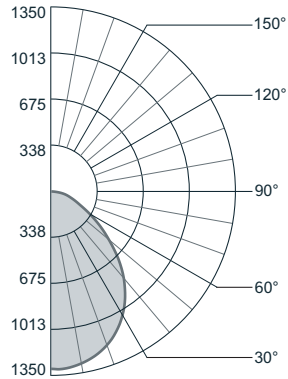

### Candlepower Summary

Vertical Angle	Horizontal Angle					Output Lumens
	0°	22.5°	45°	67.5°	90°	
0	1298	1298	1298	1298	1298	124
5	1298	1294	1287	1280	1280	
10	1277	1270	1256	1242	1239	338
15	1243	1229	1203	1180	1175	
20	1194	1171	1132	1101	1095	
25	1127	1096	1047	1015	1010	485
30	1042	1007	958	934	932	
35	940	906	863	843	843	544
40	823	784	756	730	737	
45	690	653	630	607	605	486
50	549	524	511	463	449	
55	428	409	374	335	319	336
60	318	302	253	239	228	
65	229	210	168	170	164	188
70	171	145	114	117	115	
75	127	103	77	68	62	90
80	84	59	35	25	24	
85	30	14	11	11	10	19
90	0	0	0	0	0	

### Zonal Lumen Summary

Zone	% Lamp	% Luminaire
0-90	44.24	100.00
90-180	0.00	0.00

Efficiency = 44.2%

### Luminance Summary (cd/m<sup>2</sup>)

Angle	0°	45°	90°
45	3298	3026	2903
55	2525	2213	1891
65	1832	1345	1317
75	1655	1007	810
85	1180	439	402

### Coefficients of Utilization (%)

Floor Ceiling Wall	effective floor cavity reflectance = .20										
	80		70		50		30		10		
RCR 0	53	53	53	53	51	51	51	51	49	49	49
1	49	48	46	45	48	47	45	44	45	44	43
2	46	43	40	38	45	42	40	38	40	39	37
3	42	38	36	33	41	38	35	33	37	34	32
4	39	35	31	29	38	34	31	29	33	31	28
5	36	31	28	25	35	31	27	25	30	27	25
6	34	28	25	22	33	28	25	22	27	24	22
7	31	26	22	20	31	25	22	20	25	22	20
8	29	23	20	17	28	23	20	17	22	19	17
9	27	21	18	15	26	21	18	15	20	17	15
10	25	19	16	14	24	19	16	14	19	16	14

## photometric data

### P-9224-3T8-PRA-KW

Report # LSI15384 D=100.0% I=0.0%  
Spacing Criteria: Along 1.3; Across 1.4  
Lamp Lumens: 2950 Input Watts: 88

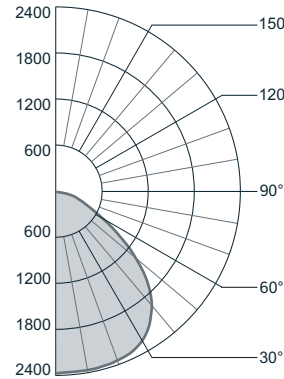

### Candlepower Summary

Vertical Angle	Horizontal Angle					Output Lumens
	0°	22.5°	45°	67.5°	90°	
0	2384	2384	2384	2384	2384	230
5	2382	2377	2378	2378	2376	
10	2355	2355	2361	2375	2378	660
15	2304	2314	2334	2364	2371	
20	2236	2252	2293	2342	2356	
25	2143	2172	2241	2307	2329	1030
30	2026	2072	2165	2239	2259	
35	1874	1937	2050	2112	2133	1260
40	1678	1751	1880	1930	1954	
45	1437	1504	1630	1678	1702	1218
50	1140	1212	1318	1357	1372	
55	887	964	1039	1057	1022	898
60	684	733	760	755	714	
65	512	515	493	512	493	512
70	372	359	303	351	355	
75	266	247	212	238	259	255
80	182	155	142	136	143	
85	67	55	44	33	29	61
90	0	0	0	0	0	

### Zonal Lumen Summary

Zone	% Lamp	% Luminaire
0-90	69.20	100.00
90-180	0.00	0.00

Efficiency = 69.2%

### Luminance Summary (cd/m<sup>2</sup>)

Angle	0°	45°	90°
45	2915	3319	3466
55	2219	2607	2566
65	1738	1680	1679
75	1476	1176	1442
85	1103	725	473

### Coefficients of Utilization (%)

Floor Ceiling Wall	effective floor cavity reflectance = .20										
	80		70		50		30		10		
RCR 0	82	82	82	82	80	80	80	80	77	77	77
1	77	74	71	69	75	72	70	68	69	68	66
2	71	66	62	59	69	65	61	58	62	59	57
3	65	59	54	50	64	58	53	50	56	52	49
4	60	53	48	43	59	52	47	43	50	46	43
5	55	47	42	37	54	47	41	37	45	40	37
6	51	43	37	33	50	42	36	33	41	36	32
7	47	38	33	29	46	38	32	29	37	32	28
8	43	34	29	25	42	34	29	25	33	28	25
9	40	31	25	22	39	31	25	22	30	25	21
10	37	28	23	19	36	28	23	19	27	22	19

## installation

### Ceiling Systems

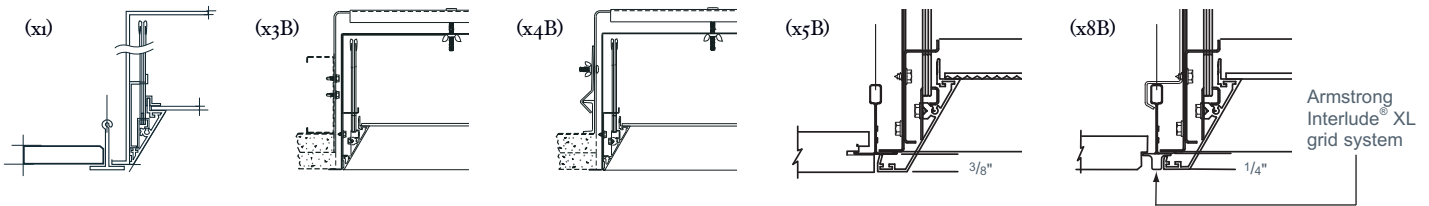

### Mounting Locations

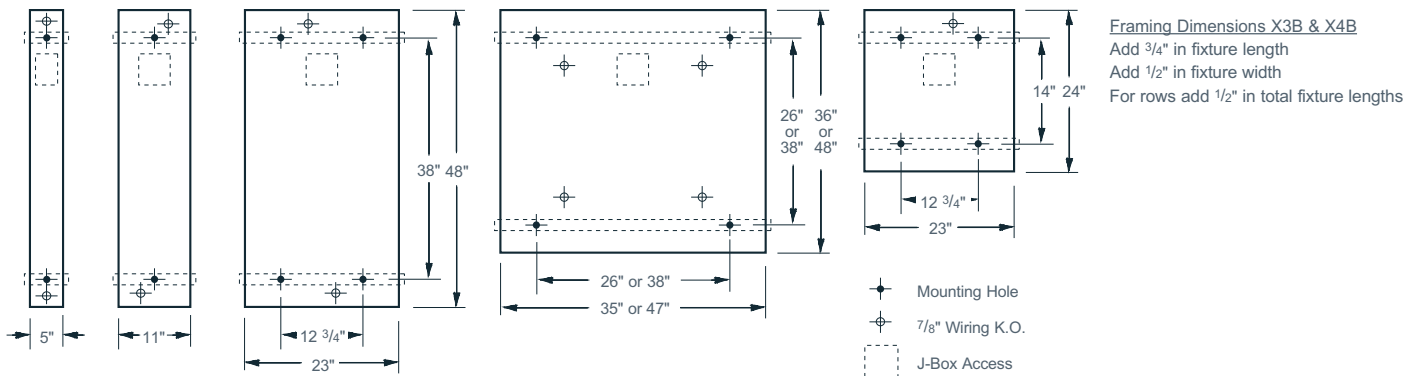

Prudential reserves the right to change design specifications or materials without notice.